

**STANFIELD HUTTERIAN CONSERVATION APPLICATION  
MAP PROPOSING THE NEW PLACE OF USE OF THE  
CONSERVED WATER**  
5/21/09

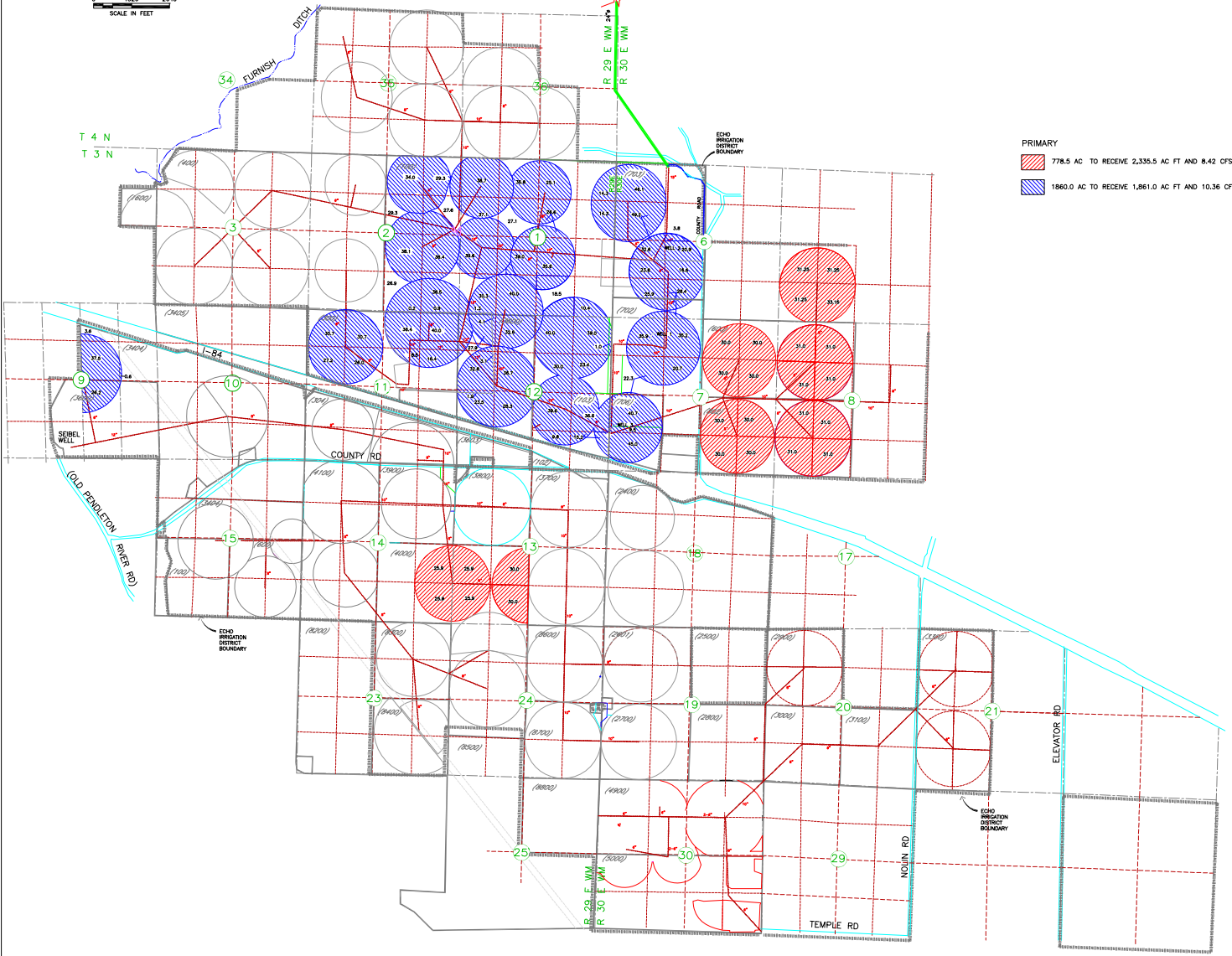

0 1320 2640  
SCALE IN FEET

COLUMBIA RIVER  
STANFIELD HUTTERIAN FARM RIVER STATION  
COLUMBIA RIVER DIVERSION POINT LOCATED 2910ft NORTH AND 120ft EAST FROM THE SW CORNER SECTION 8, T.5N., R.30E. WM



- PRIMARY**
- 778.5 AC TO RECEIVE 2,335.5 AC FT AND 8.42 CFS
  - 1860.0 AC TO RECEIVE 1,861.0 AC FT AND 10.36 CFS