

2009 WESTLAND IRRIGATION DISTRICT

Temporary Transfer Madison to Madison

March 14, 1903, Cert. 76715 Primary &
July 1, 1924 Cert. 79439 Supplemental.

T4N., R28E., W.M.

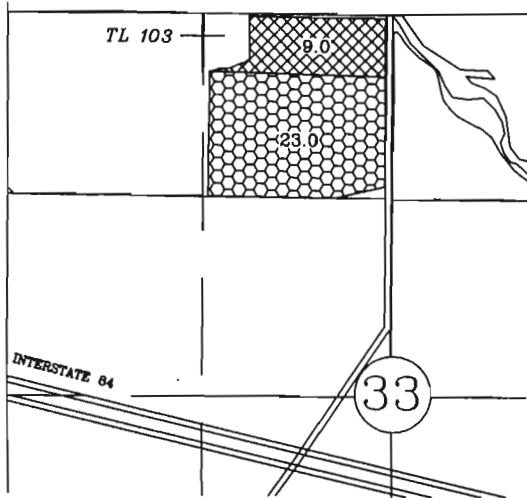

T3N., R27E., W.M.

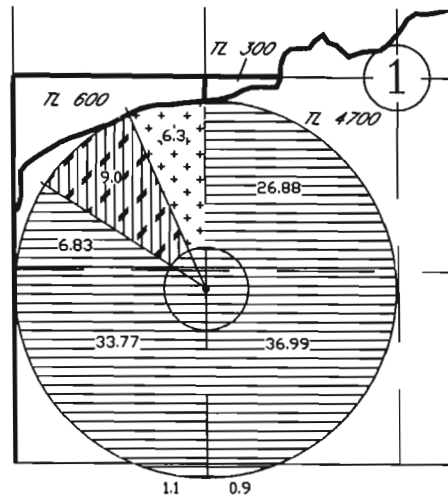

FROM: 76715 & 79439 - 9.0 acres



TO: 76715 & 79439 - 9.0 acres
Existing permit 51017 & application
S86866 diminished to supplemental
to incoming primary cert. 76715 for
the 2009 irrigation season.

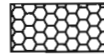

76715 & 79439 not involved in transfer

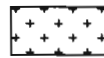

76717 & 79439 not involved in transfer
(placed here in 2008 permanent district
transfer T-10762)



Primary permit 51017 & Supplemental
application S86866 not involved
with this transfer

T3N., R 29E., W.M.

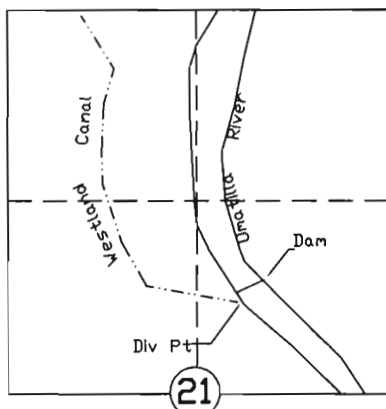

T 10901

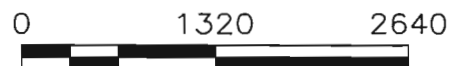

SCALE IN FEET

RECEIVED

JUN 11 2009

WATER RESOURCES DEPT
SALEM, OREGON

NOTE: THE PURPOSE OF THIS MAP IS TO IDENTIFY THE APPROXIMATE LOCATION OF THE WATER RIGHT. IT IS NOT INTENDED TO PROVIDE INFORMATION RELATIVE TO THE LOCATION OF PROPERTY OWNERSHIP BOUNDARY LINES.

Westland Irrigation District Boundary

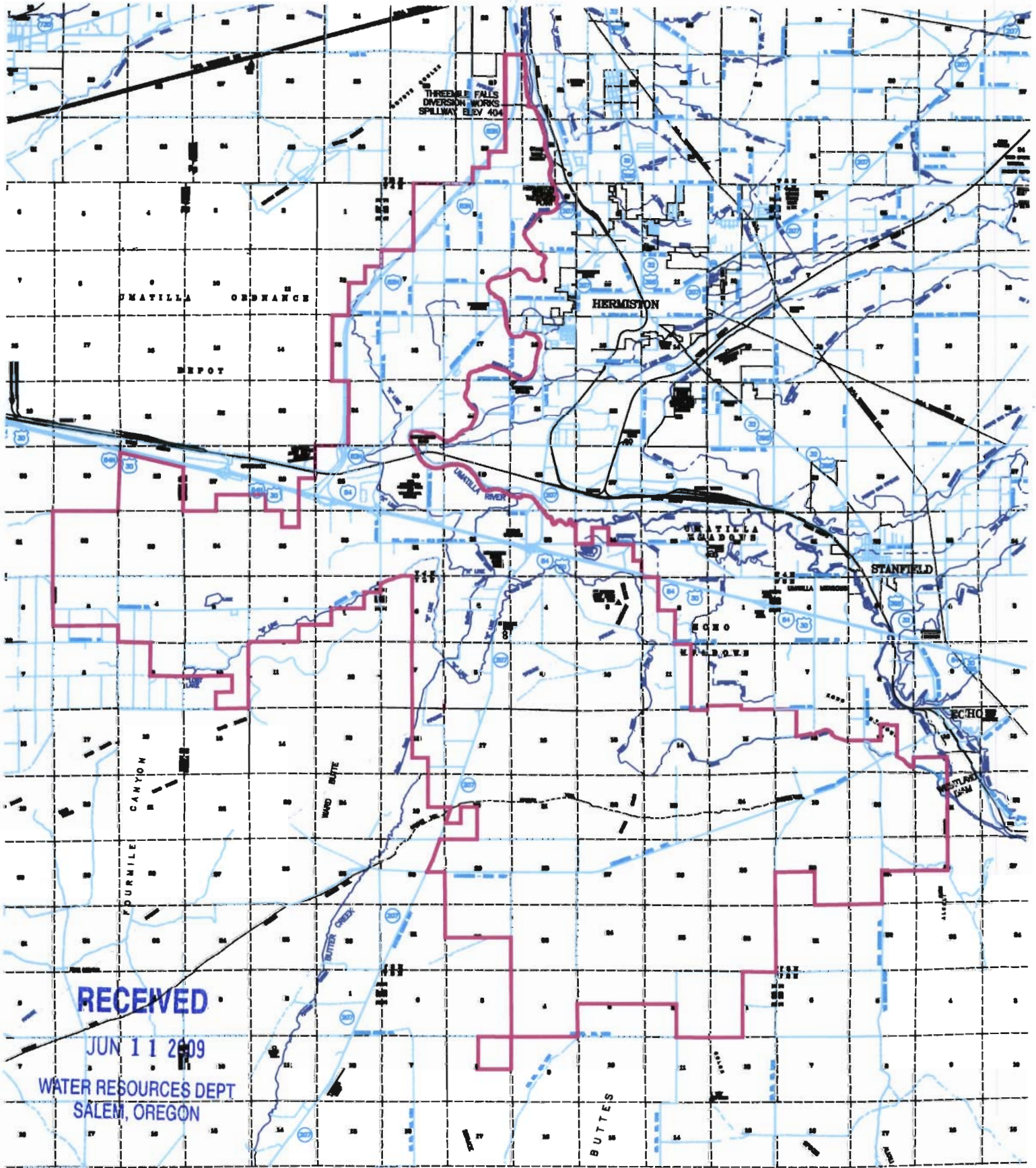

LEGION: ——— DISTRICT BOUNDARY



WESTLAND IRRIGATION DISTRICT
SERVICE BOUNDARY

T 10901