

**DISTRICT TEMPORARY TRANSFER MAP
FOR BEAVER DRAINAGE DISTRICT**
APPLICATION # _____



LOCATED IN Township 8 North, Range 4 West, W.M.

10389

RECEIVED

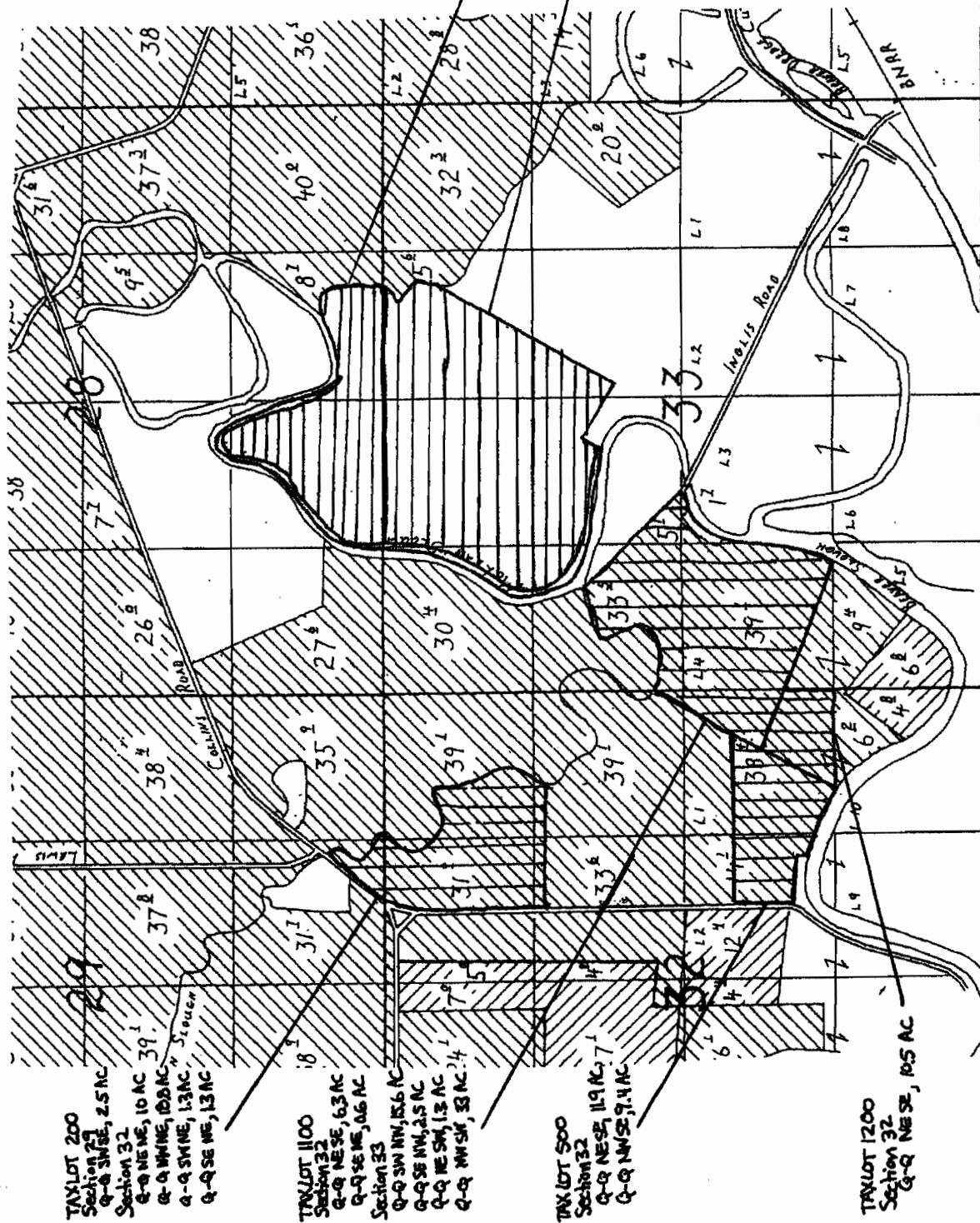
JUN 02 2009

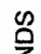

FROM LANDS
 FROM LANDS
TO LANDS
 TO LANDS

Point of Appropriation
Under Cert. No. 83174
 SE 1/4 of the SW 1/4 of
 Sec. 23, T8N R4W
 Willamette M. - 820
 FEET NORTH AND
 2790 FEET EAST FROM
 SW CORNER, SECTION
 23

TAX LOT 1000
 Section 20
 Q-Q NE SW, 0.6 AC
 Q-Q SE SW, 25 AC
 Q-Q SW SE, 10.6 AC

TAX LOT 901
 Section 33
 Q-Q NW NW, 4.4 AC
 Q-Q SW NW, 1.9 AC
 Q-Q NE NW, 57.4 AC
 Q-Q SE NW, 15.6 AC
 Q-Q NW NE, 23.1 AC
 Q-Q SW NE, 4.4 AC

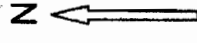

1" = 1320'

TAX LOT 200
 Section 29
 Q-Q SW SE, 2.5 AC
 Section 32
 Q-Q NE NE, 10 AC
 Q-Q NW NE, 10.3 AC
 Q-Q SW NE, 1.3 AC
 Q-Q SE NE, 1.3 AC

TAX LOT 1100
 Section 32
 Q-Q NE SE, 6.3 AC
 Q-Q SE SE, 0.6 AC
 Section 33
 Q-Q SW NW, 15.6 AC
 Q-Q SE NW, 2.5 AC
 Q-Q NE SW, 1.3 AC
 Q-Q NW SW, 3.4 AC

TAX LOT 500
 Section 32
 Q-Q NE SE, 11.9 AC
 Q-Q NW SE, 9.4 AC

TAX LOT 1200
 Section 32
 Q-Q NE SE, 10.5 AC