

RECEIVED

JUN 01 2009

T.5S. R.3W. Section 16, W.M.

WATER RESOURCES DEPT
SALEM, OREGON

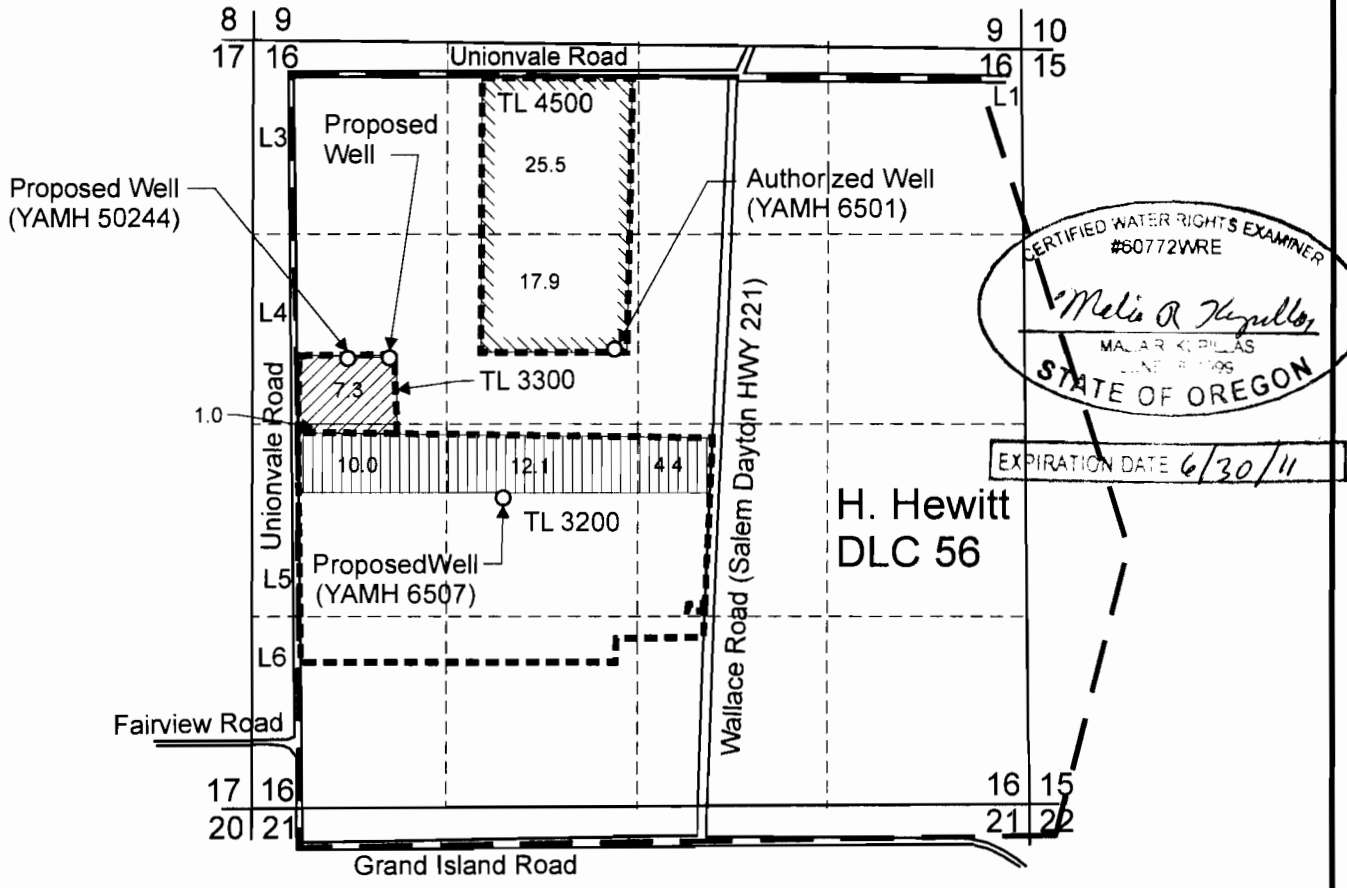

Authorized Well (YAMH 6501) is located 1890 feet south and 2230 feet east from the NW corner of DLC 56.

Proposed Well (YAMH 6507, Shelburne Transfer) is located 2910 feet south and 1460 feet east from the NW corner of DLC 56.

Proposed Well (YAMH 50244, Park Transfer) is located 1950 feet south and 390 feet east from the NW corner of DLC 56.

Proposed Well (To Be Drilled, Park Transfer) is located 1950 feet south and 680 feet east from the NW corner of DLC 56.

 Area (8.3 Acres, Park Transfer) under Application G-9138, Permit G-8464, Certificate 53095.

 Area (26.5 Acres, Shelburne Transfer) under Application G-9138, Permit G-8464, Certificate 53095.

 Remaining Certificate 53095 (43.4 Acres)

Scale: 1" = 1,320'



This map was prepared for the purpose of identifying the location of a water right only and is not intended to provide legal dimensions or location of property ownership lines.



Water Right Transfer Application Map

Kwi Chun and Hong Min Park
and
Darren Shelburne
T.5S. R.3W. Sec. 16, DLC 56

Pacific Hydro-Geology Inc.

5/2009

SteffenTransfer.cdr

T 10387