

SCALE: 1" = 1320'

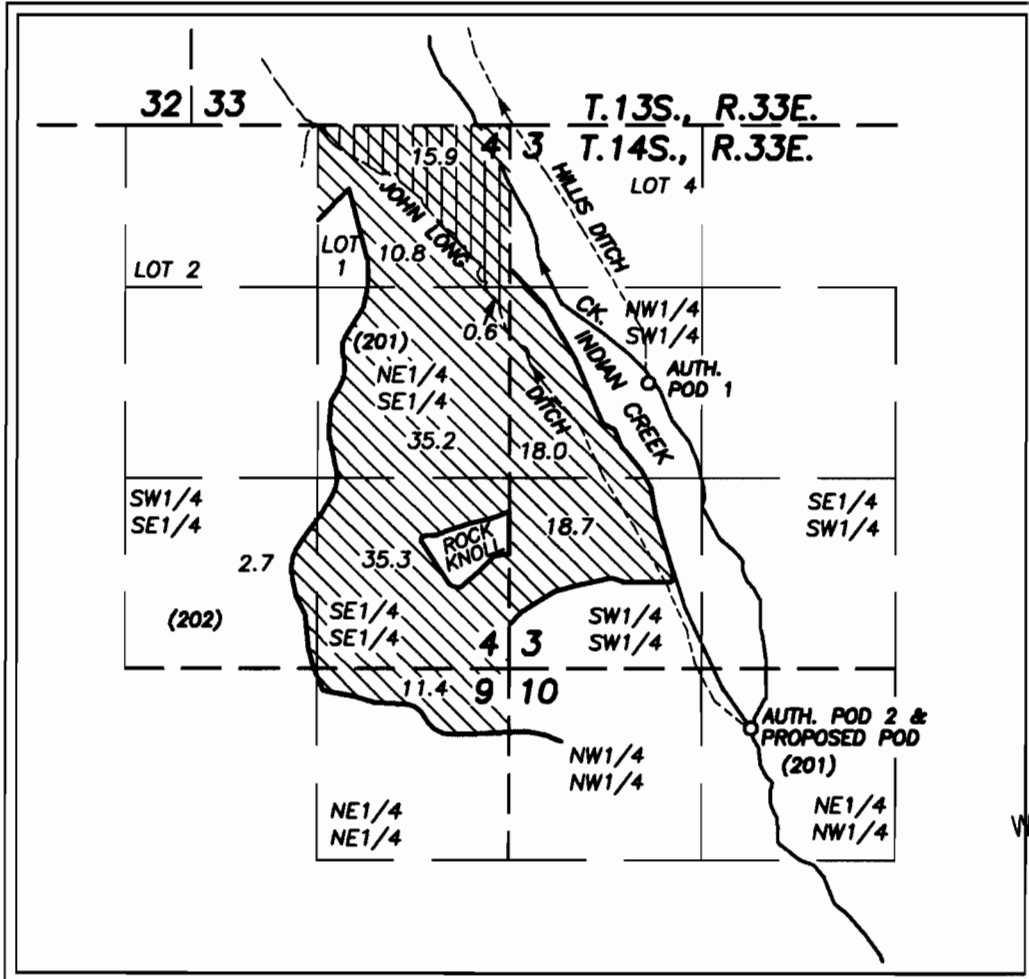

RECEIVED
 JUN 03 2009
 WATER RESOURCES DEPT
 SALEM, OREGON

AUTHORIZED POD'S AS LOCATED MAY 11, 2009
 AUTHORIZED POD#1: 7070 FT. SOUTH AND 3130 FT. EAST OF THE NW COR. SEC. 33, T.13S., R.33E.
 AUTHORIZED POD#2 AND PROPOSED POD: 9450 FT. SOUTH AND 3850 FT. EAST OF THE NW COR. SEC. 33, T.13S., R.33E.

FOUND BRASS CAP MONUMENT AT THE NW CORNER SECTION 33, T.13S., R.33E., W.M.

APPLICATION MAP
 FOR
 PROPOSED POINT OF DIVERSION CHANGE
 & CHANGE IN PLACE OF USE

- ACRES <30.0> C85029 REMAINING RIGHT- NOT AFFECTED BY THIS TRANSFER
- C25844 REMAINING RIGHT
- C25970 REMAINING RIGHT
- FROM C25844 16.5 AC TOTAL STOCKWATER ONLY
- TO C25970 16.5 AC. TOTAL STOCKWATER ONLY
- () TAX LOT NO.

BLUE MOUNTAIN ANGUS, LLC

BY
 ROBERT D. BAGETT
 217 N. CANYON BLVD.
 JOHN DAY, OREGON
 (541) 575-1251

MAY 13, 2009



NOTE: THE PREPARATION OF THIS MAP WAS FOR THE PURPOSE OF IDENTIFYING THE LOCATION OF THE PROPOSED WATER RIGHT AND HAS NO INTENT TO PROVIDE DIMENSIONS OR LOCATION OF PROPERTY OWNERSHIP LINES.

T 10898