

Water Right Transfer Map From Certificate #13831

T 38 S, R 8 W, WM, Josephine County

Portions of Sections 9, 10, and 11

June 20, 2009

6-20-2009
exp 12-31-2010

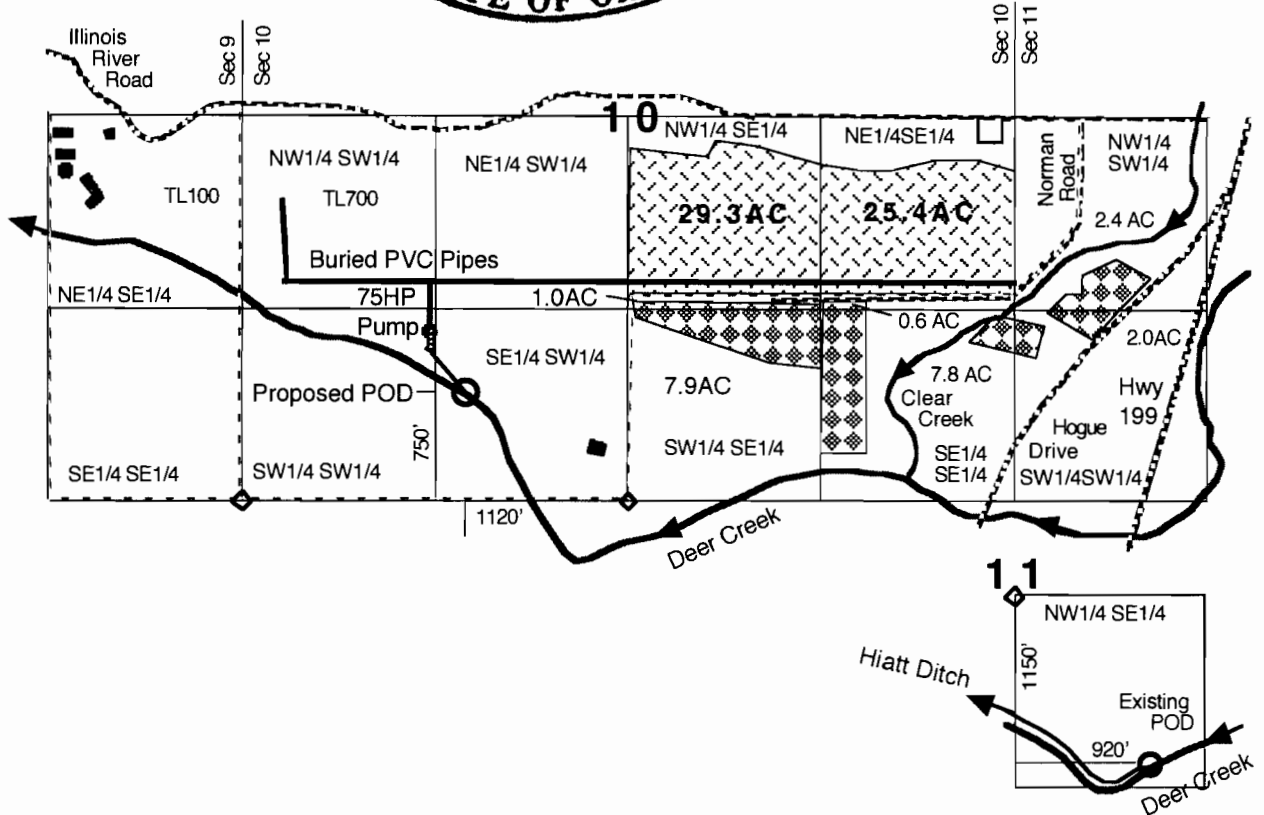
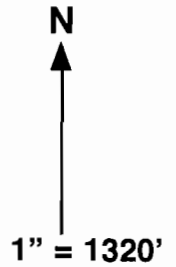

Illinois River Decree and Certificate #13831 with a priority of 1885 for irrigation at a rate of 1/50 cfs per acre from Deer Creek plus an additional 0.0104 cfs per acre with a priority of July 7, 1932.

- Points of Diversion (POD)
Proposed POD located 1120 feet West and 750 feet North from the S1/4 corner of Section 10.
Existing POD located 920 feet East and 1150 feet South from the Center of Section 11.

- 54.7 acres of irrigation rights under C #13831 proposed to change the POD.
- 21.7 acres of remaining irrigation rights under C #13831 not changing the POD .
- Streams and pond
- Buildings
- Roads

RECEIVED

JUN 25 2009

WATER RESOURCES DEPT
SALEM, OREGON

This map was drawn by Gordon R. Lyford for the Deer Creek Center to support their Water Right Transfer Application to change the POD of irrigation water from Deer Creek. The DCC owns tax lots 100 and 700.

This map was prepared for the purpose of identifying the location of water rights only and is not intended to provide legal dimensions or the location of property ownership lines.

3rd Revision Of Water Right Transfer Map From Certificate #19720
T 38 S, R 8 W, WM, Josephine County
Portions of Sections 9, 10, and 11

September 26, 2009

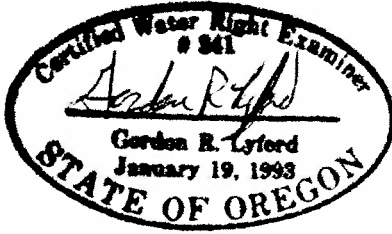

9-26-2009
 exp 12-31-2010

RECEIVED

OCT 05 2009

WATER RESOURCES DEPT
 SALEM, OREGON

N
 ↑
 1" = 1320'

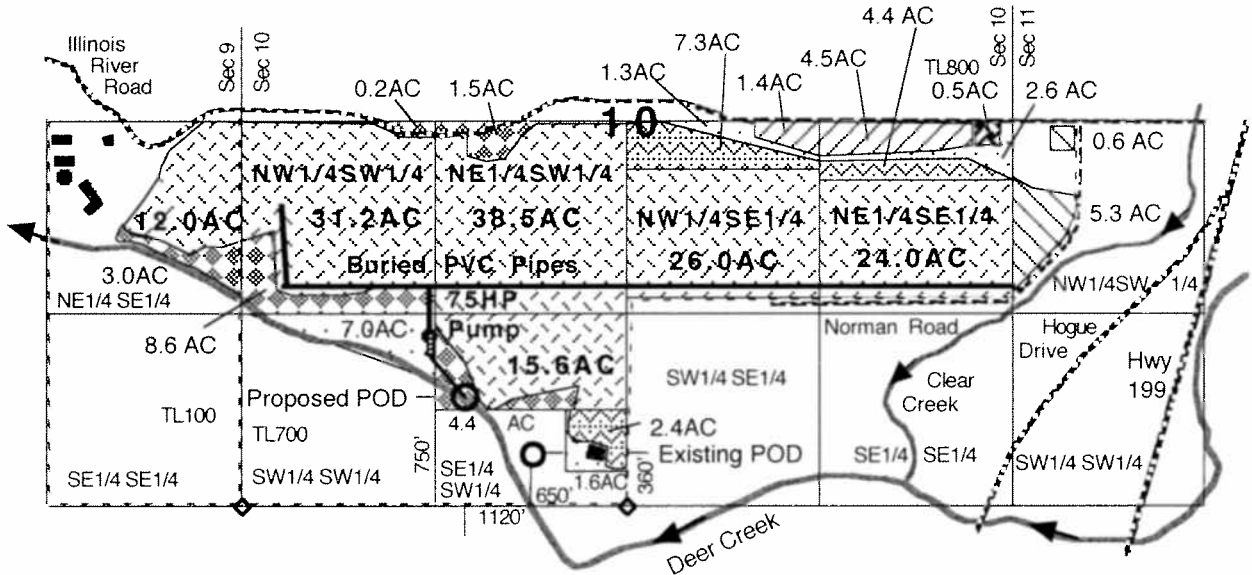

Application S-22760, Permit S-17867, and Certificate #19720 with a priority of August 15, 1947 for irrigation and supplemental irrigation at a rate of 1/50 cfs per acre from Deer Creek.

- Points of Diversion (POD)
 Proposed POD is located 1120 feet West and 750 feet North from the S1/4 corner of Section 10.
 Existing POD is located 650 feet West and 360 feet North from the S1/4 corner of Section 10.
- ▨ 5.9 acres of existing primary irrigation rights under C #19720 proposed to change the POU and POD.
- ▧ 5.9 acres proposed for primary irrigation rights by the transfer.
- ▩ 14.1 acres of primary irrigation rights under C #19720 proposed to change the POD.
- 147.3 acres of supplemental irrigation rights under C #19720 proposed to change the POD.
- 12.5 acres of abandoned primary irrigation rights under C #19720 to cancel.
- ▬ 17.7 acres of abandoned supplemental irrigation rights under C #19720 to cancel.
- ▭ 0.5 acres of remaining primary irrigation rights under C #19720 .
- ▮ Streams and pond
- ▯ Roads ■ Buildings

This map was drawn by Gordon R. Lyford for the Deer Creek Center to support their Water Right Transfer Application to change the POU and POD of irrigation and supplemental irrigation water from Deer Creek. The DCC owns tax lots 100 and 700.

This map was prepared for the purpose of identifying the location of water rights only and is not intended to provide legal dimensions or the location of property ownership lines.

Water Right Transfer Map From Certificate #85951
T 38 S, R 8 W, WM, Josephine County
Portions of Sections 9, 10, and 11
 December 30, 2009

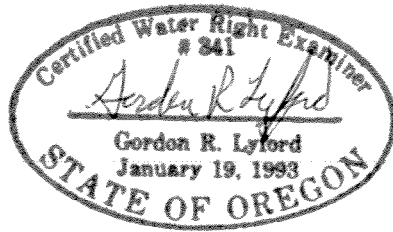

12-30-2009
exp 12-31-2010

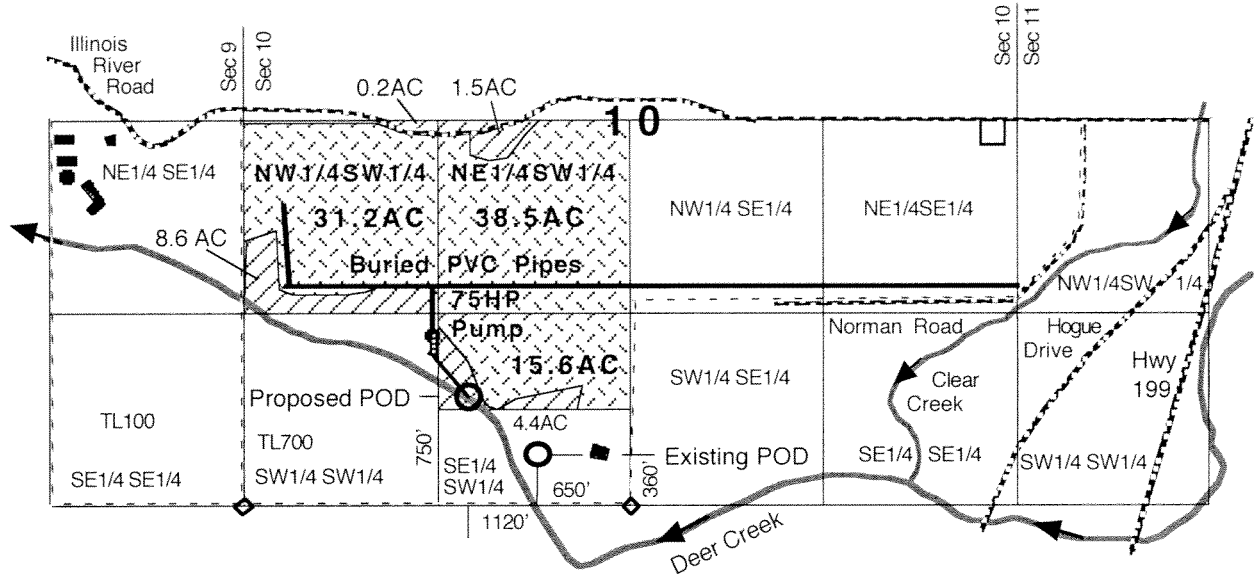
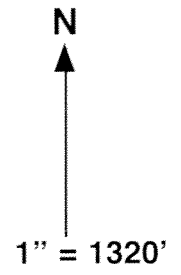

Application S-6480, Permit S-4255, Transfer B-113, and Certificate #85951 with a priority of April 8, 1919 for irrigation at a rate of 1/80 cfs per acre from Deer Creek.

- Points of Diversion (POD).
 Proposed POD located 1120 feet West and 750 feet North from the S1/4 corner of Section 10.
 Existing POD located 650 feet West and 360 feet North from the S1/4 corner of Section 10.
- 85.3 acres of irrigation rights under C #85951 proposed to change the POD.
- 14.7 acres of abandoned irrigation rights under C #85951 to cancel.
- Streams and pond
- Buildings
- Roads

RECEIVED
JAN 08 2010
 WATER RESOURCES DEPT
 SALEM, OREGON

This map was drawn by Gordon R. Lyford for the Deer Creek Center to support their Water Right Transfer Application to change the POD of irrigation water from Deer Creek. The DCC owns tax lots 100 and 700.

This map was prepared for the purpose of identifying the location of water rights only and is not intended to provide legal dimensions or the location of property ownership lines.

Water Right Partial Cancellation Map From Certificate #6067 *Superseded by Certificate 85951*
T 38 S, R 8 W, WM, Josephine County
Portions of Sections 9, 10, and 11
 January 20, 2009

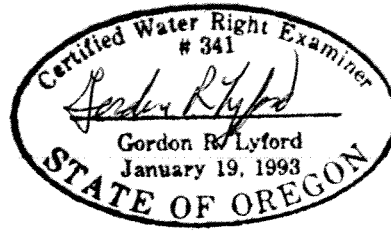

1-20-2009
12-31-2010

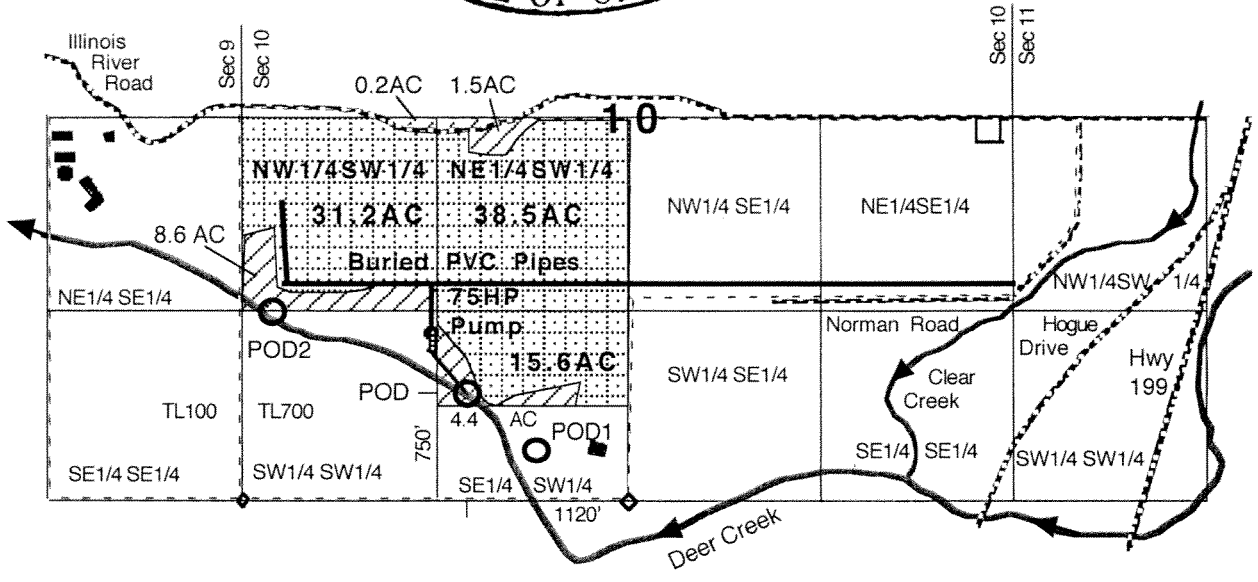
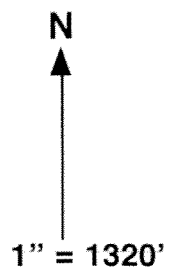

Application S-6480, Permit S-4255, and Certificate #6067 with a priority of April 8, 1919 for irrigation at a rate of 1/80 cfs per acre from Deer Creek.

- Points of Diversion (POD) POD, POD1, and POD2.
 Actual POD located 1120 feet West and 750 feet North of the S1/4 corner of Section 10.
 Authorized POD1 located 650 feet West and 360 feet North of the S1/4 corner of Section 10.
 Authorized POD2 located 200 feet East and 1320 feet North of the SW corner of Section 10.

- 85.3 acres of remaining primary irrigation rights under C #6067.
- 14.7 acres of abandoned primary irrigation rights under C #6067 to cancel.
- Streams and pond
- Buildings
- Roads

RECEIVED
FEB 26 2009
 WATER RESOURCES DEPT
 SALEM, OREGON

This map was drawn by Gordon R. Lyford for the Deer Creek Center to support the partial cancellation of irrigation water rights from Deer Creek under Certificate #6067. The DCC owns tax lots 100 and 700.

This map was prepared for the purpose of identifying the location of water rights only and is not intended to provide legal dimensions or the location of property ownership lines.

T 10794

T. 38 S., R. 8 W., W. M.
 Scale 4" = 1 Mile. July 1947

Deer Creek Ranch

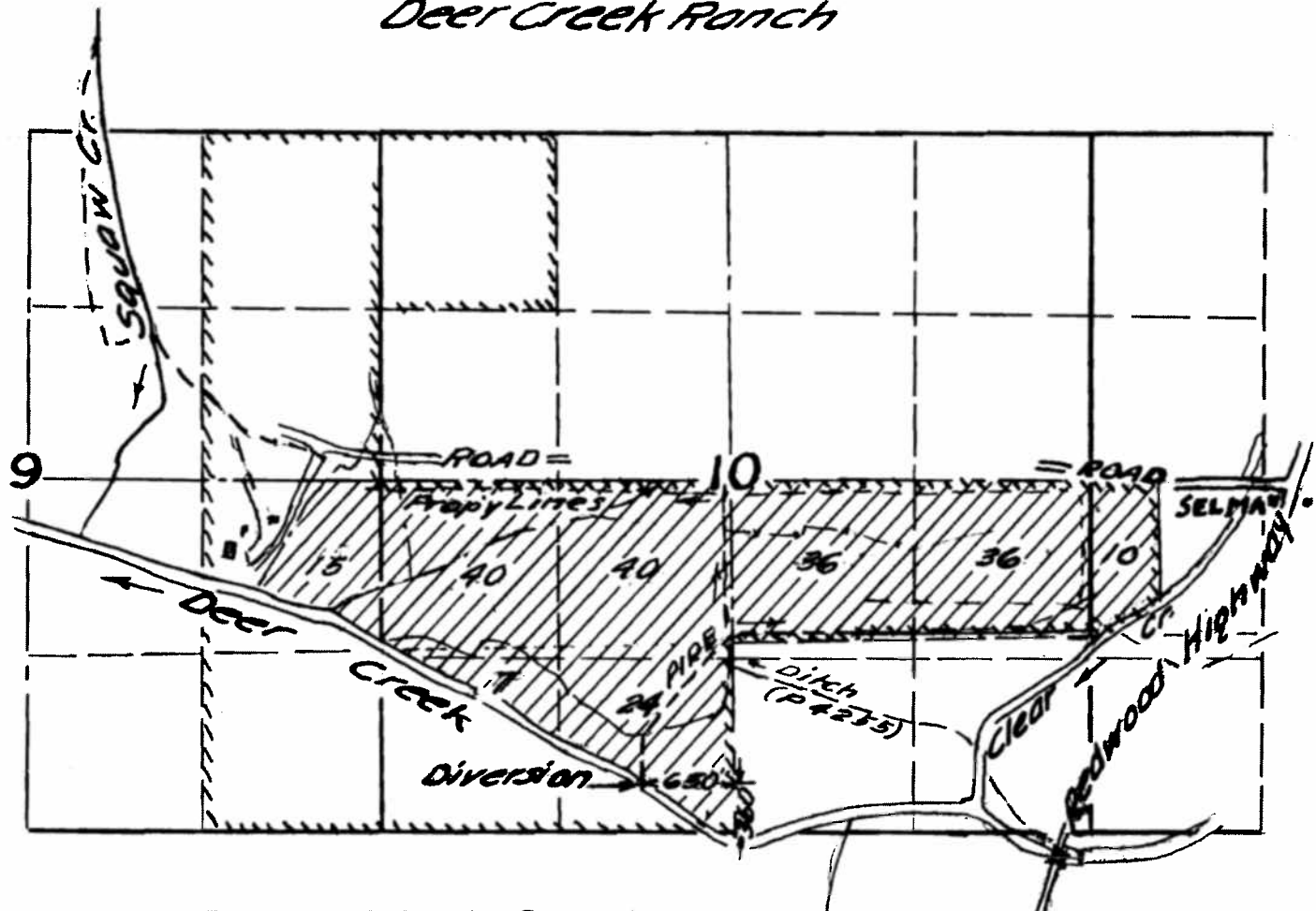

I, Tom R. Pearce, of Grants Pass, Oregon do hereby certify that this map was made from notes taken during an actual survey made by me on August 5, 1947; that the monument shown on this map consisting of 2" pipe and foundation structures is 360 feet North and 650 feet West from the South Quarter corner of Section 10 T38 South R8 West Willamette Meridian.

22760
 18567

RECEIVED
 STATE ENGINEER
 SPOKANE

Application No. 22760
 Permit No. 17867

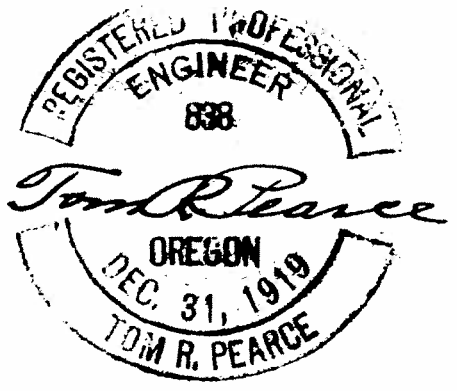

J. H. Fomeroy

Application No.
 Permit No.

T 10794

T. 38 S., R. 8 W., W. M.
 Scale 4" = 1 Mile. July 1947

Deer Creek Ranch

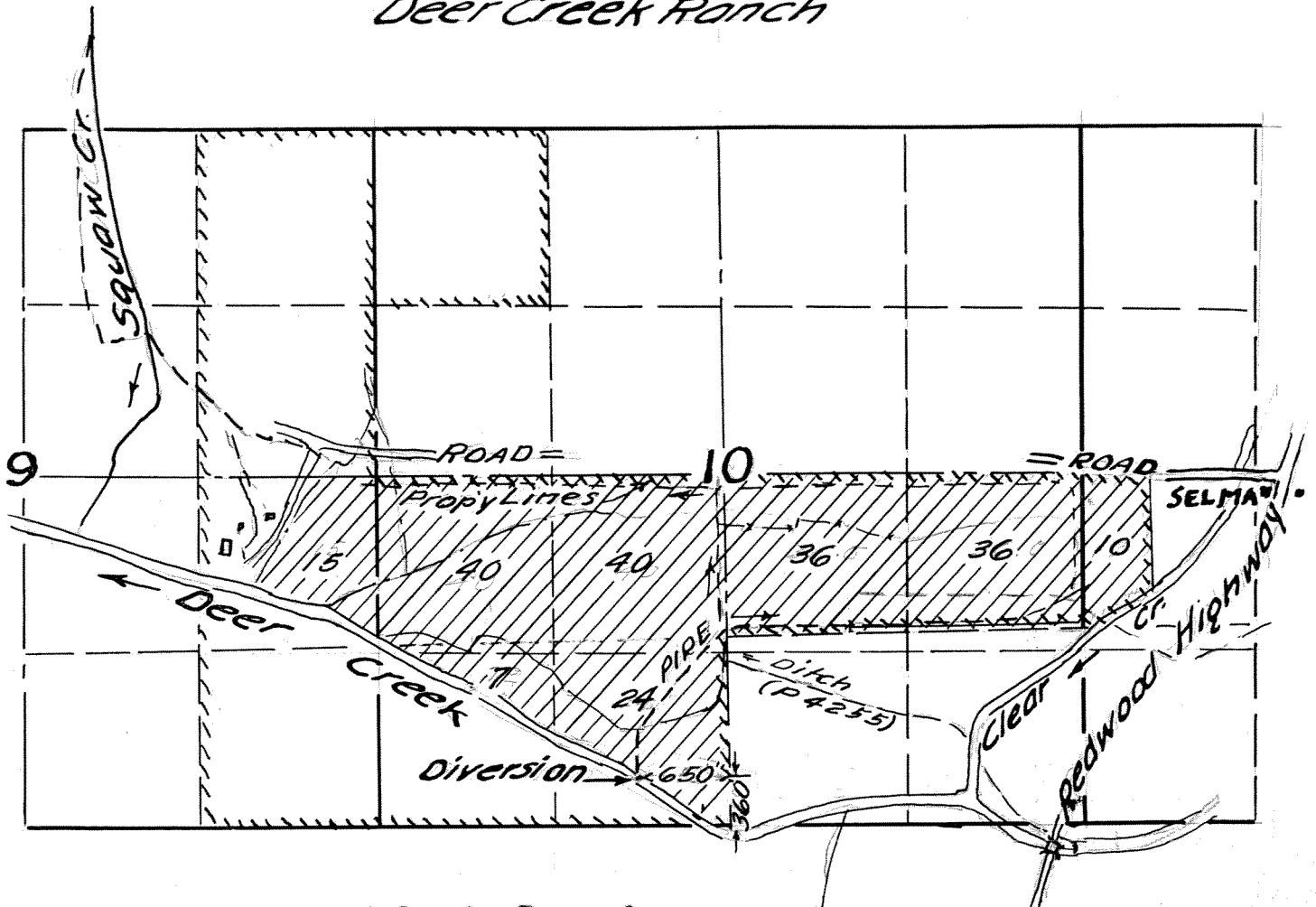

I, Tom R. Pearce, of Grants Pass, Oregon do hereby certify that this map was made from notes taken during an actual survey made by me on August 5, 1947; that the monument shown on this map consisting of 2" pipe and foundation structures is 360 feet North and 650 feet West from the South Quarter corner of Section 10 T38 South R8 West Willamette Meridian.

22760
 15-560

RECEIVED
 AUG 25 1947
 STATE ENGINEER
 SALEM, OREGON

Application No. 22760
 Permit No. 17867

REGISTERED PROFESSIONAL
 ENGINEER
 838
 Tom R. Pearce
 OREGON
 DEC. 31, 1919
 TOM R. PEARCE

J. H. Pomeroy

Application No.
 Permit No.

RECEIVED

OCT 14 2009

WATER RESOURCES DEPT
SALEM, OREGON

29



TICOR TITLE

This map and the accompanying
legal description are provided solely
to assist in locating the subject property.
TICOR title assumes no liability for other encroachments.

28

27

SEE

3'

589'50"W
79.75 ch

N89°49'W
80.0 ch.

C.S. 64-90 N89°48'W
78.65 ch.

32

33

34

SEE

37

Fl. N89°40'W 20.106' 20.106' 20.234' 20.234' Fl.

1400
80.00
Ac.

1500
75.45
Ac.

1700
100.00
Ac.

1800
320.0
Ac.

LOT 1
37.32A
1900
89.63
Ac.

LOT 2
37.37

LOT 3
37.42
1901
19.95
Ac.

2000
45.0 Ac.
LOT 4
37.47

1600
4.55 Ac.

SEE MAP 38 8

SQUAW

CR.

SUBJECT PROPERTY

C.S. 82-2000

C.S. 110-81

89°57'W 40.85 ch

589'52E 25.78 ch

589'37W 1.48 ch.

589°24'E 37.62 ch.

589°45'E 45.87-95

39.2 ch.

77.26 ch N89°58'E

BOOK 18

SECTION 10 T38S R8W W.M.
JOSEPHINE COUNTY
1" = 400'

38 8 D

This map was prepared for
assessment purposes only.

RECEIVED

OCT 14 2009

WATER RESOURCES DEPT
SALEM, OREGON

TICOR TITLE
This map and the accompanying
legal description are provided solely
to assist in locating the subject property.
TICOR Title does not assume any liability for discrepancies.

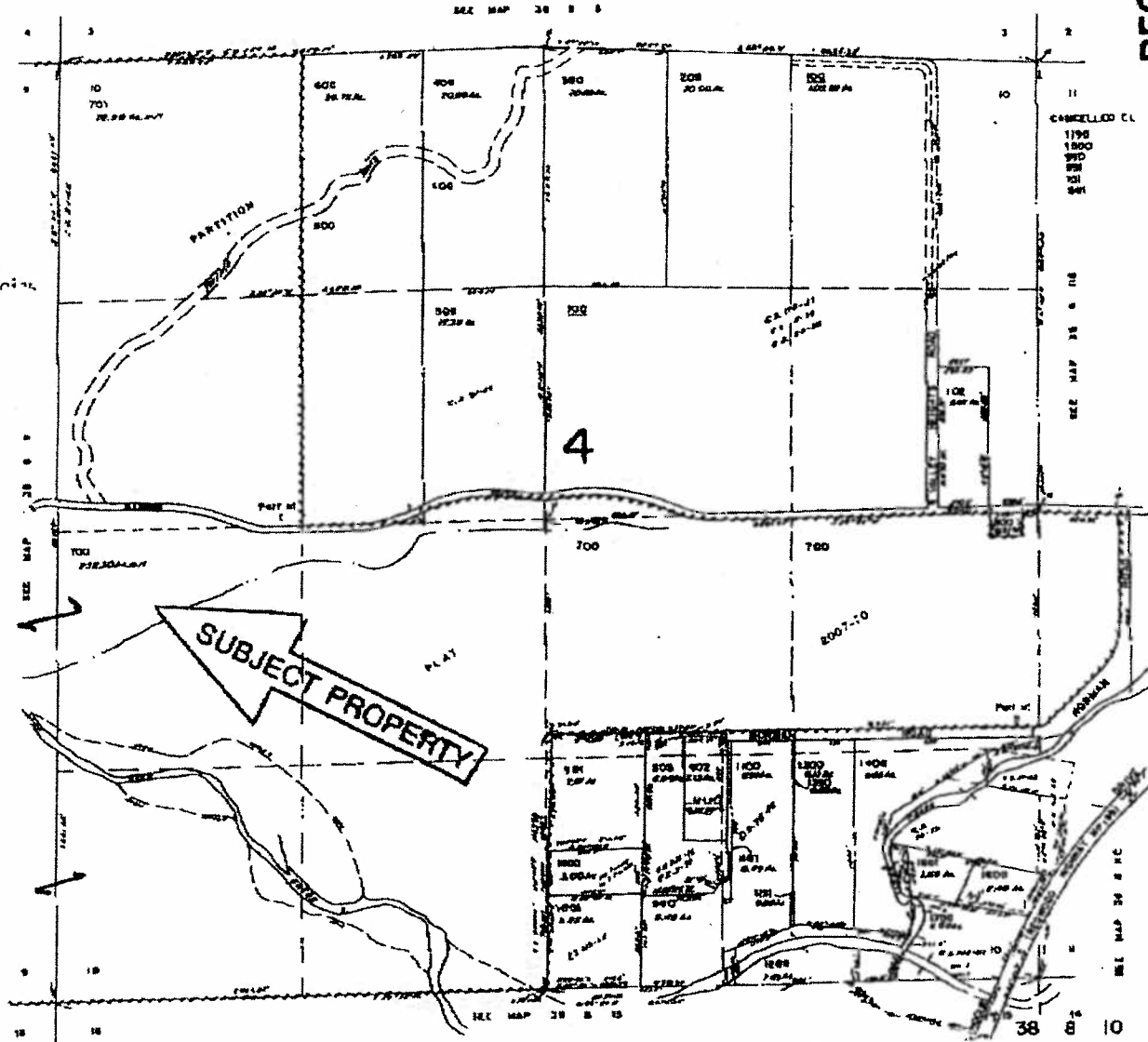

Revised Water Right Transfer Map From Certificate #6067

T 38 S, R 8 W, WM, Josephine County

Portions of Sections 9, 10, and 11

August 26, 2009

N

1" = 1320'

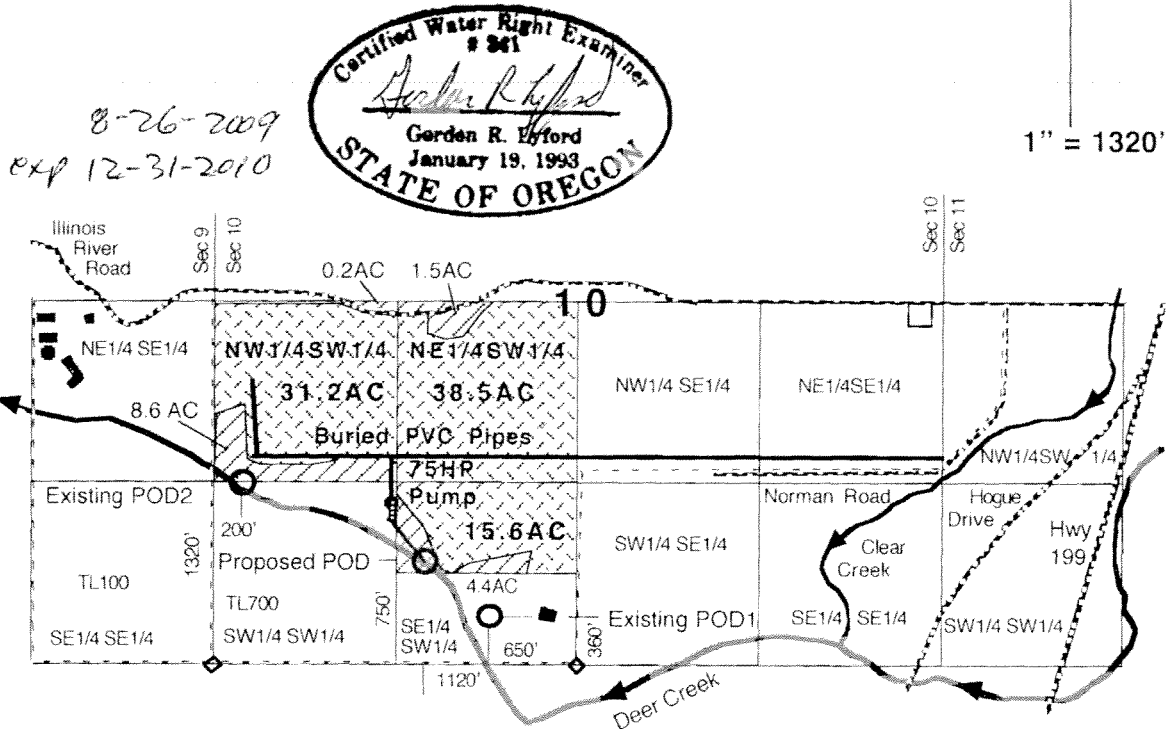

8-26-2009
exp 12-31-2010

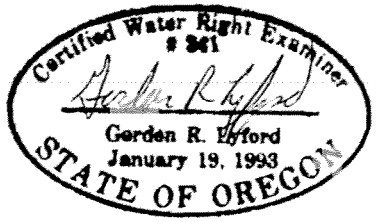

Application S-6480, Permit S-4255, and Certificate #6067 with a priority of April 8, 1919 for irrigation at a rate of 1/80 cfs per acre from Deer Creek.

- Points of Diversion (POD).
Proposed POD located 1120 feet West and 750 feet North from the S1/4 corner of Section 10.
Existing POD1 located 650 feet West and 360 feet North from the S1/4 corner of Section 10.
Existing POD2 located 200 feet East and 1320 feet North from the SW corner of Section 10.

- 85.3 acres of irrigation rights under C #6067 proposed to change the POD.
- 14.7 acres of abandoned irrigation rights under C #6067 to cancel.
- Streams and pond
- Buildings
- Roads

RECEIVED

AUG 31 2009

WATER RESOURCES DEPT
SALEM, OREGON

This map was drawn by Gordon R. Lyford for the Deer Creek Center to support their Water Right Transfer Application to change the POD of irrigation water from Deer Creek. The DCC owns tax lots 100 and 700.

This map was prepared for the purpose of identifying the location of water rights only and is not intended to provide legal dimensions or the location of property ownership lines.

RECEIVED

SEP 21 2009

WATER RESOURCES DEPT
SALEM, OREGON

Water Right Transfer Map From Certificate #13831

T 38 S, R 8 W, WM, Josephine County

Portions of Sections 9, 10, and 11

June 20, 2009

6-20-2009
exp 12-31-2010

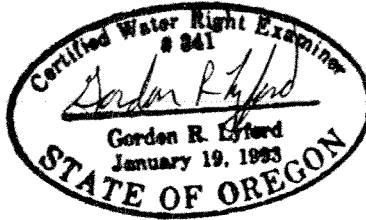

overlays C-19720
3.3 ac NW/SE
1.4 ac NE/SE

1" = 1320'

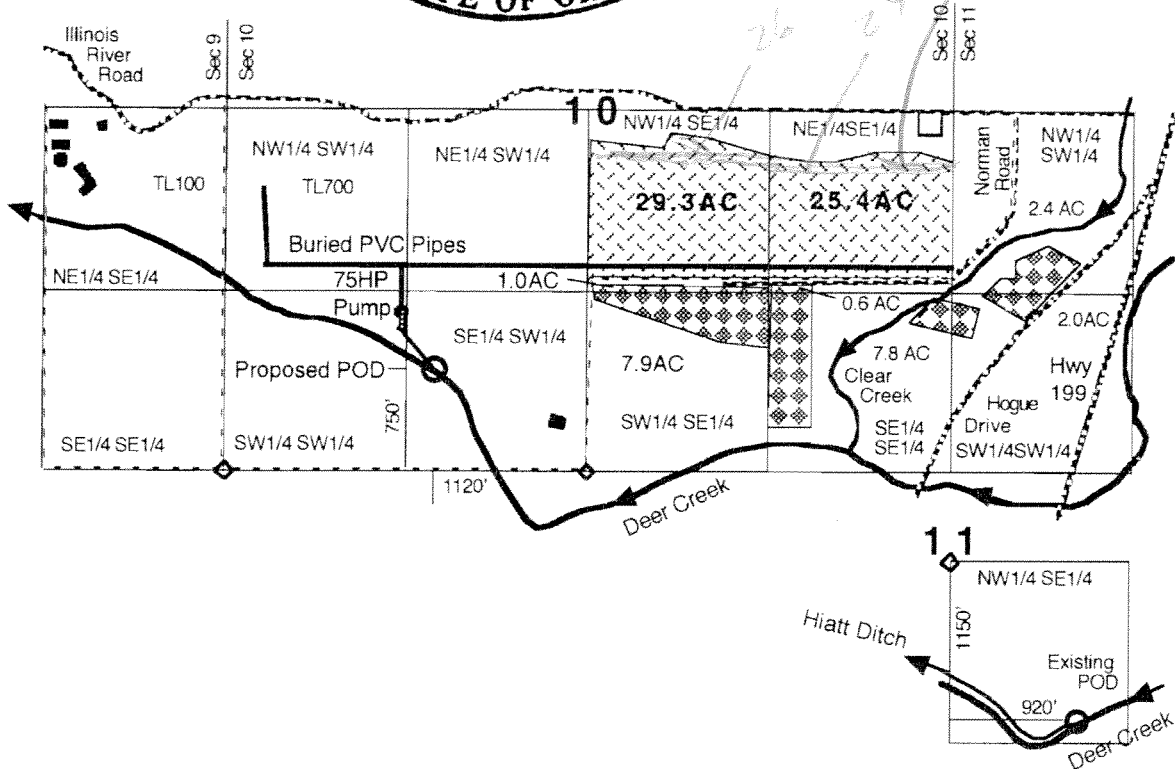

Illinois River Decree and Certificate #13831 with a priority of 1885 for irrigation at a rate of 1/50 cfs per acre from Deer Creek plus an additional 0.0104 cfs per acre with a priority of July 7, 1932.

- Points of Diversion (POD)
Proposed POD located 1120 feet West and 750 feet North from the S1/4 corner of Section 10.
Existing POD located 920 feet East and 1150 feet South from the Center of Section 11.

- 54.7 acres of irrigation rights under C #13831 proposed to change the POD.
- 21.7 acres of remaining irrigation rights under C #13831 not changing the POD.
- Streams and pond
- Buildings
- Roads

RECEIVED

JUN 25 2009

WATER RESOURCES DEPT
SALEM, OREGON

This map was drawn by Gordon R. Lyford for the Deer Creek Center to support their Water Right Transfer Application to change the POD of irrigation water from Deer Creek. The DCC owns tax lots 100 and 700.

This map was prepared for the purpose of identifying the location of water rights only and is not intended to provide legal dimensions or the location of property ownership lines.

RECEIVED

SEP 21 2009

WATER RESOURCES DEPT

T385 R8W

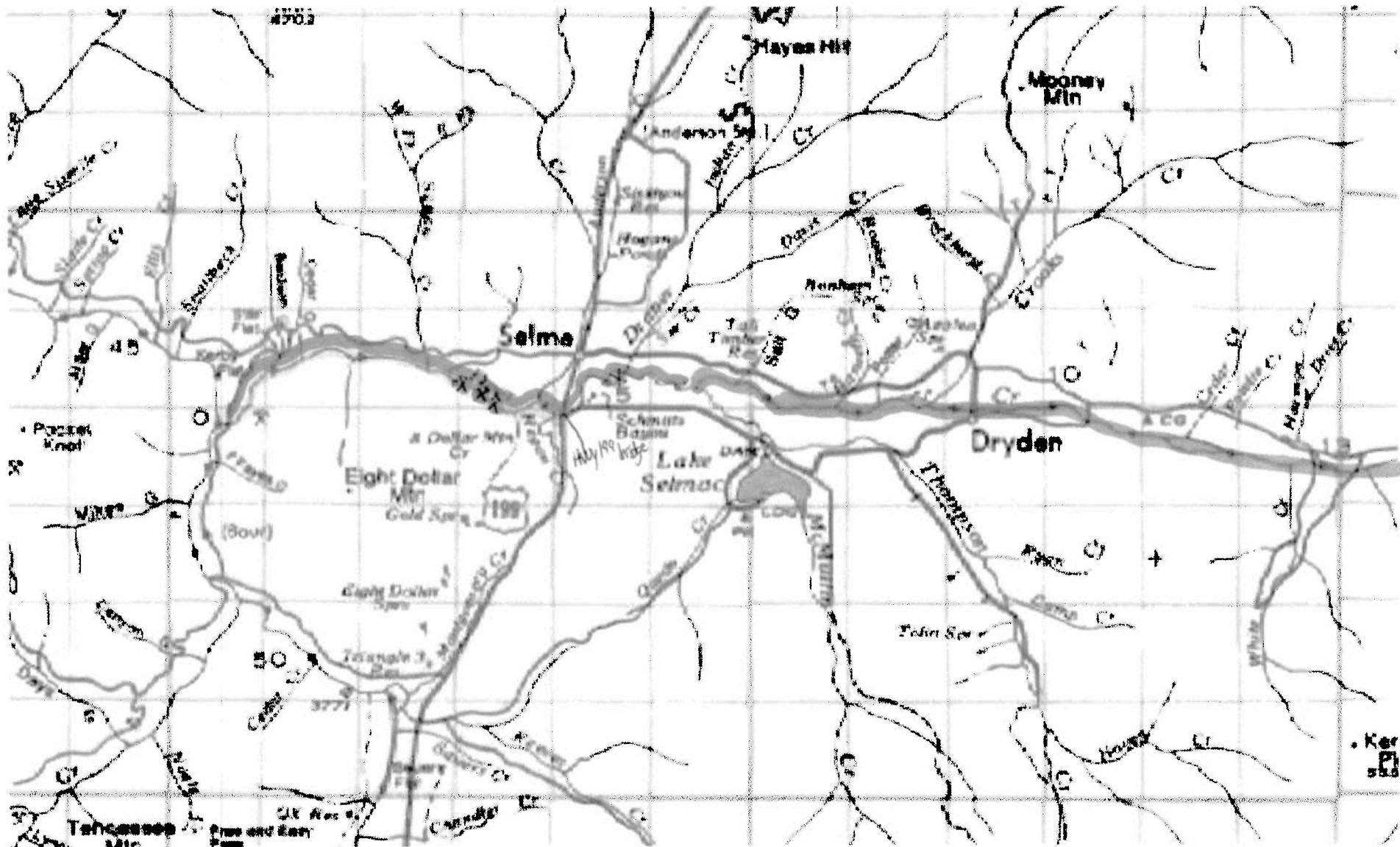

✱ Existing PODs ● Proposed POD

★  ISWR Cert 59768 ODFW+DEQ up to 70cfs Priority 11/3/1983

 ISWR Cert 73028 ODFW up to 120cfs Priority 12/7/1990 — None applicable because reach is upstream

★  ISWR Cert 73029 ODFW up to 100cfs Priority 12/7/1990

T. 38 S R 8 W

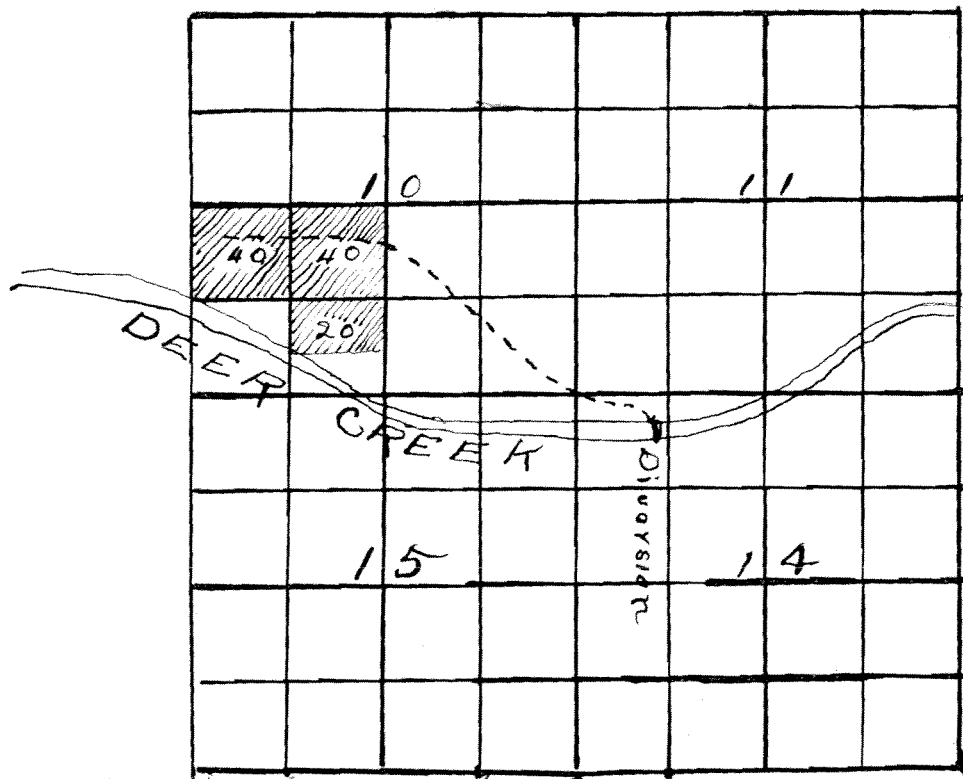

Application No. 6480

Permit No. 4255

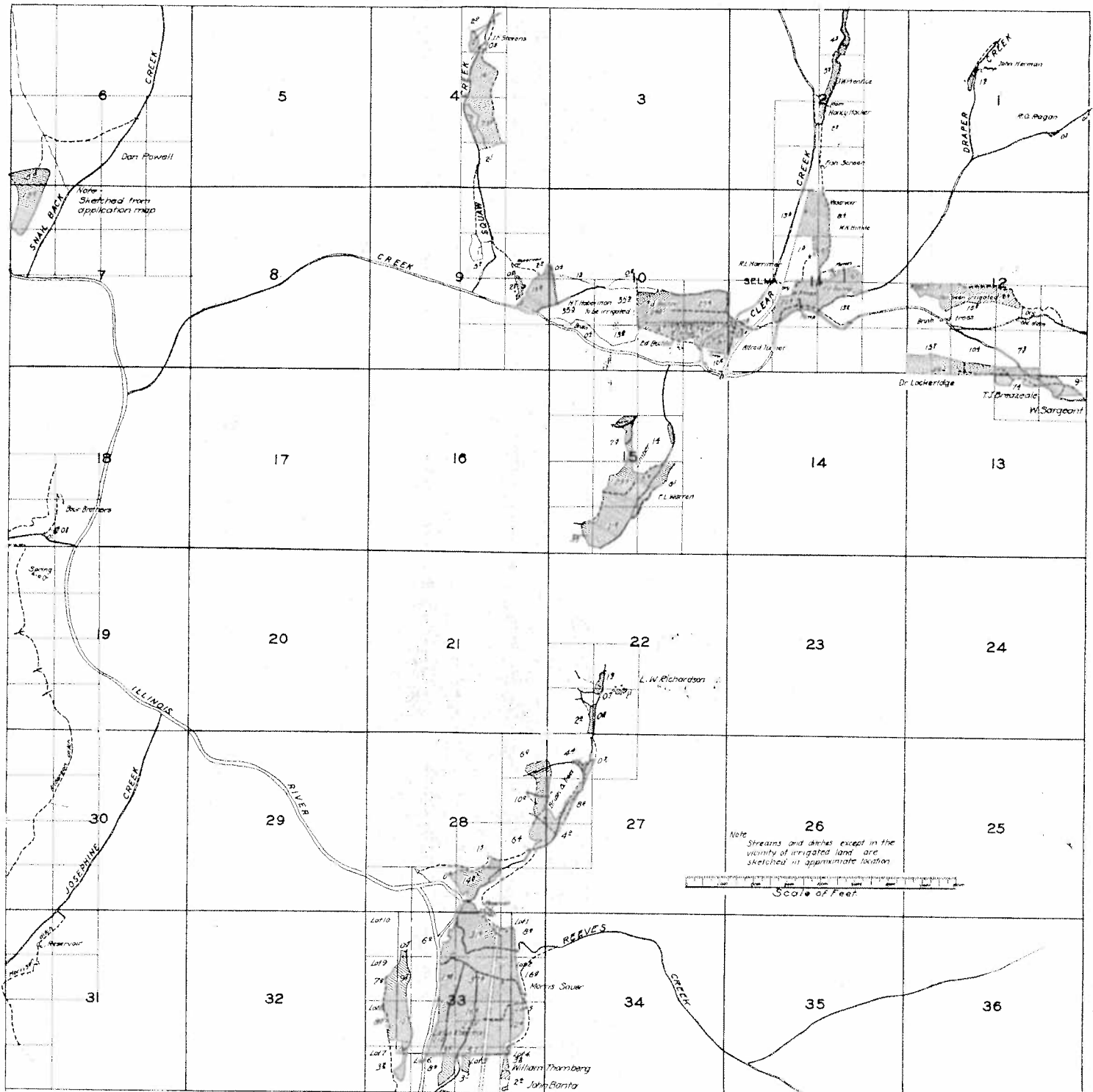

Note:
Streams and ditches except in the vicinity of irrigated land are sketched in approximate location.

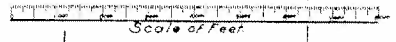

Superseded by map
received 6/25/09

Water Right Transfer Map From Certificate #19720

T 38 S, R 8 W, WM, Josephine County

Portions of Sections 9, 10, and 11

January 20, 2009

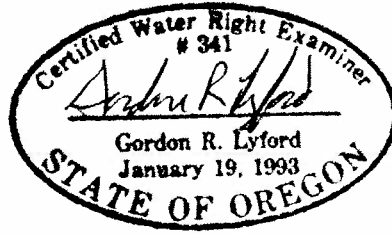





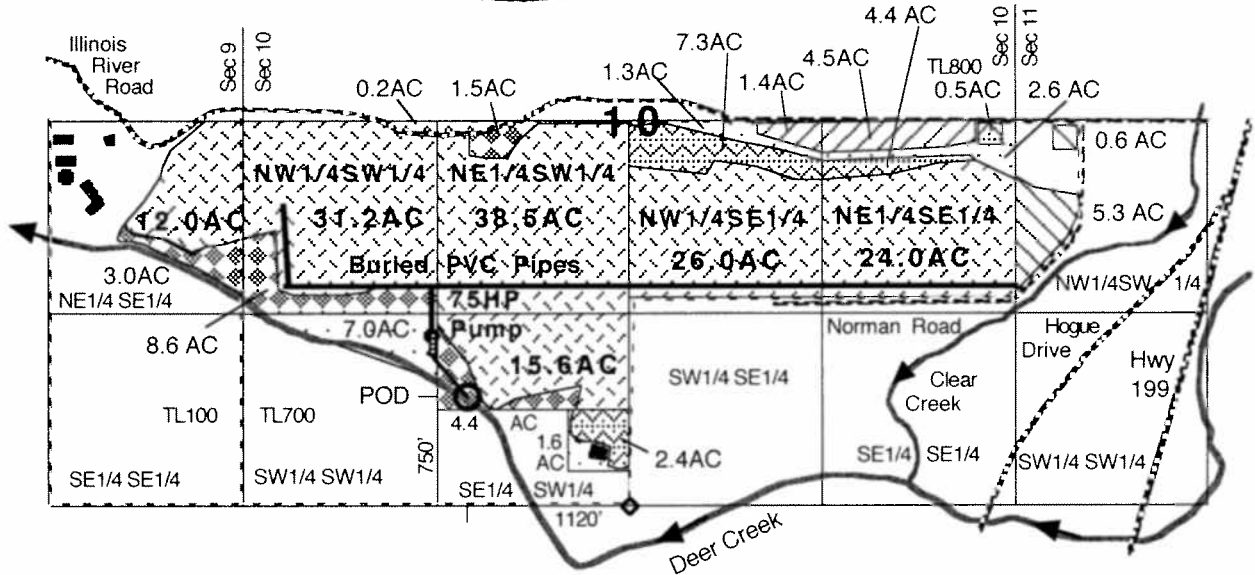



1-20-2009
12-31-2010

N
1" = 1320'



Application S-22760, Permit S-17867, and Certificate #19720 with a priority of August 15, 1947 for irrigation and supplemental irrigation at a rate of 1/50 cfs per acre from Deer Creek.

- Point of Diversion (POD) located 1120 feet West and 750 feet North of the S1/4 corner of Section 10.
-  5.9 acres of existing primary irrigation rights under C #19720 to transfer.
-  5.9 acres proposed for primary irrigation rights by the transfer.
-  14.6 acres of remaining primary irrigation rights under C #19720.
-  147.3 acres of remaining supplemental irrigation rights under C #19720.
-  12.5 acres of abandoned primary irrigation rights under C #19720 to cancel.
-  17.7 acres of abandoned supplemental irrigation rights under C #19720 to cancel.
-  Streams and pond
-  Buildings
-  Roads

RECEIVED

FEB 26 2009

WATER RESOURCES DEPT
SALEM, OREGON

This map was drawn by Gordon R. Lyford for the Deer Creek Center to support their Water Right Transfer Application to change the POU of irrigation water from Deer Creek. The DCC owns tax lots 100 and 700.

This map was prepared for the purpose of identifying the location of water rights only and is not intended to provide legal dimensions or the location of property ownership lines.

T 10794

Revised Water Right Transfer Map From Certificate #19720

T 38 S, R 8 W, WM, Josephine County

Portions of Sections 9, 10, and 11

June 20, 2009

6-20-2009
exp 12-31-2010

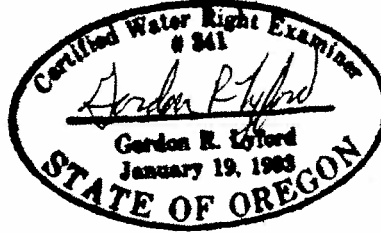



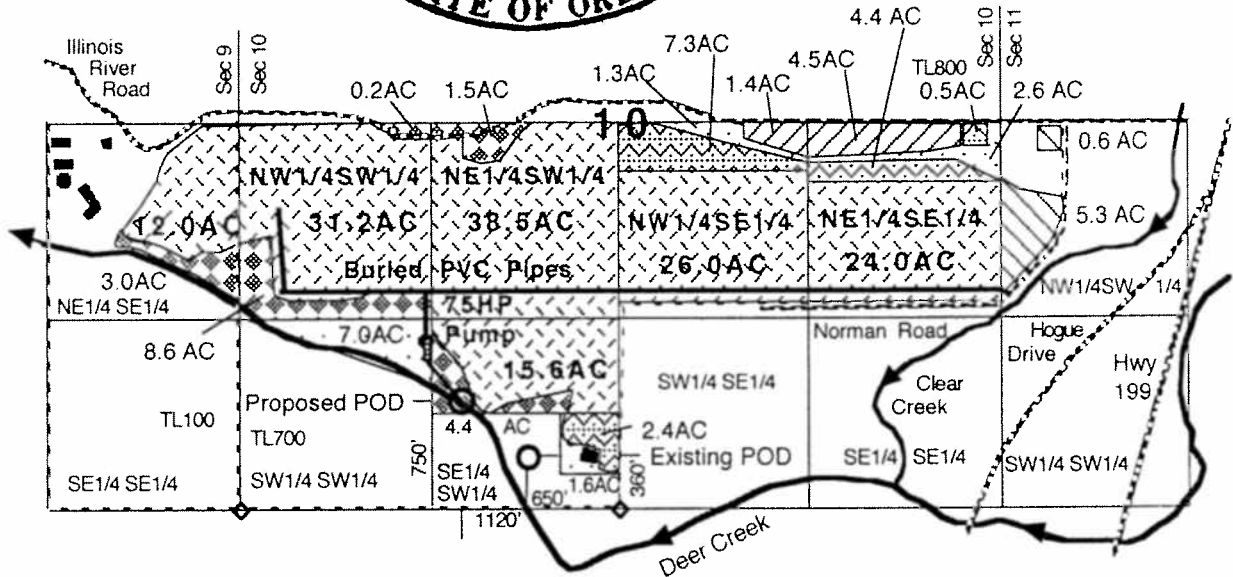





N
1" = 1320'



Application S-22760, Permit S-17867, and Certificate #19720 with a priority of August 15, 1947 for irrigation and supplemental irrigation at a rate of 1/50 cfs per acre from Deer Creek.

- Points of Diversion (POD)
Proposed POD is located 1120 feet West and 750 feet North from the S1/4 corner of Section 10.
Existing POD is located 650 feet West and 360 feet North from the S1/4 corner of Section 10.

-  5.9 acres of existing primary irrigation rights under C #19720 to transfer.
-  5.9 acres proposed for primary irrigation rights by the transfer.
-  14.6 acres of remaining primary irrigation rights under C #19720.
-  147.3 acres of remaining supplemental irrigation rights under C #19720.
-  12.5 acres of abandoned primary irrigation rights under C #19720 to cancel.
-  17.7 acres of abandoned supplemental irrigation rights under C #19720 to cancel.
-  Streams and pond
-  Buildings
-  Roads

RECEIVED

JUL 02 2009

WATER RESOURCES DEPT
SALEM, OREGON

This map was drawn by Gordon R. Lyford for the Deer Creek Center to support their Water Right Transfer Application to change the POU and POD of irrigation and supplemental irrigation water from Deer Creek. The DCC owns tax lots 100 and 700.

This map was prepared for the purpose of identifying the location of water rights only and is not intended to provide legal dimensions or the location of property ownership lines.

Water Right Transfer Map From Certificate #6067

T 38 S, R 8 W, WM, Josephine County

Portions of Sections 9, 10, and 11

June 20, 2009

6-20-2009
exp 12-31-2010

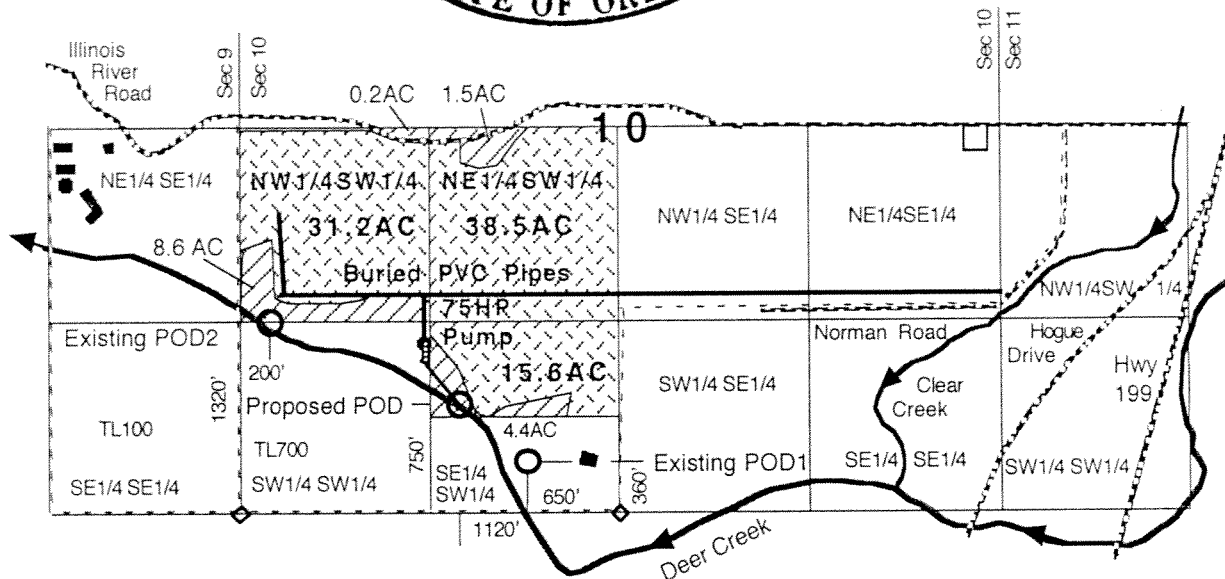
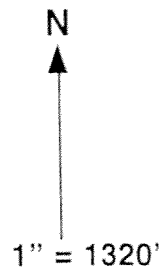
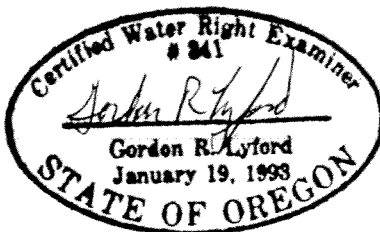

Application S-6480, Permit S-4255, and Certificate #6067 with a priority of April 8, 1919 for irrigation at a rate of 1/80 cfs per acre from Deer Creek.

- Points of Diversion (POD).
Proposed POD located 1120 feet West and 750 feet North from the S1/4 corner of Section 10.
Existing POD1 located 650 feet West and 360 feet North from the S1/4 corner of Section 10.
Existing POD2 located 200 feet East and 1320 feet North from the SW corner of Section 10.

85.3 acres of remaining primary irrigation rights under C #6067.

14.7 acres of abandoned primary irrigation rights under C #6067 to cancel.

Streams and pond

Buildings

Roads

RECEIVED

JUL 02 2009

**WATER RESOURCES DEPT
SALEM, OREGON**

This map was drawn by Gordon R. Lyford for the Deer Creek Center to support their Water Right Transfer Application to change the POD of irrigation water from Deer Creek. The DCC owns tax lots 100 and 700.

This map was prepared for the purpose of identifying the location of water rights only and is not intended to provide legal dimensions or the location of property ownership lines.

Water Right Transfer Map From Certificate #13831

T 38 S, R 8 W, WM, Josephine County

Portions of Sections 9, 10, and 11

June 20, 2009

6-20-2009
exp 12-31-2010

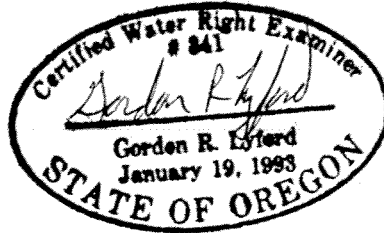

N
1" = 1320'

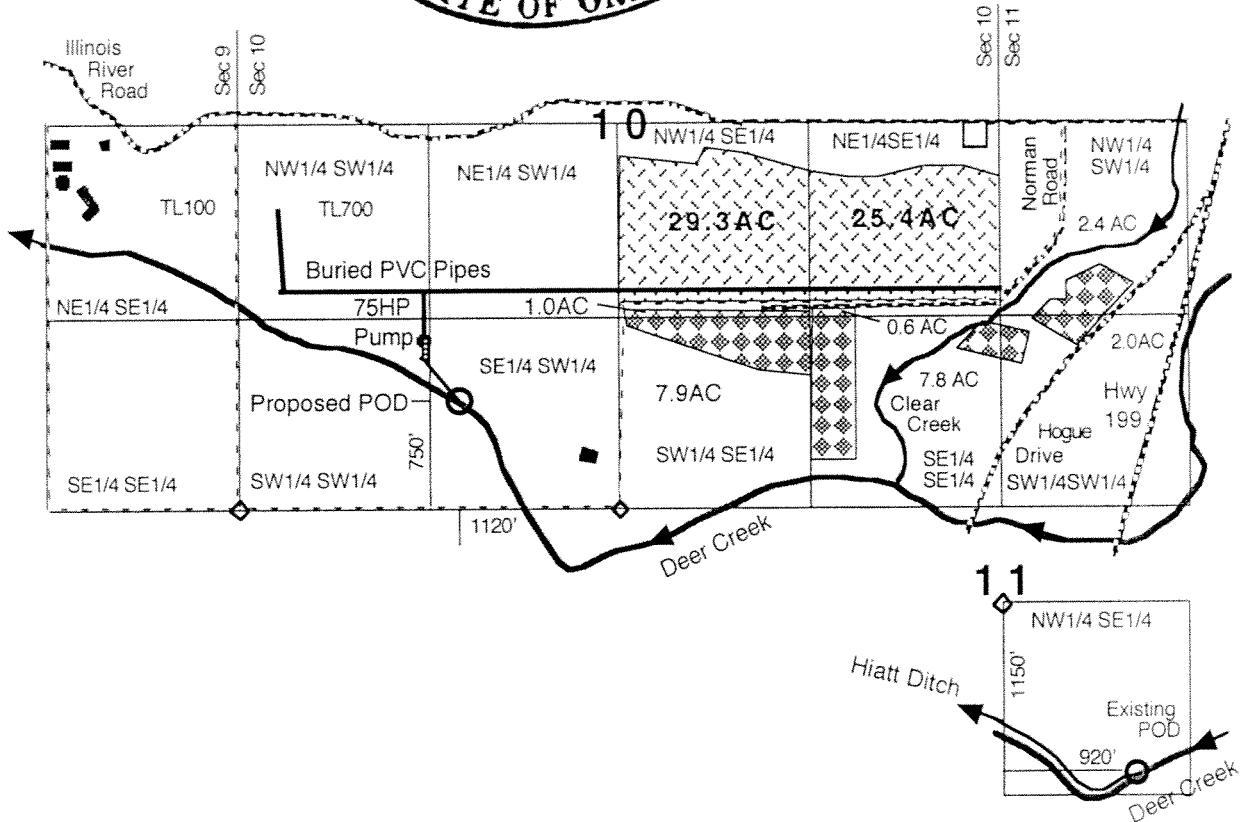

Illinois River Decree and Certificate #13831 with a priority of 1885 for irrigation at a rate of 1/50 cfs per acre from Deer Creek plus an additional 0.0104 cfs per acre with a priority of July 7, 1932.

- Points of Diversion (POD)
Proposed POD located 1120 feet West and 750 feet North from the S1/4 corner of Section 10.
Existing POD located 920 feet East and 1150 feet South from the Center of Section 11.
- 54.7 acres of irrigation rights under C #13831 proposed to change the POD.
- 21.7 acres of remaining irrigation rights under C #13831 not changing the POD.
- Streams and pond
- Buildings
- Roads

RECEIVED
JUL 02 2009
WATER RESOURCES DEPT
SALEM, OREGON

This map was drawn by Gordon R. Lyford for the Deer Creek Center to support their Water Right Transfer Application to change the POD of irrigation water from Deer Creek. The DCC owns tax lots 100 and 700.

This map was prepared for the purpose of identifying the location of water rights only and is not intended to provide legal dimensions or the location of property ownership lines.

Superseded by map received 8/31/09

Revised Water Right Transfer Map From Certificate #19720
T 38 S, R 8 W, WM, Josephine County
Portions of Sections 9, 10, and 11

June 20, 2009

6-20-2009
exp 12-31-2010

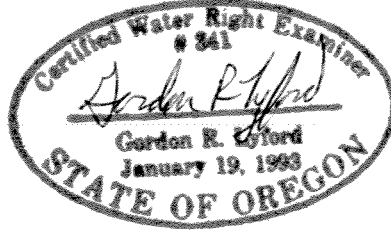

N
 1" = 1320'

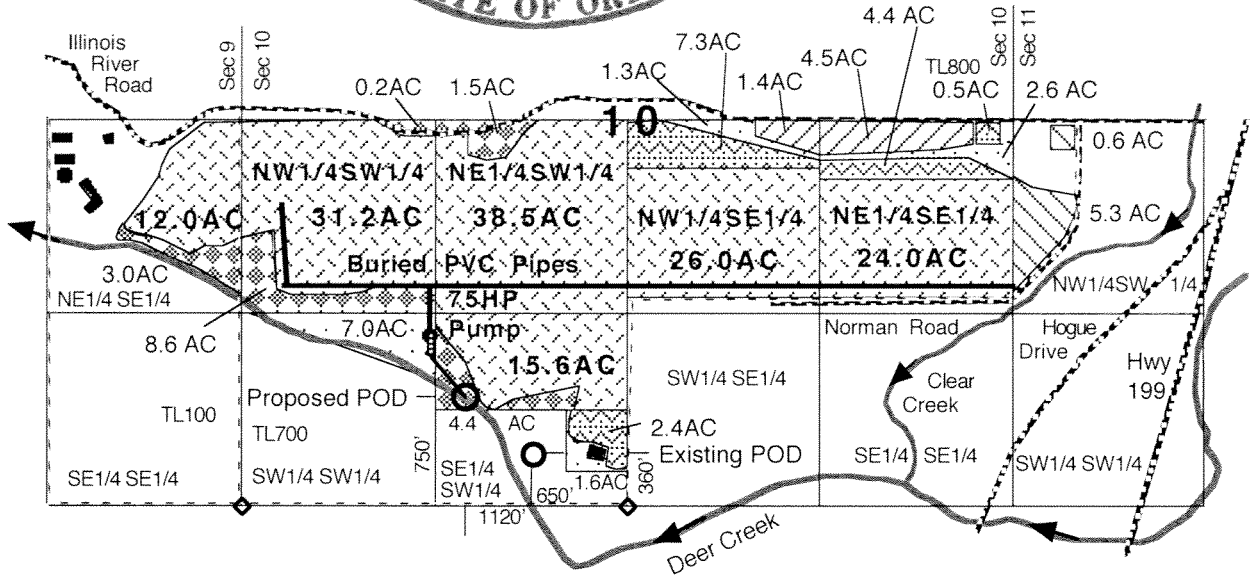

Application S-22760, Permit S-17867, and Certificate #19720 with a priority of August 15, 1947 for irrigation and supplemental irrigation at a rate of 1/50 cfs per acre from Deer Creek.

- Points of Diversion (POD)
 Proposed POD is located 1120 feet West and 750 feet North from the S1/4 corner of Section 10.
 Existing POD is located 650 feet West and 360 feet North from the S1/4 corner of Section 10.

- 5.9 acres of existing primary irrigation rights under C #19720 to transfer.
- 5.9 acres proposed for primary irrigation rights by the transfer.
- 14.6 acres of remaining primary irrigation rights under C #19720.
- 147.3 acres of remaining supplemental irrigation rights under C #19720.
- 12.5 acres of abandoned primary irrigation rights under C #19720 to cancel.
- 17.7 acres of abandoned supplemental irrigation rights under C #19720 to cancel.
- Streams and pond
- Buildings
- Roads

RECEIVED
 JUN 25 2009
 WATER RESOURCES DEPT
 SALEM, OREGON

This map was drawn by Gordon R. Lyford for the Deer Creek Center to support their Water Right Transfer Application to change the POU and POD of irrigation and supplemental irrigation water from Deer Creek. The DCC owns tax lots 100 and 700.

This map was prepared for the purpose of identifying the location of water rights only and is not intended to provide legal dimensions or the location of property ownership lines.

Water Right Transfer Map From Certificate #6067

T 38 S, R 8 W, WM, Josephine County

Portions of Sections 9, 10, and 11

June 20, 2009

Superseded by map received 8/31/09

*6-20-2009
exp 12-31-2010*

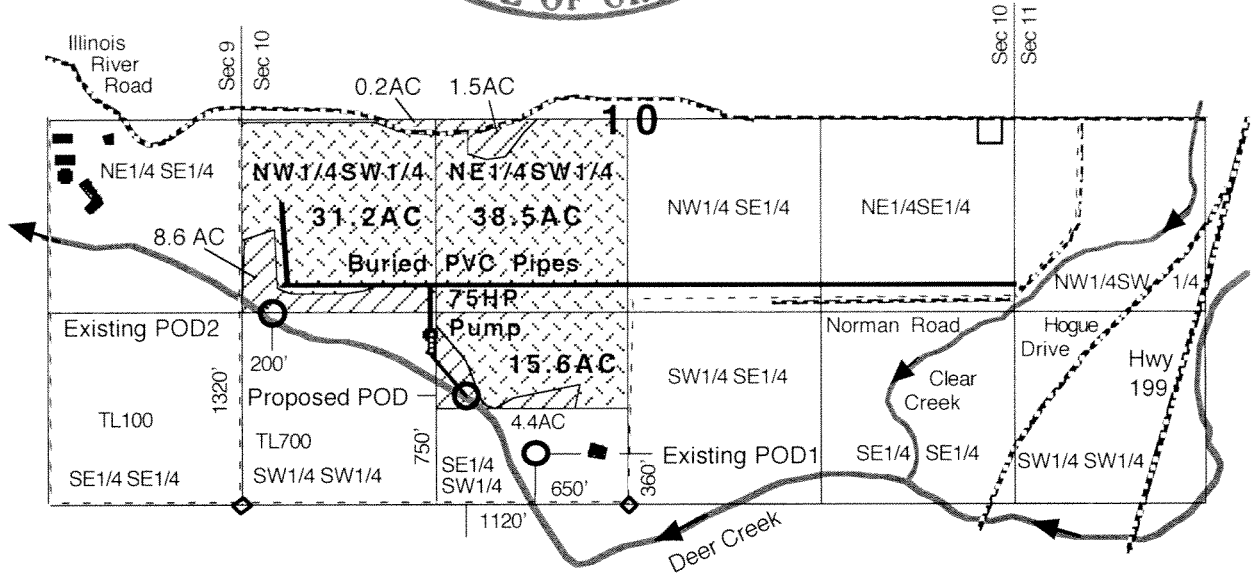
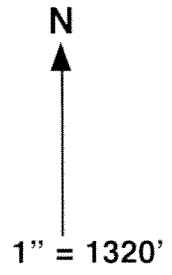
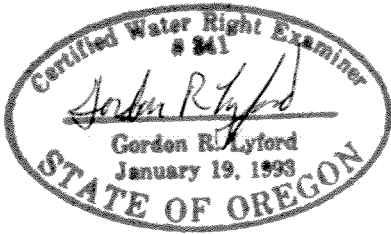

Application S-6480, Permit S-4255, and Certificate #6067 with a priority of April 8, 1919 for irrigation at a rate of 1/80 cfs per acre from Deer Creek.

- Points of Diversion (POD).
Proposed POD located 1120 feet West and 750 feet North from the S1/4 corner of Section 10.
Existing POD1 located 650 feet West and 360 feet North from the S1/4 corner of Section 10.
Existing POD2 located 200 feet East and 1320 feet North from the SW corner of Section 10.

85.3 acres of remaining primary irrigation rights under C #6067.

14.7 acres of abandoned primary irrigation rights under C #6067 to cancel.

Streams and pond

Buildings

Roads

RECEIVED

JUN 25 2009

WATER RESOURCES DEPT
SALEM, OREGON

This map was drawn by Gordon R. Lyford for the Deer Creek Center to support their Water Right Transfer Application to change the POD of irrigation water from Deer Creek. The DCC owns tax lots 100 and 700.

This map was prepared for the purpose of identifying the location of water rights only and is not intended to provide legal dimensions or the location of property ownership lines.

Superseded by map received 10/5/09

Re-Visited Water Right Transfer Map From Certificate #19720
 T 38 S, R 8 W, WM, Josephine County
 Portions of Sections 9, 10, and 11

August 26, 2009

8-26-2009
 Exp 12-31-2010

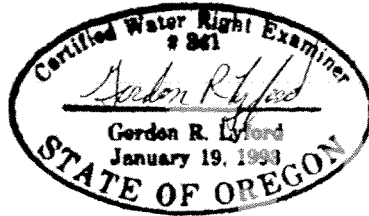

N
 1" = 1320'

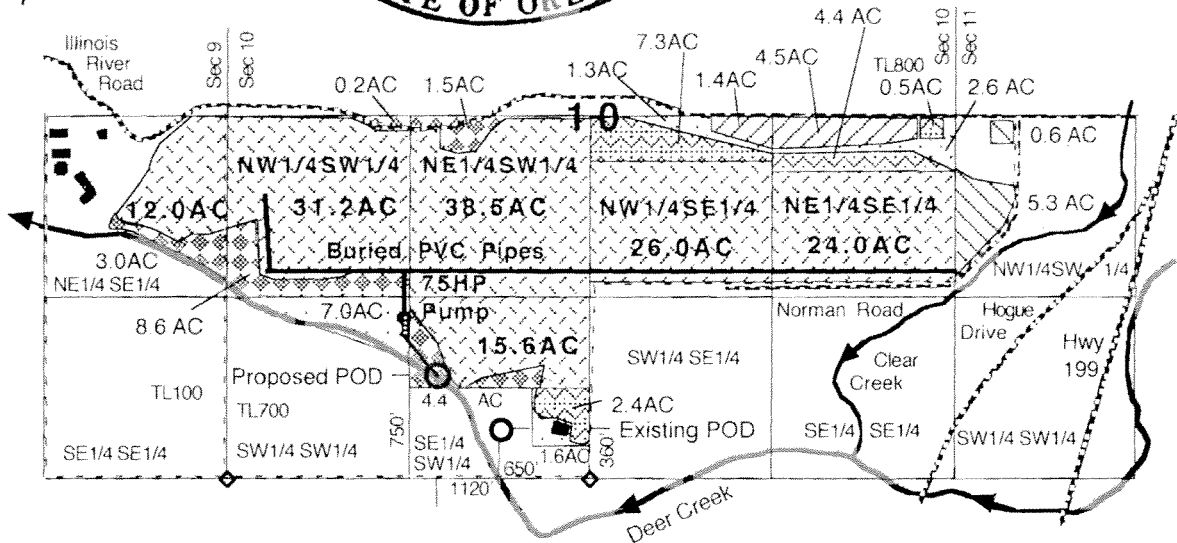

Application S-22760, Permit S-17867, and Certificate #19720 with a priority of August 15, 1947 for irrigation and supplemental irrigation at a rate of 1/50 cfs per acre from Deer Creek.

- Points of Diversion (POD)
 Proposed POD is located 1120 feet West and 750 feet North from the S1/4 corner of Section 10.
 Existing POD is located 650 feet West and 360 feet North from the S1/4 corner of Section 10.
- ✓ [diagonal lines] 5.9 acres of existing primary irrigation rights under C #19720 proposed to change the POU and POD.
- ✓ [diagonal lines] 5.9 acres proposed for primary irrigation rights by the transfer.
- ✓ [cross-hatch] 14.6 acres of primary irrigation rights under C #19720 proposed to change the POD.
- ✓ [dotted] 147.3 acres of supplemental irrigation rights under C #19720 proposed to change the POD.
- ✓ [horizontal lines] 12.5 acres of abandoned primary irrigation rights under C #19720 to cancel.
- ✓ [vertical lines] 17.7 acres of abandoned supplemental irrigation rights under C #19720 to cancel.
- [stippled] Streams and pond
- [solid black] Buildings
- [dashed line] Roads

RECEIVED

AUG 31 2009

WATER RESOURCES DEPT
 SALEM, OREGON

This map was drawn by Gordon R. Lyford for the Deer Creek Center to support their Water Right Transfer Application to change the POU and POD of irrigation and supplemental irrigation water from Deer Creek. The DCC owns tax lots 100 and 700.

This map was prepared for the purpose of identifying the location of water rights only and is not intended to provide legal dimensions or the location of property ownership lines.

RECEIVED

SEP 21 2009

WATER RESOURCES DEPT
 SALEM, OREGON

Superseded by map
received 10/5/09

Re-vised Water Right Transfer Map From Certificate #19720

T 38 S, R 8 W, WM, Josephine County

Portions of Sections 9, 10, and 11

August 26, 2009

8-26-2009
Exp 12-31-2010

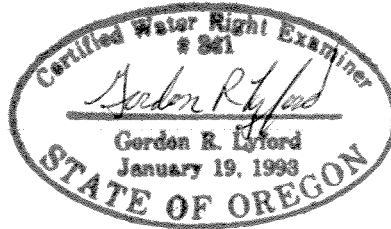

N
1" = 1320'

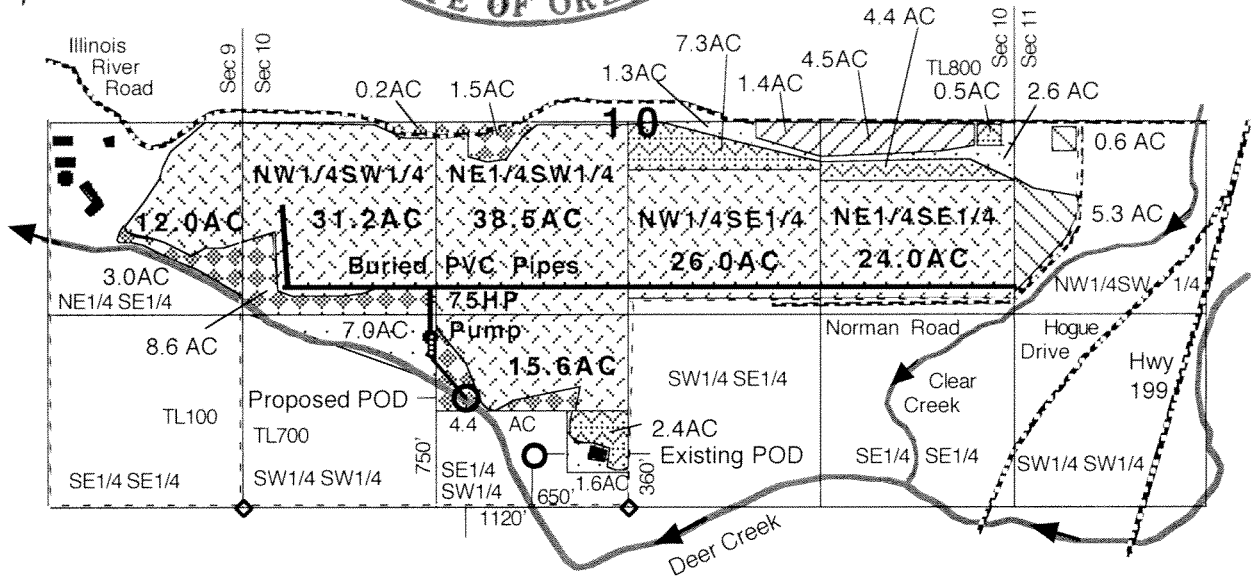

Application S-22760, Permit S-17867, and Certificate #19720 with a priority of August 15, 1947 for irrigation and supplemental irrigation at a rate of 1/50 cfs per acre from Deer Creek.

- Points of Diversion (POD)
Proposed POD is located 1120 feet West and 750 feet North from the S1/4 corner of Section 10.
Existing POD is located 650 feet West and 360 feet North from the S1/4 corner of Section 10.
- 5.9 acres of existing primary irrigation rights under C #19720 proposed to change the POU and POD.
- 5.9 acres proposed for primary irrigation rights by the transfer.
- 14.6 acres of primary irrigation rights under C #19720 proposed to change the POD.
- 147.3 acres of supplemental irrigation rights under C #19720 proposed to change the POD.
- 12.5 acres of abandoned primary irrigation rights under C #19720 to cancel.
- 17.7 acres of abandoned supplemental irrigation rights under C #19720 to cancel.
- Streams and pond
- Buildings
- Roads

RECEIVED

AUG 31 2009

WATER RESOURCES DEPT
SALEM, OREGON

This map was drawn by Gordon R. Lyford for the Deer Creek Center to support their Water Right Transfer Application to change the POU and POD of irrigation and supplemental irrigation water from Deer Creek. The DCC owns tax lots 100 and 700.

This map was prepared for the purpose of identifying the location of water rights only and is not intended to provide legal dimensions or the location of property ownership lines.

Superseded by map received 1/8/10

Revised Water Right Transfer Map From Certificate #6067

T 38 S, R 8 W, WM, Josephine County

Portions of Sections 9, 10, and 11

August 26, 2009

*8-26-2009
exp 12-31-2010*

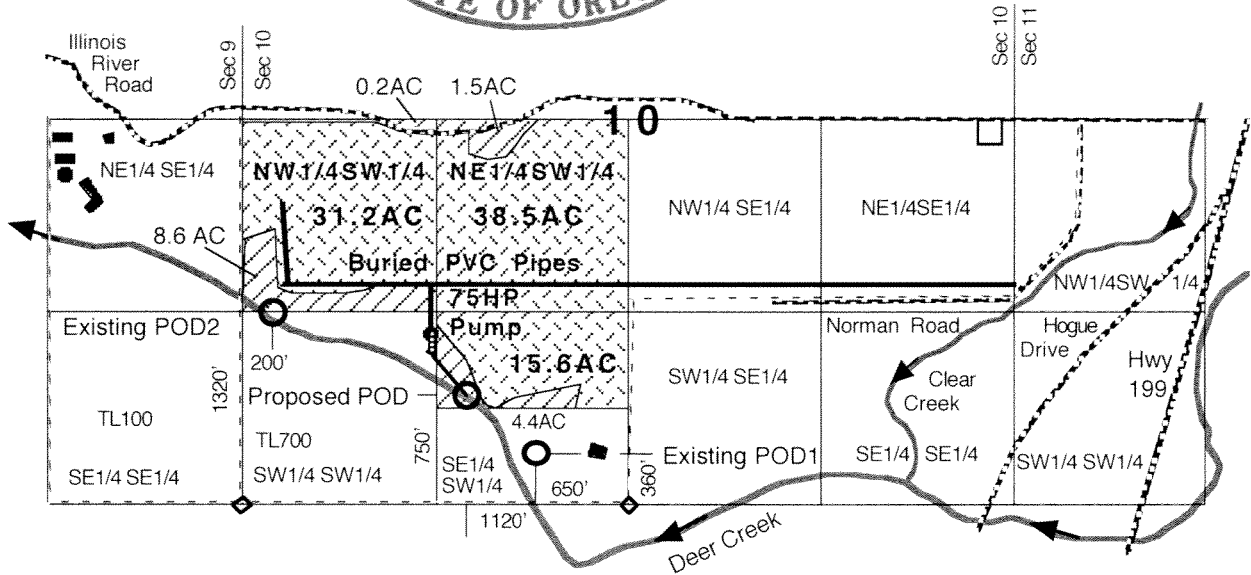
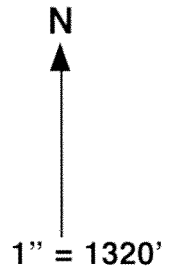
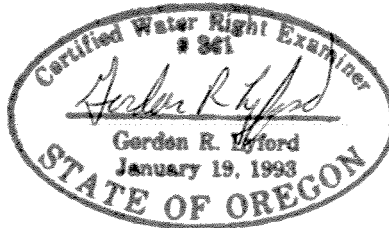

Application S-6480, Permit S-4255, and Certificate #6067 with a priority of April 8, 1919 for irrigation at a rate of 1/80 cfs per acre from Deer Creek.

- Points of Diversion (POD).
Proposed POD located 1120 feet West and 750 feet North from the S1/4 corner of Section 10.
Existing POD1 located 650 feet West and 360 feet North from the S1/4 corner of Section 10.
Existing POD2 located 200 feet East and 1320 feet North from the SW corner of Section 10.

85.3 acres of irrigation rights under C #6067 proposed to change the POD.

14.7 acres of abandoned irrigation rights under C #6067 to cancel.

Streams and pond

Buildings

Roads

RECEIVED

AUG 31 2009

**WATER RESOURCES DEPT
SALEM, OREGON**

This map was drawn by Gordon R. Lyford for the Deer Creek Center to support their Water Right Transfer Application to change the POD of irrigation water from Deer Creek. The DCC owns tax lots 100 and 700.

This map was prepared for the purpose of identifying the location of water rights only and is not intended to provide legal dimensions or the location of property ownership lines.

Water Right Transfer Map From Certificate #13831

T 38 S, R 8 W, WM, Josephine County

Portions of Sections 9, 10, and 11

June 20, 2009

6-20-2009
exp 12-31-2010

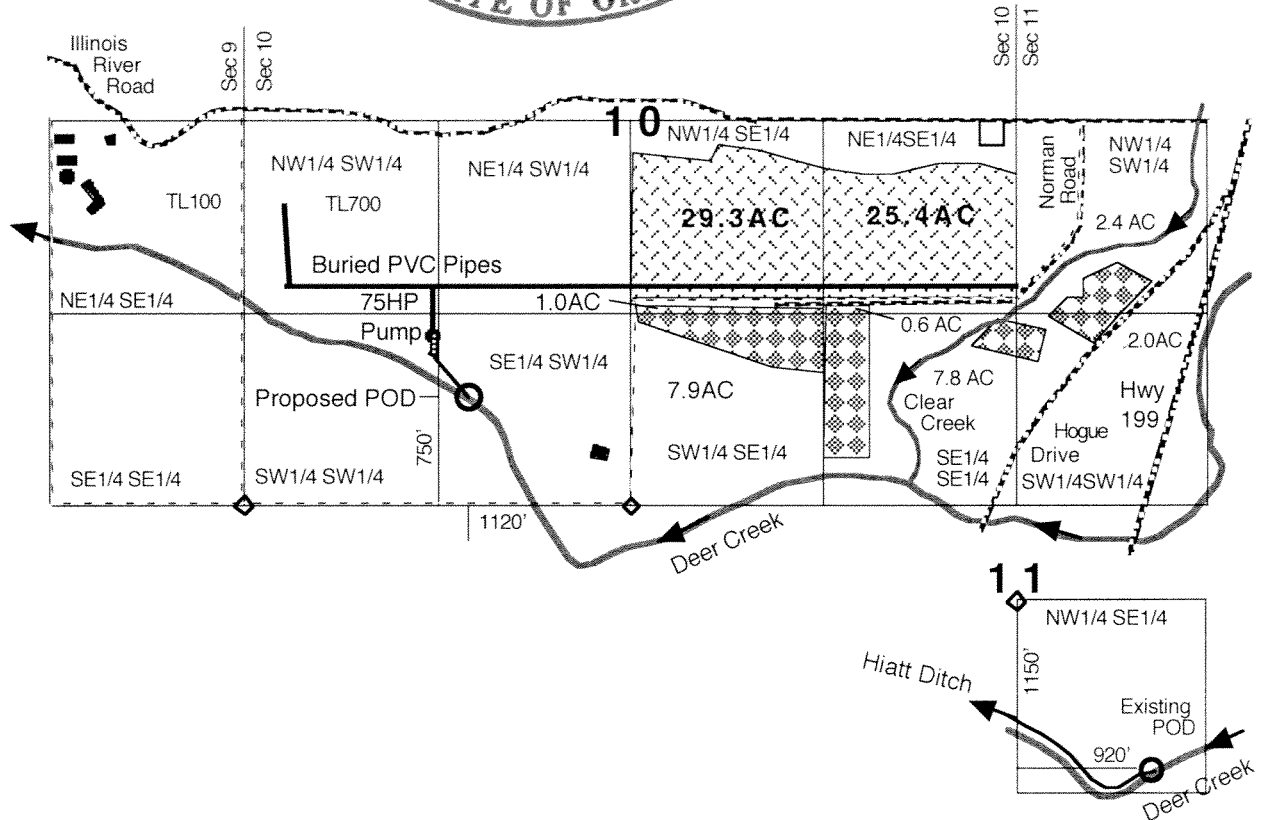
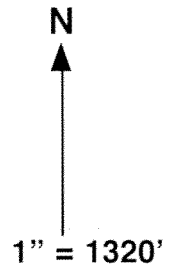
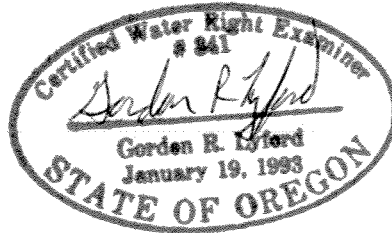

Illinois River Decree and Certificate #13831 with a priority of 1885 for irrigation at a rate of 1/50 cfs per acre from Deer Creek plus an additional 0.0104 cfs per acre with a priority of July 7, 1932.

- Points of Diversion (POD)
Proposed POD located 1120 feet West and 750 feet North from the S1/4 corner of Section 10.
Existing POD located 920 feet East and 1150 feet South from the Center of Section 11.

- 54.7 acres of irrigation rights under C #13831 proposed to change the POD.
- 21.7 acres of remaining irrigation rights under C #13831 not changing the POD.
- Streams and pond
- Buildings
- Roads

RECEIVED

JUN 25 2009

WATER RESOURCES DEPT
SALEM, OREGON

This map was drawn by Gordon R. Lyford for the Deer Creek Center to support their Water Right Transfer Application to change the POD of irrigation water from Deer Creek. The DCC owns tax lots 100 and 700.

This map was prepared for the purpose of identifying the location of water rights only and is not intended to provide legal dimensions or the location of property ownership lines.

Re-Revised Water Right Transfer Map From Certificate #19720
T 38 S, R 8 W, WM, Josephine County
Portions of Sections 9, 10, and 11
 August 26, 2009

8-26-2009
 Exp 12-31-2010

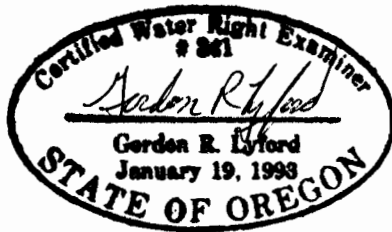

N
 ↑
 1" = 1320'

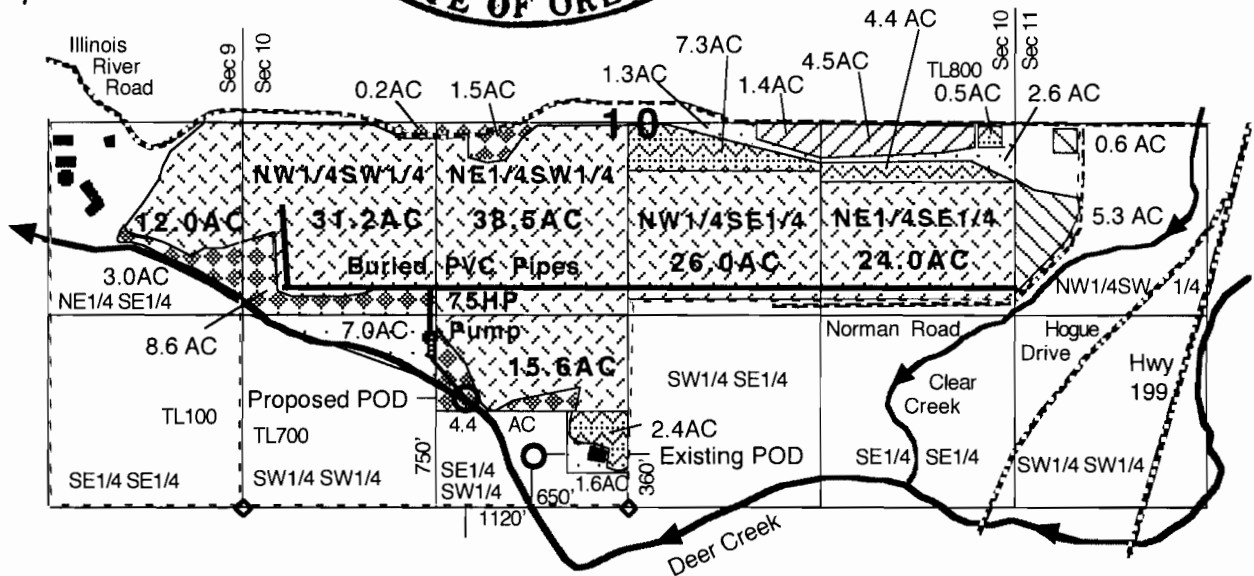

Application S-22760, Permit S-17867, and Certificate #19720 with a priority of August 15, 1947 for irrigation and supplemental irrigation at a rate of 1/50 cfs per acre from Deer Creek.

- Points of Diversion (POD)
 Proposed POD is located 1120 feet West and 750 feet North from the S1/4 corner of Section 10.
 Existing POD is located 650 feet West and 360 feet North from the S1/4 corner of Section 10.
- ▨ 5.9 acres of existing primary irrigation rights under C #19720 proposed to change the POU and POD.
- ▧ 5.9 acres proposed for primary irrigation rights by the transfer.
- ▩ 14.6 acres of primary irrigation rights under C #19720 proposed to change the POD.
- ▦ 147.3 acres of supplemental irrigation rights under C #19720 proposed to change the POD.
- ▤ 12.5 acres of abandoned primary irrigation rights under C #19720 to cancel.
- ▥ 17.7 acres of abandoned supplemental irrigation rights under C #19720 to cancel.
- Streams and pond
- Buildings
- Roads

RECEIVED

AUG 31 2009

**WATER RESOURCES DEPT
 SALEM, OREGON**

This map was drawn by Gordon R. Lyford for the Deer Creek Center to support their Water Right Transfer Application to change the POU and POD of irrigation and supplemental irrigation water from Deer Creek. The DCC owns tax lots 100 and 700.

This map was prepared for the purpose of identifying the location of water rights only and is not intended to provide legal dimensions or the location of property ownership lines.

Revised Water Right Transfer Map From Certificate #6067

T 38 S, R 8 W, WM, Josephine County

Portions of Sections 9, 10, and 11

August 26, 2009

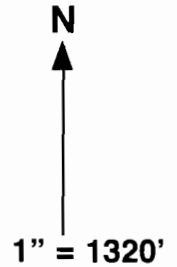

8-26-2009
exp 12-31-2010

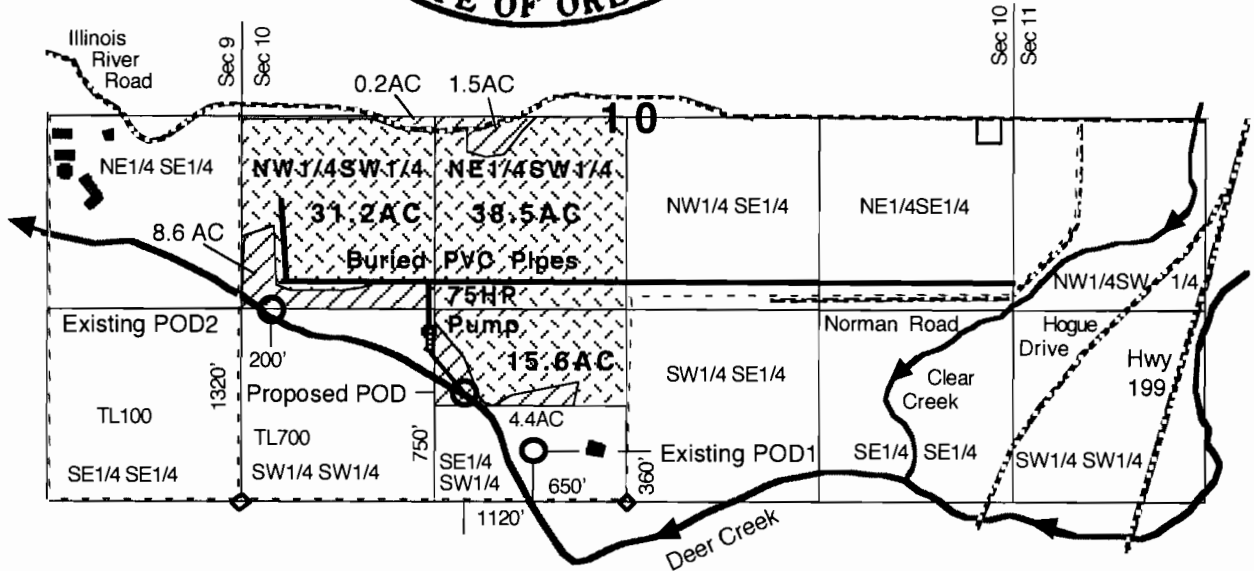
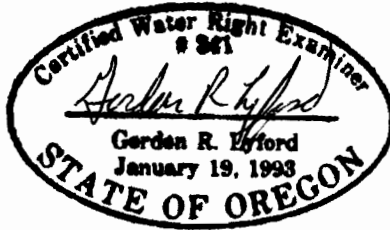

Application S-6480, Permit S-4255, and Certificate #6067 with a priority of April 8, 1919 for irrigation at a rate of 1/80 cfs per acre from Deer Creek.

- Points of Diversion (POD).
Proposed POD located 1120 feet West and 750 feet North from the S1/4 corner of Section 10.
Existing POD1 located 650 feet West and 360 feet North from the S1/4 corner of Section 10.
Existing POD2 located 200 feet East and 1320 feet North from the SW corner of Section 10.

- 85.3 acres of irrigation rights under C #6067 proposed to change the POD.
- 14.7 acres of abandoned irrigation rights under C #6067 to cancel.
- Streams and pond
- Buildings
- Roads

RECEIVED

AUG 31 2009

**WATER RESOURCES DEPT
SALEM, OREGON**

This map was drawn by Gordon R. Lyford for the Deer Creek Center to support their Water Right Transfer Application to change the POD of irrigation water from Deer Creek. The DCC owns tax lots 100 and 700.

This map was prepared for the purpose of identifying the location of water rights only and is not intended to provide legal dimensions or the location of property ownership lines.