

# Wilson Family Ranches LLC Water Right Transfer Cover Map

This map is for the purpose of identifying the water right location only and is not intended to provide legal dimensions or location of property ownership lines.

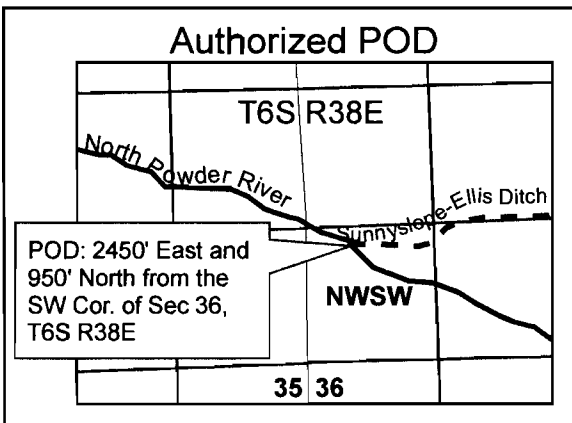
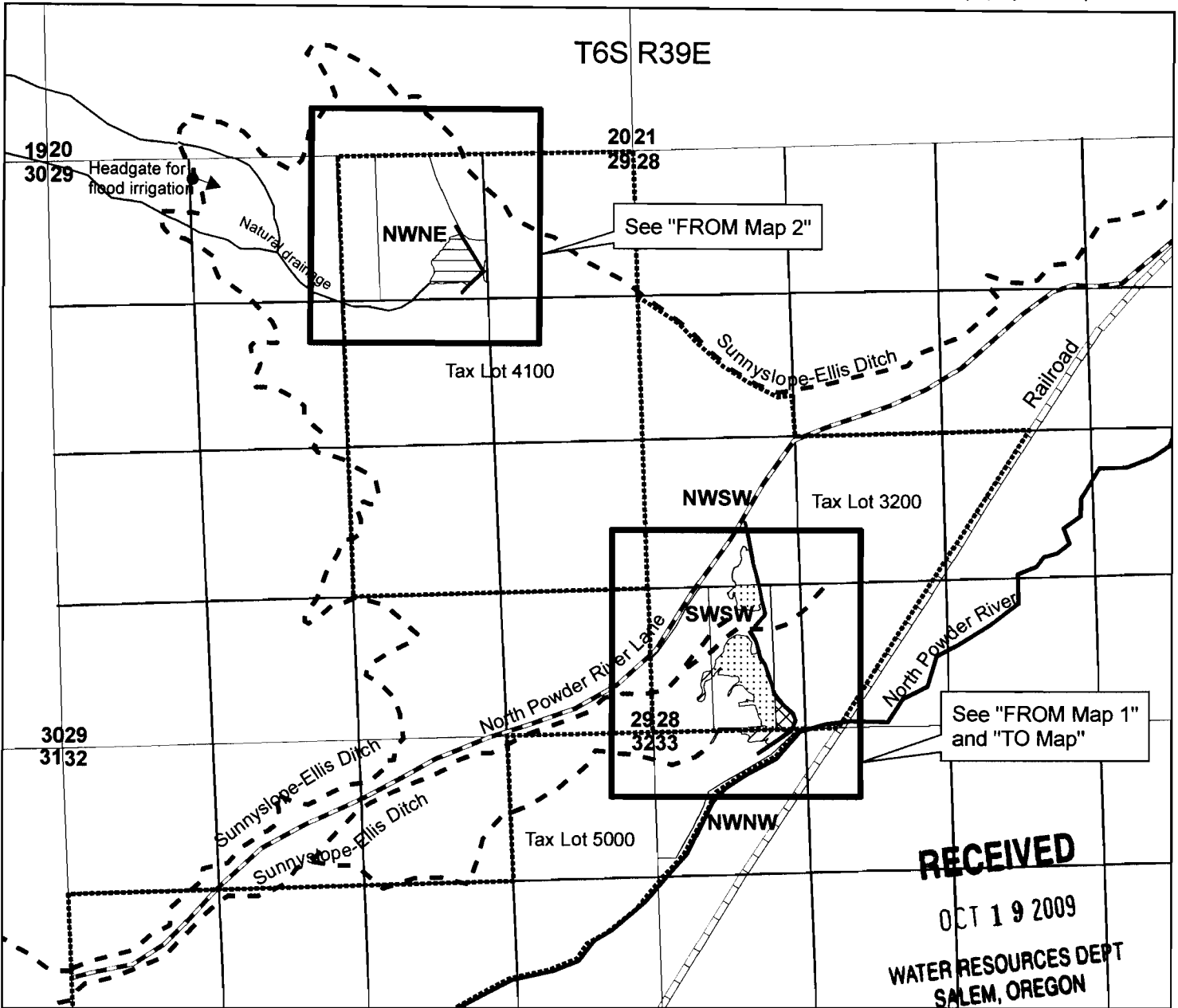

T 10967

- Irrigation Ditch
- +— Road
- +—+— Railroad
- ..... Tax Lot Boundary
- River

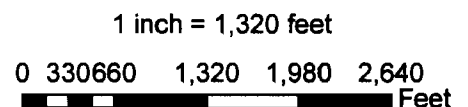
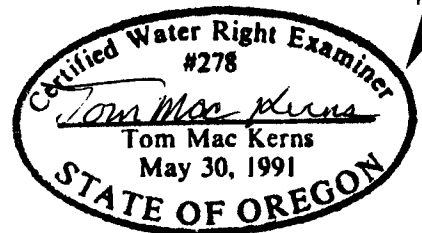

JEM 10/6/09

**Wilson Family Ranches LLC  
Water Right Transfer  
"FROM Map 1"**

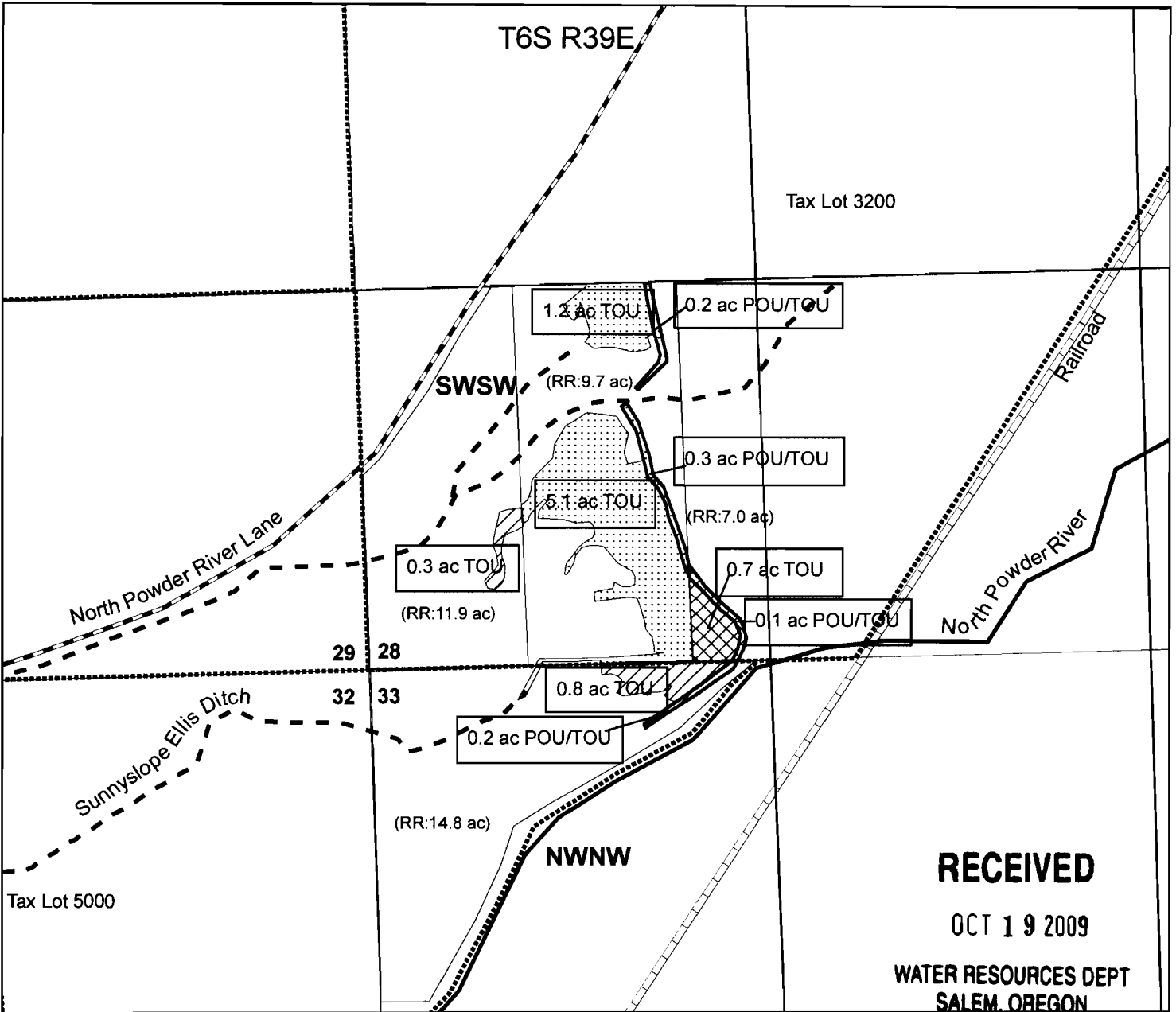



**RECEIVED**

OCT 19 2009





WATER RESOURCES DEPT  
SALEM, OREGON

Note: Prior 3111 certification #'s - transfer in progress - see 3111

-  C-64219, 1904 (1.3 acres total)
-  C-64971, 1905 (6.8 acres total)
-  C-1317, 4/22/1912 (0.8 acres total)

RR = Remaining Right

POU = Place of Use Change  
TOU = Character of Use Change

-  Irrigation Ditch
-  Road
-  Railroad
-  Tax Lot Boundary
-  River

1 inch = 500 feet  
0 125 250 500 750 1,000 Feet

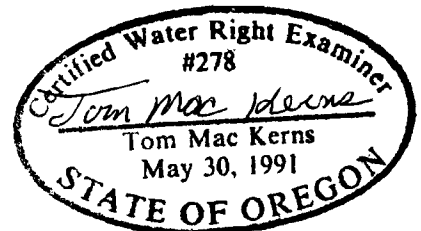

T 10967

JEM 10/6/09

This map is for the purpose of identifying the water right location only and is not intended to provide legal dimensions or location of property ownership lines.

Wilson Family Ranches LLC  
Water Right Transfer  
"FROM Map 2"

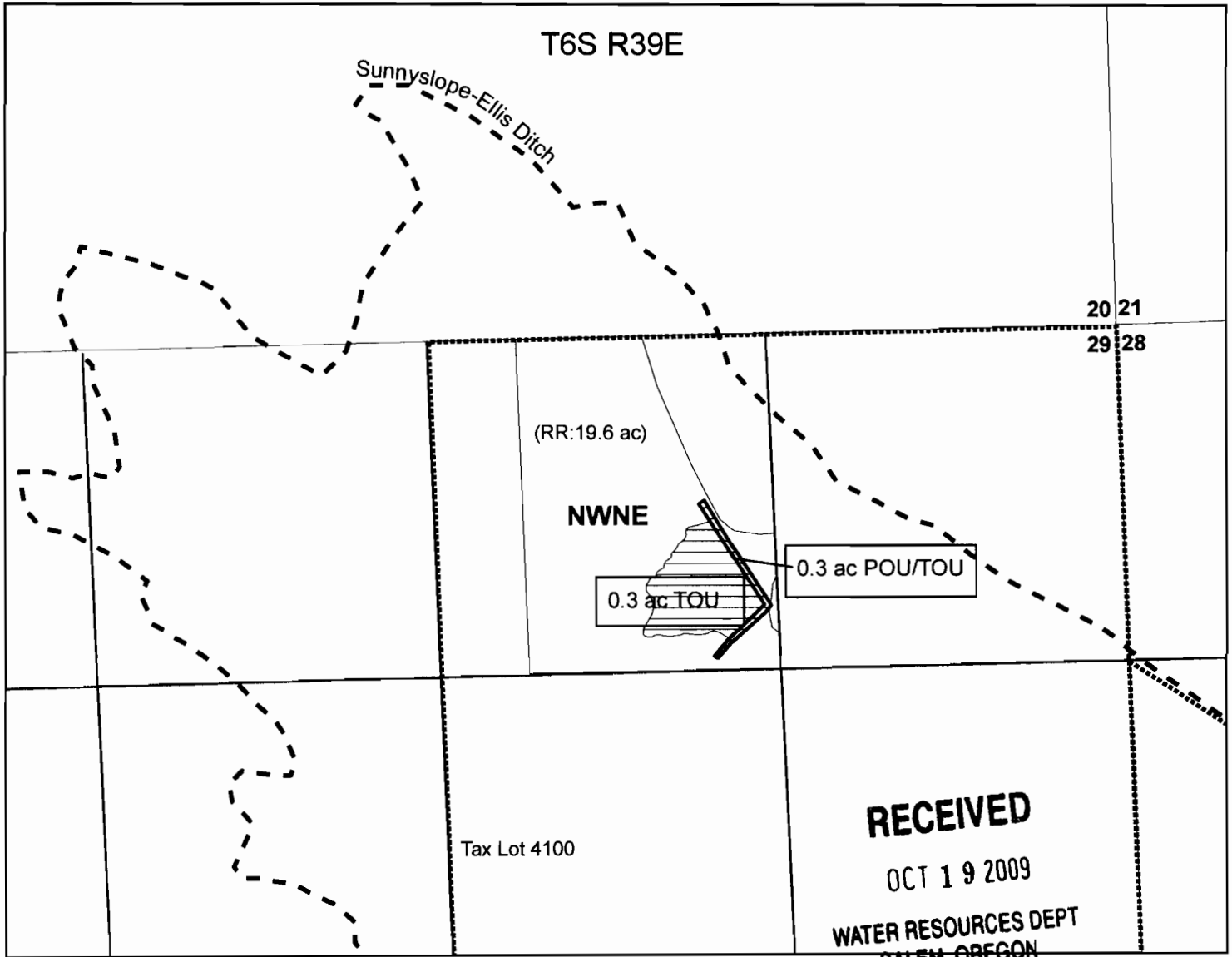

**RECEIVED**  
OCT 19 2009  
WATER RESOURCES DEPT  
SALEM, OREGON

1 inch = 600 feet

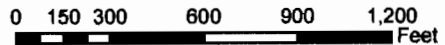

- - - Irrigation Ditch
- ..... Tax Lot Boundary

Note: Prior 3111 certificate #'s - transfer in progress - see 3111

C-64219, 1898 (3.3 acres total)

RR = Remaining Right

POU = Place of Use Change

TOU = Character of Use Change

T 10967

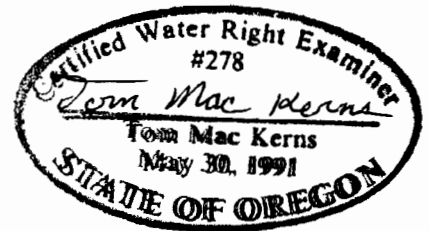





This map is for the purpose of identifying the water right location only and is not intended to provide legal dimensions or location of property ownership lines.

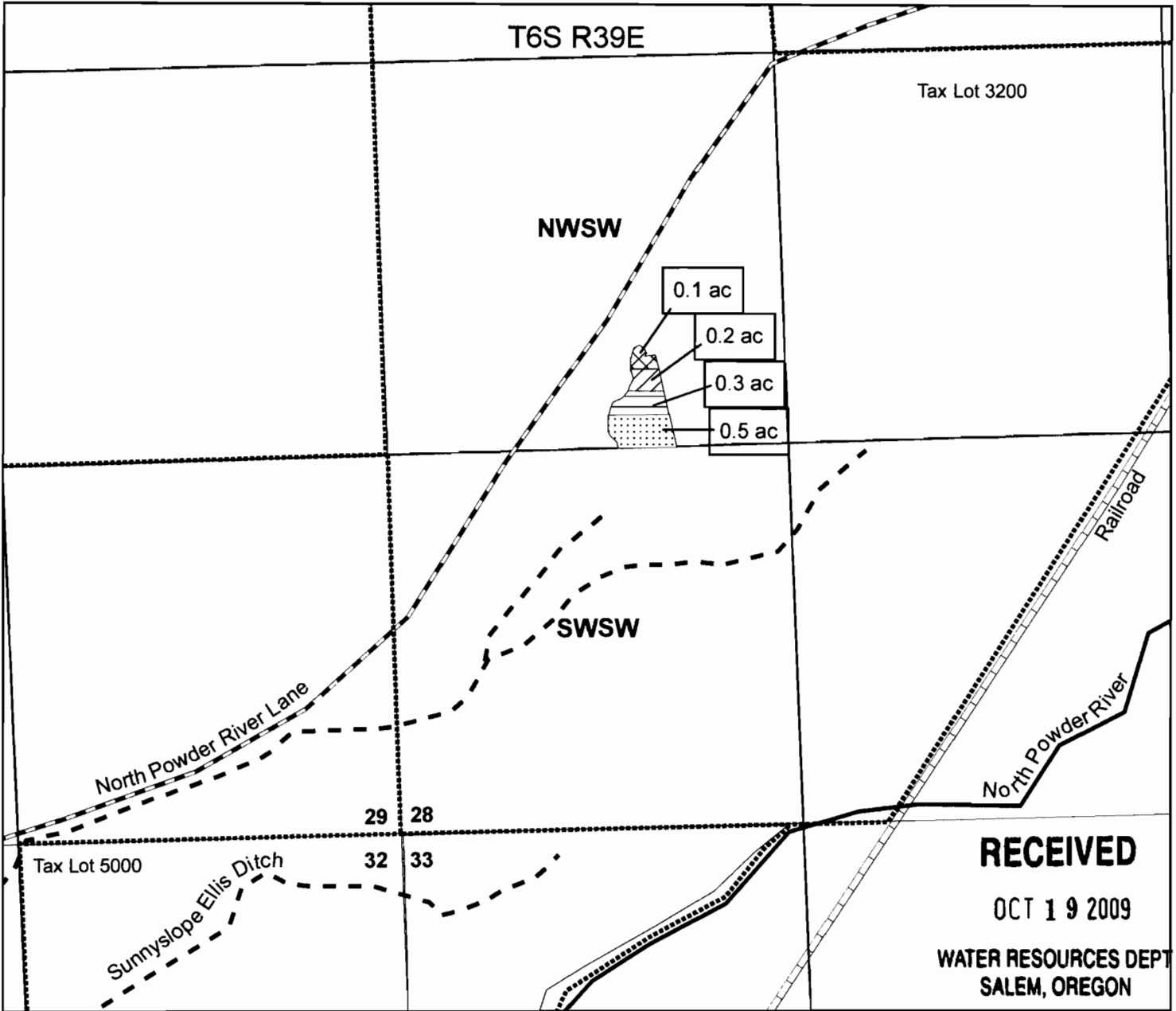



JEM 10/6/09

Wilson Family Ranches LLC  
Water Right Transfer  
"TO Map"



Note: Prior 3111 certification #'s - transfer in progress - see 3111

-  C-64219, 1904 (0.2 acres)
-  C-64971, 1905 (0.5 acres)
-  C-1317, 4/22/1912 (0.1 acres)
-  C-64219, 1898 (0.3 acres)

-  Irrigation Ditch
-  Road
-  Railroad
-  Tax Lot Boundary
-  River

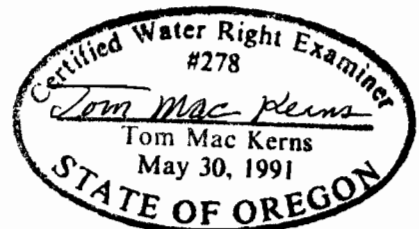
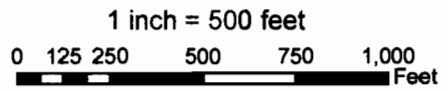

This map is for the purpose of identifying the water right location only and is not intended to provide legal dimensions or location of property lines.

JEM 10/16/09

T 10967