

INSTREAM TRANSFER  
Water Rights Application Map  
for  
Kellogg Kin, Inc.  
2132 Sardine Creek Road  
Gold Hill, Oregon 97525

Assessor's Map No. 363W04-500, 800  
T. 36 S., R3W., SECTION 4, W.M.

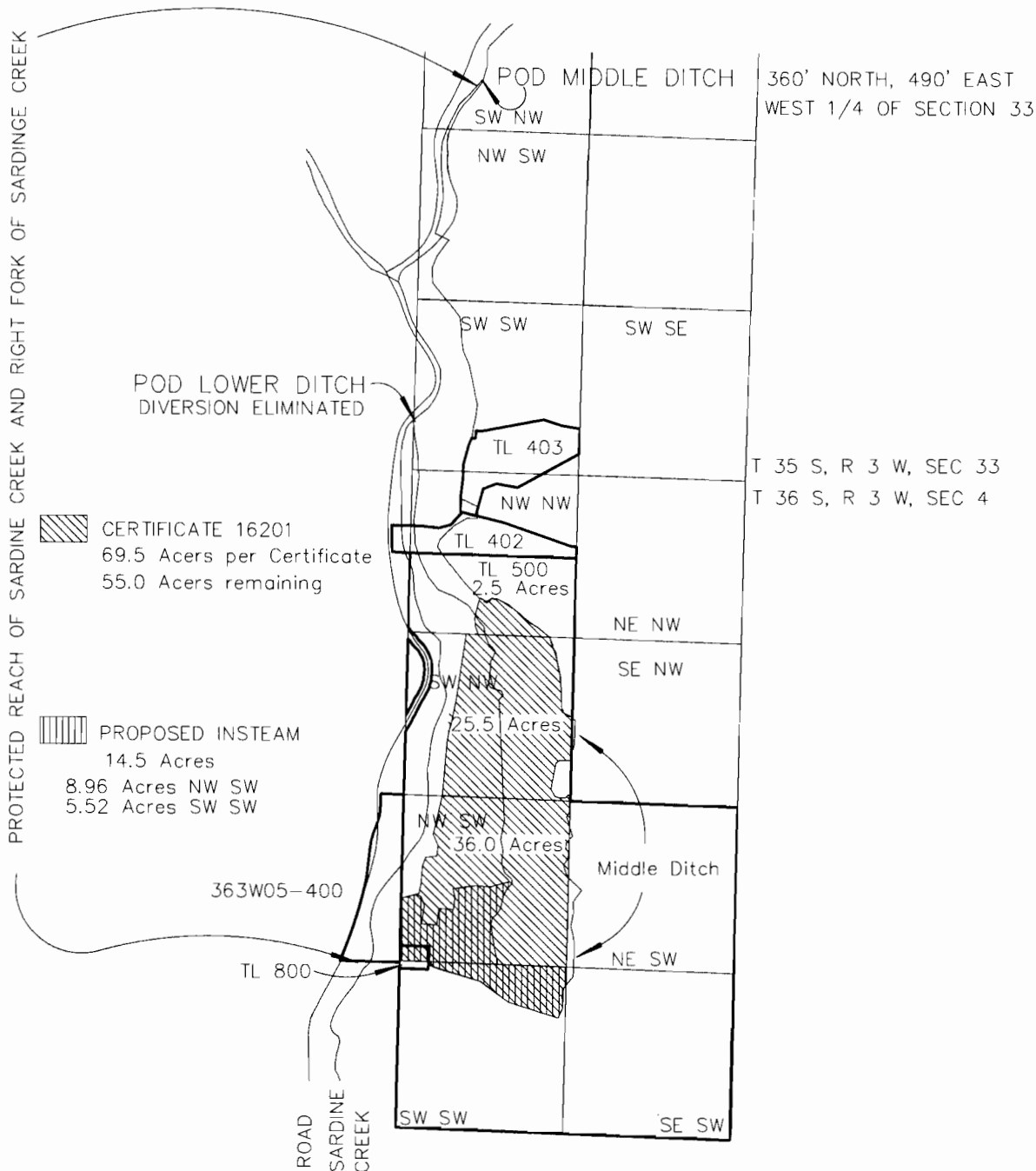

Notes:

These applications will take 14.5 acres of lands irrigated under Certificate 16201 and transfer them instream with a protected reach from the POD for the middle ditch past the southerly irrigated land owned by Kellogg Kin, Inc. This is in mitigation for the ground water right of 8.2 acres. There are no other diversions for any rights within this reach.

**T 10978**

PREPARED BY:  
HERBERT A FARBER  
FARBER & SONS, INC.  
d.b.a., FARBER SURVEYING  
PO Box 5286  
431 Oak Street  
Central Point, Oregon, 97501  
541-776-0846

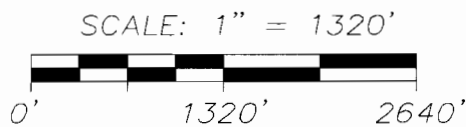
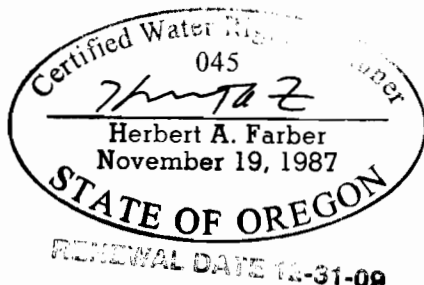

DATE: November 12, 2009

NOTE: MAP PREPARED FOR WATER RIGHTS PURPOSES ONLY  
NOT FOR PROPERTY BOUNDARY LOCATIONS.

NOV 17 2009

HERBERT A. FARBER  
FARBER SURVEYING