

STATE ENGINEER  
Salem, Oregon

# Well Record

STATE WELL NO. 2/4-4D  
COUNTY Clackamas  
APPLICATION NO. GR-1490

**CLAC**  
**C5476**

GR-1440

OWNER: H. C. Compton

MAILING ADDRESS: Rt. 1, Box 57

LOCATION OF WELL: Owner's No. \_\_\_\_\_

CITY AND STATE: Boring, Oregon

NW 1/4 NW 1/4 Sec. 4 T. 2 S. R. 4 W., W.M.

Bearing and distance from section or subdivision corner 400' E. & 300' S. from NW cor. Sec. 4

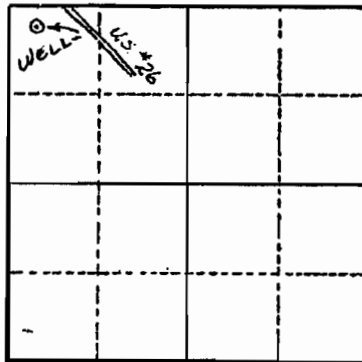

Section 4

Altitude at well 600'

TYPE OF WELL: Drilled Date Constructed 1939

Depth drilled 246' Depth cased 246'

### CASING RECORD:

- 10" from 0 to 70'
- 8" from 70' to 185'
- 6" from 185' to 246'

### FINISH:

Perforated from 185' to 220' & from 145' to 150'

### AQUIFERS:

### WATER LEVEL:

70'

PUMPING EQUIPMENT: Type Jacuzzi turbine H.P. 15  
Capacity 150 G.P.M.

### WELL TESTS:

Drawdown 70 ft. after \_\_\_\_\_ hours 150 G.P.M.  
 Drawdown \_\_\_\_\_ ft. after \_\_\_\_\_ hours \_\_\_\_\_ G.P.M.

USE OF WATER Irrigation Temp. \_\_\_\_\_ °F. \_\_\_\_\_, 19

SOURCE OF INFORMATION GR Record

DRILLER or DIGGER Beaverton Drilling Co.

### ADDITIONAL DATA:

Log \_\_\_\_\_ Water Level Measurements \_\_\_\_\_ Chemical Analysis \_\_\_\_\_ Aquifer Test \_\_\_\_\_

### REMARKS:

- Log: Clay 0 to 70 ft.
- Rock (basalt) 70 to 145 ft.
- Gravel 145 to 148 ft.
- Rock (blue basalt) 148 to 185 ft.
- Light gray gumbo clay 185 to 195 ft.
- Soft rotten conglomerate 195 to 206 ft.
- Fine sand 206 to 220 ft.
- Blue clay 220 to 246 ft.

Irrigation of 20 acres.

T 10988

150 14 2009