

APPLICATION FOR TRANSFER CHANGE IN POINT OF DIVERSION AND CLARIFICATION OF RIGHT LOCATION

RECEIVED

FEB 24 2010

CERTIFICATE 79477

TOWNSHIP 23 SOUTH, RANGE 7 WEST, W.M.

WATER RESOURCES DEPT
SALEM, OREGON

DOUGLAS COUNTY, OREGON

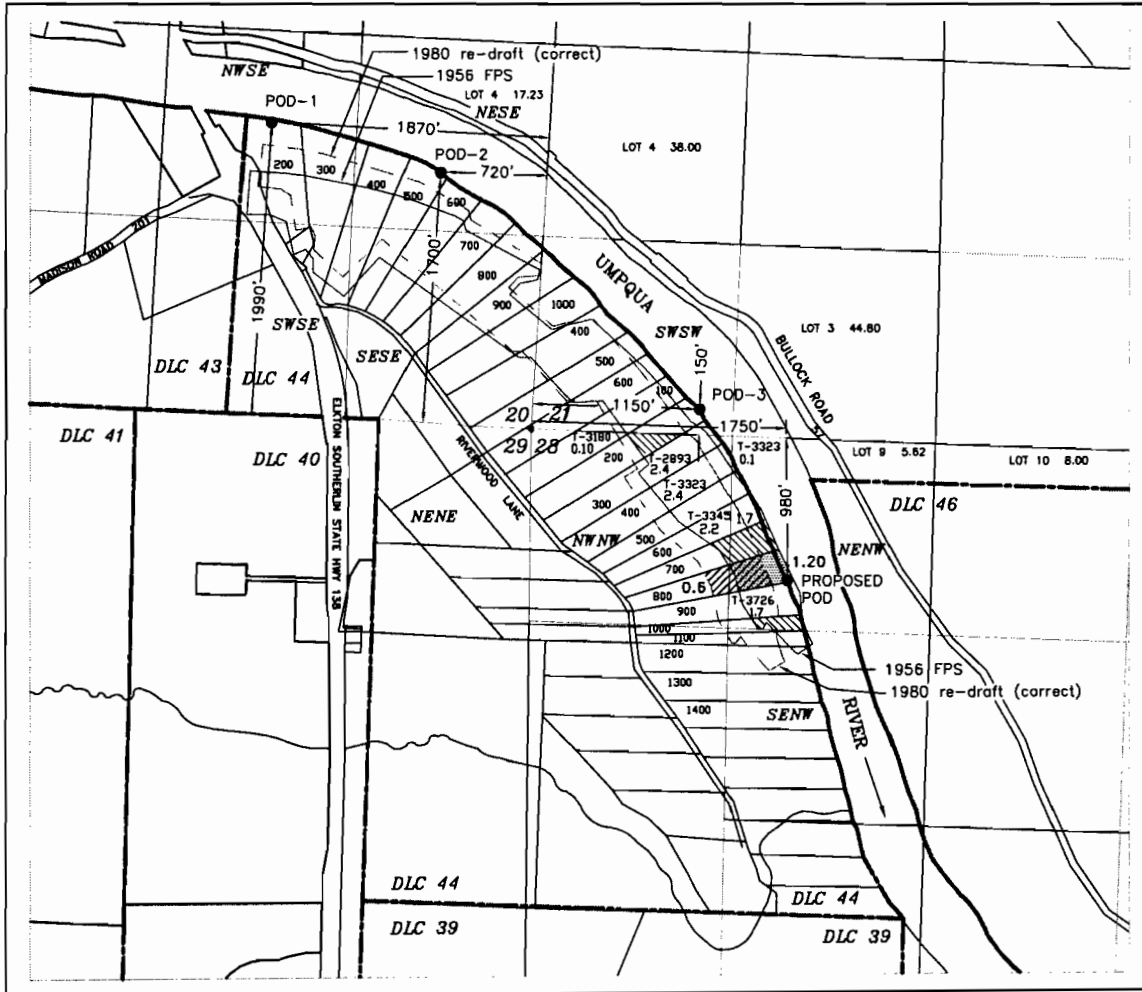

APPLICANT: Vicky S. Newfield
601 Davis Place
Mt. Shasta, CA 96067

CERTIFICATE 79477 - APPLICATION 25701 - PERMIT 20139



Location of water right under this transfer application per 7/1/1956 FPS Map, 1.80 Ac., NENW (FPS map is incorrect)

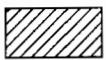

Actual location of land to be irrigated by proposed POD 1.2 NENW 0.6 NWNW = 1.80 Ac. Per non-official Department corrected 1980 map and site observations.



Remaining Right
1.90 Ac. NENW Sec. 28*
1.10 Ac. NWNW Sec. 28*

Base map - Douglas County GIS with 1980 corrected Final Proof Map overlay and 2005 FSA aerial photo overlay

* Per 7/1/1956 Final Proof Survey Map (C.O. Bartels) less previous transfers and this transfer application

NOTE: Certificate was not corrected to match re-drafted (1980, L. Toll) Final Proof Survey Map (1980 non-official re-draft is correct - 1956 FPS map is incorrect)

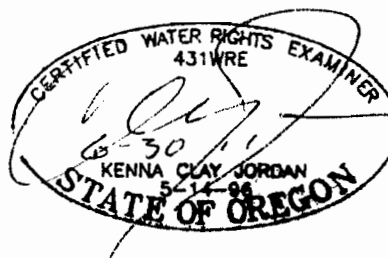

Scale

1" = 1320'

JORDAN ENGINEERING
460 JORDAN LANE
ROSEBURG, OR 97471
(541) 673-1931

Revised 1/29/2010 n.e.d.
2-5-10 KCJ

This map is not intended to provide legal dimensions or locations of property ownership lines