

RECEIVED

MAR 16 2010



Oregon Water Resources Department
725 Summer Street NE, Suite A
Salem Oregon 97301-1266
(503) 986-0900
www.wrd.state.or.us

Application for
Permit Amendment
or Ground Water
Registration Modification

Please type or print legibly in dark ink. If your application is incomplete or inaccurate, we will return it to you. If any requested information does not apply to your application, insert "N/A" to indicate Not Applicable. As you complete this form, please refer to notes and guidance included on the application. A summary of review criteria and procedures that are generally applicable to these applications is available at www.wrd.state.or.us/OWRD/PUBS/forms.shtml.

1. TYPE OF APPLICATION

Please check one of the following:

- Permit Amendment (checked)
Ground Water Registration Modification

2. APPLICANT INFORMATION

Name: MHC Mt. Hood Village, LLC c/o Scott R. Brown
First Last

Address: 8700 E. University

Mesa AZ 85207
City State Zip

Phone: 480-373-5720
Home Work Other

Fax: 480-373-5770 E-Mail address: scott_brown@equitylifestyle.com

3. AGENT INFORMATION

(The agent listed is authorized to represent the applicant in all matters relating to this application.)

Name: Newton Consultants, Inc. c/o James B. Newton
First Last

Address: 521 SW 6th Street, Suite100

Redmond OR 97756
City State Zip

Phone: 541-504-9960 ext. 235
Home Work Other

Fax: 541-504-9961 E-Mail address: jnewton@newtonconsultants.com

- If an agent is listed above, please check one of the following:
Please send all correspondence to Agent. Send copies of correspondence to Applicant; or
Please send all correspondence to Applicant. Send copies of correspondence to Agent. (checked)

T 11030

MAR 16 2010

WATER BUREAU OF GLENN
SALEM, OREGON

Permit Amendments

- *If you propose to amend multiple permits under this application, a separate set of pages 3 through 7 must be provided for each permit. (NOTE: Concurrent changes to a water right must be filed separately on a transfer application.)*

Ground Water Registration Modifications

- *You may propose modification of only one ground water registration per application, unless in accordance with OAR 690-382-0300(2), the ground water registrations to be modified are layered. (NOTE: Concurrent changes to a water right must be filed separately on a transfer application.)*

4. TYPE OF AMENDMENT OR MODIFICATION PROPOSED

Please check **all** of the following that apply:

Point of Diversion or Appropriation	Place of Use	Character of Use
<p><input type="checkbox"/> Change (The old point of diversion or appropriation will not be used for the portion of the water right affected by the amendment or modification.)</p> <p><input checked="" type="checkbox"/> Additional (Both the old and new points of diversion or appropriation will be used for the portion of the water right affected by the amendment or modification.)</p> <p style="text-align: center;"><i>Not Available for <u>Ground Water Registrations</u></i></p> <p><input type="checkbox"/> Surface Water to Ground Water (A new point of appropriation will be used instead of the old point of diversion. The old point of diversion will not be used.)</p>	<p><input type="checkbox"/> All of the Permit or Registration will be exercised at a different location than currently authorized (Use of water at the current authorized location will be discontinued.)</p> <p><input checked="" type="checkbox"/> Only a portion of the Permit or Registration will be exercised at a different location than currently authorized (Use of water at a <u>portion</u> of the current authorized location will be discontinued.)</p>	<p style="text-align: center;"><i>Not Available for <u>Permit Amendments</u></i></p> <p>Change existing authorized use to the following proposed <u>new</u> use:</p> <p><input type="checkbox"/> Irrigation</p> <p><input type="checkbox"/> Municipal</p> <p><input type="checkbox"/> Quasi-municipal</p> <p><input type="checkbox"/> Commercial</p> <p><input type="checkbox"/> Industrial</p> <p><input type="checkbox"/> Domestic (indicate number of households): _____</p> <p><input type="checkbox"/> Other _____</p>

Reason(s) for amendment/modification(s): Amend the place of use to correct inaccuracies in the authorized POU area when permit G-12941 was issued. Add two new POA well locations under the existing permit G-12941 to provide additional flexibility in the operation of the water system while meeting the fire flow requirements by the local Fire Marshall.

T 11030

RECEIVED

MAR 16 2010

WATER RESOURCES DIV
SALEM, OREGON

5. CURRENT PERMIT OR REGISTRATION INFORMATION

Permit or Registration to be Amended/Modified (check and complete one of the following):

<input checked="" type="checkbox"/> Permit to be Amended:	<u>G-12941</u> Permit Number	<u>10/1/2017</u> Current Completion Date of Permit
<input type="checkbox"/> Ground Water Registration to be Modified:	_____ Ground Water Registration Number	<i>NOTE: Concurrent changes to a water right must be filed separately on a transfer application.</i>

▪ Name on Permit or Registration: MHC Mount Hood Village LLC, c/o Scott Brown

▪ County: Clackamas

▪ Authorized Use(s) to be affected by this Amendment/Modification: _____
Human Consumption only for 650 Households

▪ Priority Date(s): June 16, 1994 for 0.163 cfs and April 13, 1995 for 0.015 cfs

If there are multiple Priority Dates identified on the Permit or Registration, any information provided on pages 4 through 7 must identify which priority date is associated with each of the authorized and proposed points of diversion or appropriation and places of use.

▪ All Source(s) of Water to be affected by this Amendment/Modification: _____
Two existing wells and two proposed wells in the Salmon River Basin

Tributary to: Salmon River

If there are multiple Sources listed on the Permit or Registration, any information provided on pages 4 through 7 must identify which source is associated with each of the authorized and proposed points of diversion or appropriation and places of use.

For an application proposing a Change in Place of Use or Character of Use:

▪ Are there any other "Layered" Water Rights, Permits, or Ground Water Registrations issued for Irrigation purposes that are appurtenant to the same place of use as the Permit or Registration being Amended/Modified? Yes No N/A -No Change in Use or Place of Use

If "Yes", pursuant to ORS 540.510, OAR 690-380-2240 and OAR 690-382-0200, the other "layered" water uses subject to transfer must either change concurrently or be cancelled, except as provided in OAR 690-380-2240(5).

▪ Remarks: Place of use is being amended from what is described in the permit (G-12941)
to the actual place of use and two new additional well locations are being added as authorized
POAs.

1 11030

MAR 16 2010

WATER RESOURCES DEPT
SALEM, OREGON

The following information must be provided only for those points of diversion or appropriation that are involved in the permit amendment or ground water registration modification (i.e., list only the portion of the permit/registration you propose to amend/modify.) Attach additional pages as necessary.

Government lot and donation land claim numbers must be included in the tables below only if the information is reflected on the existing permit or ground water registration.

Location of Existing Authorized Point(s) of Diversion or Appropriation to be Changed:

(i.e., the allowed point(s) of diversion/appropriation that will be affected by the proposed amendment/modification or the authorized point(s) of diversion or appropriation that serves the lands being transferred, if applicable)

If Ground Water, OWRD Well Log ID No. (or Well ID Tag No. L-)	Source and Priority Date	Township	Range	Mer	Sec	¼ ¼	Tax Lot, DLC or Gov't Lot	Survey Coordinates (coordinates from a recognized survey corner)
CLAC 7590	Groundwater June 16, 1994	2S	7E	WM	31	SE NW	Tax Lot 304	75 Feet South and 650 Feet West from the Center North 1/16 of Section 31
CLAC 7588	Groundwater April 13, 1995	2S	7E	WM	31	SE NW	Tax Lot 304	350 Feet South and 600 Feet West from the Center North 1/16 of Section 31

- Does the permit/registration being amended/modified involve a ground water source(s)?
 Yes No (Surface water source only.)

If "Yes", for each authorized point of appropriation (well) involved, you must either:

A. Supply a copy of the well log(s) for each point of appropriation that is clearly labeled and associated with the corresponding well in the table above and on the accompanying application map.

(NOTE: You may search for well logs on the Department's website at: www.wrd.state.or.us)

or

B. If a well log is not available, you must describe the construction of the authorized point of appropriation by completing the table below. Attach additional copies as necessary.

Construction of Existing Authorized Point(s) of Appropriation – (Only needed if no well log is available.)

Wells in this listing must be clearly tied to corresponding well location(s) described in the table above and shown on the accompanying application map.

OWRD Well No. as identified in table above	Diameter	Type and size of casing	No. of feet of casing	Intervals casing is perforated (in feet)	Seal depth	Est. depth to water	Est. depth to water bearing stratum	Type of access port or measuring device	Total well depth
See attached well logs. (CLAC 7590 and CLAC 7588)									

1 11030

RECEIVED

MAR 16 2010

WATER RESOURCES UNIT

Will the ENTIRE permit or ground water registration be affected by this amendment/modification?

Yes **No**

If **“Yes”**, the remainder of this page does not need to be completed. Go on to the next page.

If **“No”**, the following information must be provided only for those places of use that are involved in the amendment/modification (i.e., list only the portion of the permit or ground water registration to be affected by the amendment/modification.) Attach additional pages as necessary.

Government lot and donation land claim numbers must be included in the tables below **only** if the information is reflected on the existing permit or ground water registration.

Location of Existing Authorized Place of Use to be Affected:

(i.e., the allowed lands that will be affected by the proposed amendment/modification, the “FROM” lands)

Source and Priority Date	Township	Range	Mer	Sec	¼ ¼ Section	Tax Lot, DLC or Gov't Lot	Acres (if applicable)

T 11030

MAR 16 2010

WATER RESOURCES DEPT

6. PROPOSED PERMIT AMENDMENT OR REGISTRATION MODIFICATION

- Describe proposed changes to the permit or registration involving point(s) of diversion and/or appropriation. Survey coordinates described below should accurately correspond to the points shown on the accompanying application map. Attach additional pages as necessary.

Location of Proposed Point(s) of Diversion or Appropriation: (i.e., the "TO" point(s) of diversion/appropriation)

(NOTE: Complete this table only if a Change in Point of Diversion or Appropriation is being proposed.)

Source	Township	Range	Mer	Sec	¼ ¼ Section	Tax Lot, DLC or Gov't Lot	Survey Coordinates (coordinates from a recognized survey corner)
Groundwater	2S	7E	WM	31	SE NW	TL 304	Well #1-1 – 87 Feet South and 680 Feet West from the Center North 1/16 of Section 31
Groundwater	2S	7E	WM	31	SE NW	TL 304	Well #2-1 – 336 Feet South and 626 Feet West from the Center North 1/16 of Section 31

- If there are proposed point(s) of appropriation (wells) listed in the table above, are the well(s) already constructed? Yes No N/A - No proposed well(s) listed above.

If "Yes", attach and **clearly label** the corresponding well log(s) for each proposed well, or if well log(s) are **not** available, describe the construction of the well(s) using the table below.

(NOTE: You may search for well logs on the Department's website at: www.wrd.state.or.us)

If "No", describe the anticipated construction for the proposed well(s) in the following table:

Construction of Proposed Point(s) of Appropriation or Well(s):

Well numbers in this listing must be clearly tied to corresponding well location(s) described in the table above and shown on the accompanying application map.

Well already built? (Yes/No)	If an existing well, OWRD Well Log ID No. (or Well ID Tag No. L-)	Diameter	Type and size of casing	No. of feet of casing	Intervals casing is perforated (in feet)	Seal depth	Est. depth to water	Est. depth to water bearing stratum	Type of access port or measuring device	Total well depth
No (Well# 1-1)	N/A	Est. 8-12"	Est. 6-8"	200'	50-200'	30	20-40'	20-40'	1" threaded access port	Approx 250'
No (Well# 2-1)	N/A	Est. 8-12"	Est. 6-8"	200'	50-200'	30	20-40'	20-40'	1" threaded access port	Approx 250'

T 11030

RECEIVED

MAR 16 2010

WATER RESOURCES DEPARTMENT
SALEM, OREGON

7. AFFECTED DISTRICTS AND LOCAL GOVERNMENTS

- Are any of the Permit(s) or Registration(s) proposed for amendment/modification located within or served by an irrigation or other water district? Yes No
- Will any of the Permit(s) or Registration(s) be located within or served by an irrigation or other water district after the proposed amendment/modification? Yes No
- Is water for any of the Permit(s) or Registration(s) supplied under a water service agreement or other contract for stored water with a federal agency? Yes No

If "Yes", for any of the above, list the name and mailing address of the district and/or agency:

- List the name and mailing address of all affected local governments (e.g., county, city, municipal corporation, and tribal governments within whose jurisdiction the right(s) are located).

Clackamas County, 150 Beaver Creek Road, Oregon City, OR 97045

8. PERMIT HOLDER OF RECORD

This section is to be completed only for Permit Amendment applications.

N/A – This is a Ground Water Registration Modification application.

- Is the applicant the permit holder of record? Yes No

If "No", the applicant must either:

A. Be assigned as a permit holder of record by submitting a completed **Request for Assignment** form and the required statutory fee for an assignment;

or

B. Submit an **Affidavit of Consent** from the permit holder of record that gives permission for the applicant to amend the permit.

T 11030

MAR 16 2010

AFTER RECORDS LEFT
SALEM OFFICE

9. LAND OWNERSHIP

If for a Permit Amendment proposing a Change in Place of Use:

- Does the permit holder of record own or control the land **TO** which the place of use is being moved? Yes No

If "No", the owner of the land **TO** which the place of use is being moved **must be assigned to the permit as a permit holder of record** by submitting a completed **Request for Assignment** form and the required statutory fee for an assignment.

- Check **one** of the following:
 - The permit holder of record will be responsible for completion of the proposed changes after the final order is issued. All notices and correspondence should be sent to the permit holder of record.
 - The applicant will remain responsible for completion of changes. Notices and correspondence should continue to be sent to the applicant and applicant's agent.

If for a Ground Water Registration Modification: **NOT APPLICABLE**

- Does the applicant own the lands **FROM** which the registration is being moved? Yes No

If "No", provide the following information:

Names of Current Landowner(s): _____

First Last

Address: _____

City State Zip

- Does the applicant own the lands **TO** which the registration is being moved? Yes No

If "No", provide the following information:

Names of Receiving Landowner(s): _____

First Last

Address: _____

City State Zip

- Check **one** of the following:
 - The receiving landowner will be responsible for completion of the proposed changes after the final order is issued. All notices and correspondence should be sent to this landowner.
 - The applicant will remain responsible for completion of changes. Notices and correspondence should continue to be sent to the applicant and applicant's agent.

RECEIVED

MAR 16 2010

WATER RESOURCES DEPT
SALEM, OREGON

10. ATTACHMENTS

*Check each of the following attachments included with this application.
The application will be returned if all required attachments are not included.*

<p>Map:</p> <p><input checked="" type="checkbox"/> A map meeting the requirements of OAR 690-380-3100 must be included but need not be prepared by a Certified Water Right Examiner.</p> <p>Land Use Information Form:</p> <p><input checked="" type="checkbox"/> Enclosed; <i>or</i></p> <p><input type="checkbox"/> Not required if all of the following are met:</p> <ul style="list-style-type: none">❶ In EFU zone or irrigation district;❷ Change in place of use only;❸ No structural changes needed, including diversion works, delivery facilities, other structures; <i>and</i>❹ Irrigation only. <p>Water Well Reports/Well Logs:</p> <p><input checked="" type="checkbox"/> The application involves a change in point of appropriation or change from surface water to ground water and copies of all water well reports are attached.</p> <p><input type="checkbox"/> Water well reports are not available and a description of construction details including well depth, static water level, and information necessary to establish the ground water body developed or proposed to be developed is attached.</p> <p><input type="checkbox"/> N/A. The application does not involve a change in point of appropriation or a change from surface water to ground water, so water well reports are not required.</p>	<p>Fees:</p> <p><input checked="" type="checkbox"/> Amount enclosed: \$ <u>1900.00</u> See the Department's Fee Schedule at www.wrd.state.or.us/OWRD/PUBS/forms.shtml or call (503) 986-0900.</p> <p><u>For Permit Amendments Only...</u></p> <p>Request for Assignment:</p> <p><input type="checkbox"/> Enclosed. The applicant is NOT the permit holder of record and needs to be assigned to the permit; OR the landowner of the proposed place of use is NOT the permit holder of record and needs to be assigned to the permit. <i>The Request for Assignment form is available online at: www.wrd.state.or.us/OWRD/PUBS/forms.shtml ; <i>or</i></i></p> <p><input checked="" type="checkbox"/> N/A. The applicant is the permit holder of record and owns or controls the proposed place of use; OR the applicant is not the permit holder of record but is supplying an Affidavit of Consent from the permit holder.</p> <p>Affidavit of Consent:</p> <p><input type="checkbox"/> Enclosed. Because the applicant is NOT the permit holder of record, an Affidavit of Consent is being supplied that gives permission for the applicant to amend the permit; <i>or</i></p> <p><input checked="" type="checkbox"/> N/A. Not required because the applicant is the permit holder of record.</p>
---	---

T 11030

Before submitting your application to the Department, be sure you have:

- Answered each question completely.
- Included all the required attachments.
- Provided original signatures for **all** named deed holders, or other parties, with an interest in the water right.
- Included a check payable to the Oregon Water Resources Department for the appropriate amount.

11. SIGNATURES

- **For Ground Water Registration Modification Applications only, check the appropriate one and sign the application in the signature box below:**

In accordance with OAR 690-382-0400(16)(a), I (we) understand that prior to Department approval of a permanent modification and upon my receipt of a draft Preliminary Determination for the proposed modification, I (we) will be required [pursuant to OAR 690-382-0700(5)] to provide the following landownership information and evidence demonstrating that I (we) are authorized to pursue the modification:

- (a) A report of ownership and lien information that has been prepared by a title company *within the last three months;*
- (b) A copy of written notification of the proposed modification provided by the applicant to **all** lien holders on the subject lands unless the report of ownership and lien information shows that a water right conveyance agreement has been recorded for the subject lands. *If a water right conveyance agreement has been recorded for the subject lands, a copy of the recorded agreement and a listing of the owner(s) of the lands at the time the agreement was recorded must be submitted; and*
- (c) If the applicant is **not both** the person named on the ground water registration or the assignee **and** the owner of the lands to which the registration is appurtenant, as identified in the report of ownership and lien information, then **either** of the following must be provided:
 - A) Notarized statements consenting to the modification by all persons, other than the applicant, who are named on the ground water registration or identified as landowners in the report of ownership and lien information or who are authorized representatives of an entity to whom the interest in the water right has been conveyed as identified in a water right conveyance agreement; **or**
 - B) Documentation demonstrating that the applicant is authorized to pursue the modification in the absence of consent of the persons named on the ground water registration or the assignee **and** the owner of the lands to which the registration is appurtenant.

I (we) affirm that the applicant is a municipality, as defined in ORS 540.510(3)(b), and that the right is in the name of the municipality or a predecessor. Therefore, pursuant to OAR 690-382-0400(16)(b), the applicant is **NOT** required to provide the above described report of ownership and lien information.

I (we) affirm that the applicant is an entity with the authority to condemn property and is acquiring the property to which the ground water registration proposed for modification is appurtenant by condemnation. Documentation is provided with this application supporting this statement. Therefore, pursuant to OAR 690-382-0400(16)(c), the applicant is **NOT** required to provide the above described report of ownership and lien information. (NOTE: Such an entity may only apply for recognition of a modification under this subsection if it has filed a condemnation action to acquire the property and deposited the funds with the court as required by ORS 35.265.)

- **For both Permit Amendment and Ground Water Registration Modification Applications, I (we) affirm that the information contained in this application is true and accurate.**

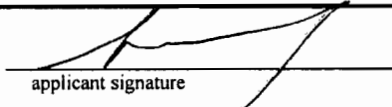
 applicant signature	SCOTT BROWN name (print)	3-10-10 date
 applicant signature	 name (print)	 date

RECEIVED
MAR 10 2010

T 030

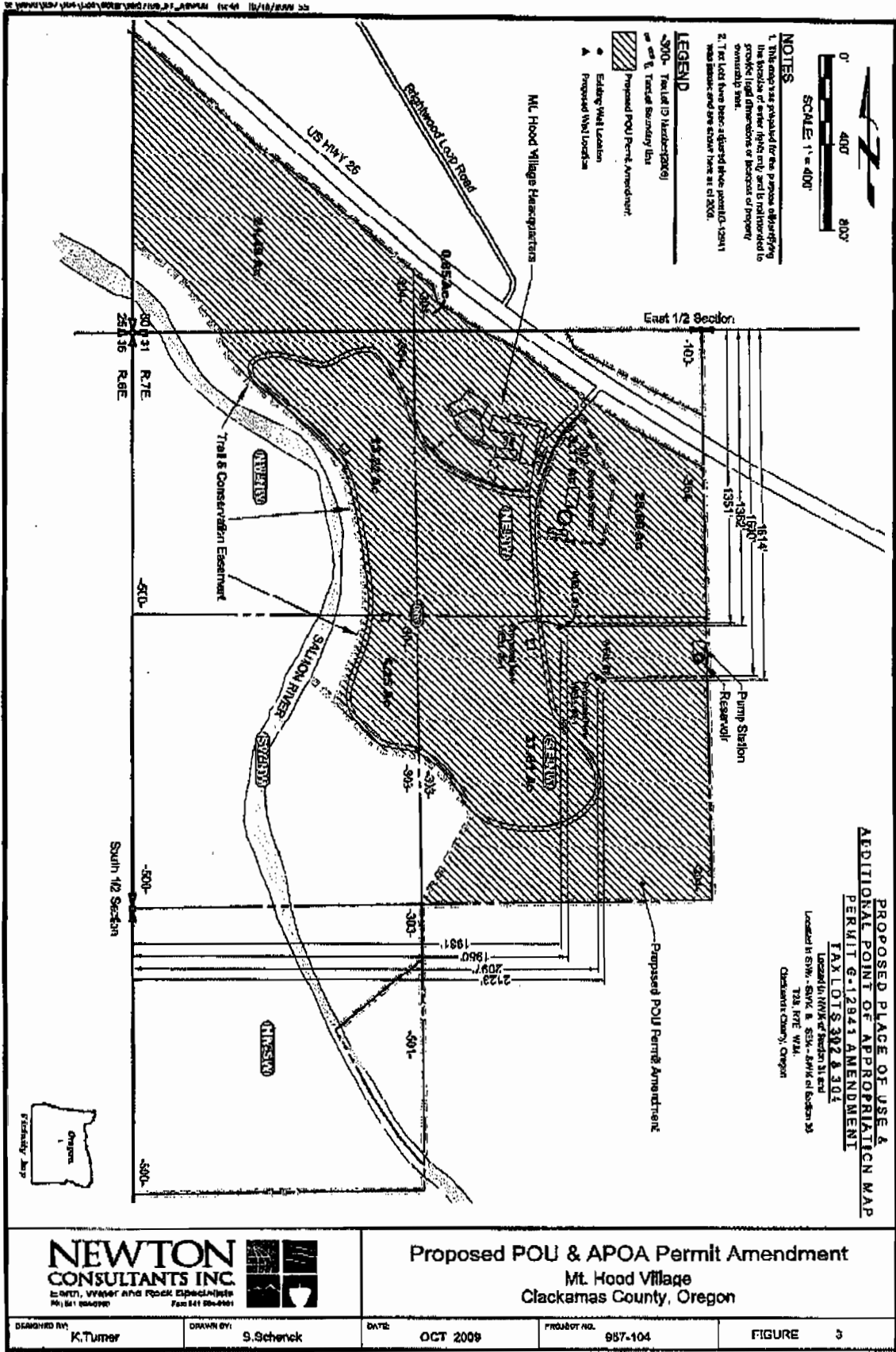

T 11030