



# WESTLAND IRRIGATION DISTRICT

## 2010 TEMPORARY TRANSFER

### PRIOR-PRIOR - page 2 of 2

### TO GROUND - 3N 28E

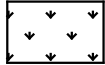
T 3N, R 28E

-  TO: 504.9 acres certificates 76050, 75127 & 81815 all becoming supplemental to existing primaries on the "TO" ground, for this season only.
-  375.0 existing acres certificates 76050 & 79439 on "TO" ground. Incoming water rights to become supplemental to this existing primary 76050 for the 2010 irrigation season.
-  129.9 existing acres certificates 76717 & 79439 on "TO" ground. Incoming water rights to become supplemental to this existing primary 76717 for the 2010 irrigation season.

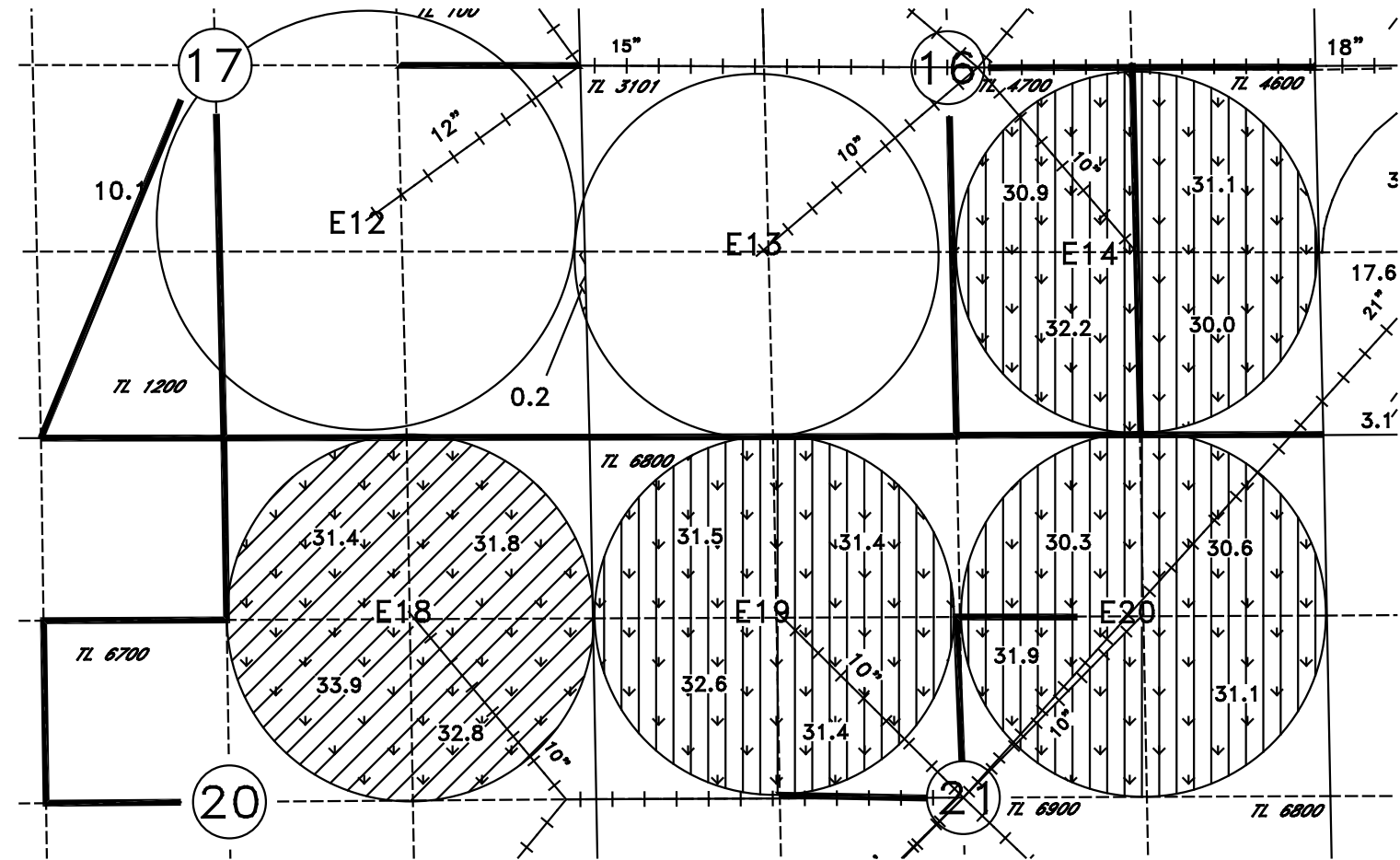

T3N., R 29E., W.M.

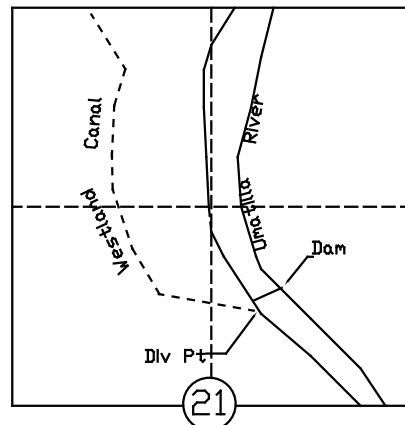

AUTHORIZED P.O.D., FOR CERTIFICATES 76050, 76717, 76715, 76799, 76723, 81815  
DIV PT LCT N. 76°45'56"E. 2913.19' FROM W. 1/4 COR. SEC 21

AUTHORIZED WELLS FOR CERTIFICATE 75127 ARE LOCATED AS FOLLOWS:  
WELL 4 - 2640 ft. S. & 630 ft. W. from NW 1/4 corner section 1, 2N 28E  
\*WELL 7 - 2500 ft. S. & 2580 ft. E. from NW corner section 2, 2N 28E  
WELL 8 - 2800 ft. S. & 500 ft. W. from NE corner section 2, 2N 28E

\* As in 2009 temporary transfer T-10844, 2008 temporary transfer T-10597 and 2007 temporary transfer T-10359, the point of appropriation for Well #7 will be temporarily changed to Wells #4 & #8 for the 2010 Irrigation season to allow the amount of water authorized under Certificate 75127 for Well #7 (1.8 cfs) to be used in any combination from Wells #4 and #8 at the proposed place of use.

