

SW/4 of S27 and SE/4 of S28
T6N, R35E, WM
Umatilla County

1 inch = 400 ft

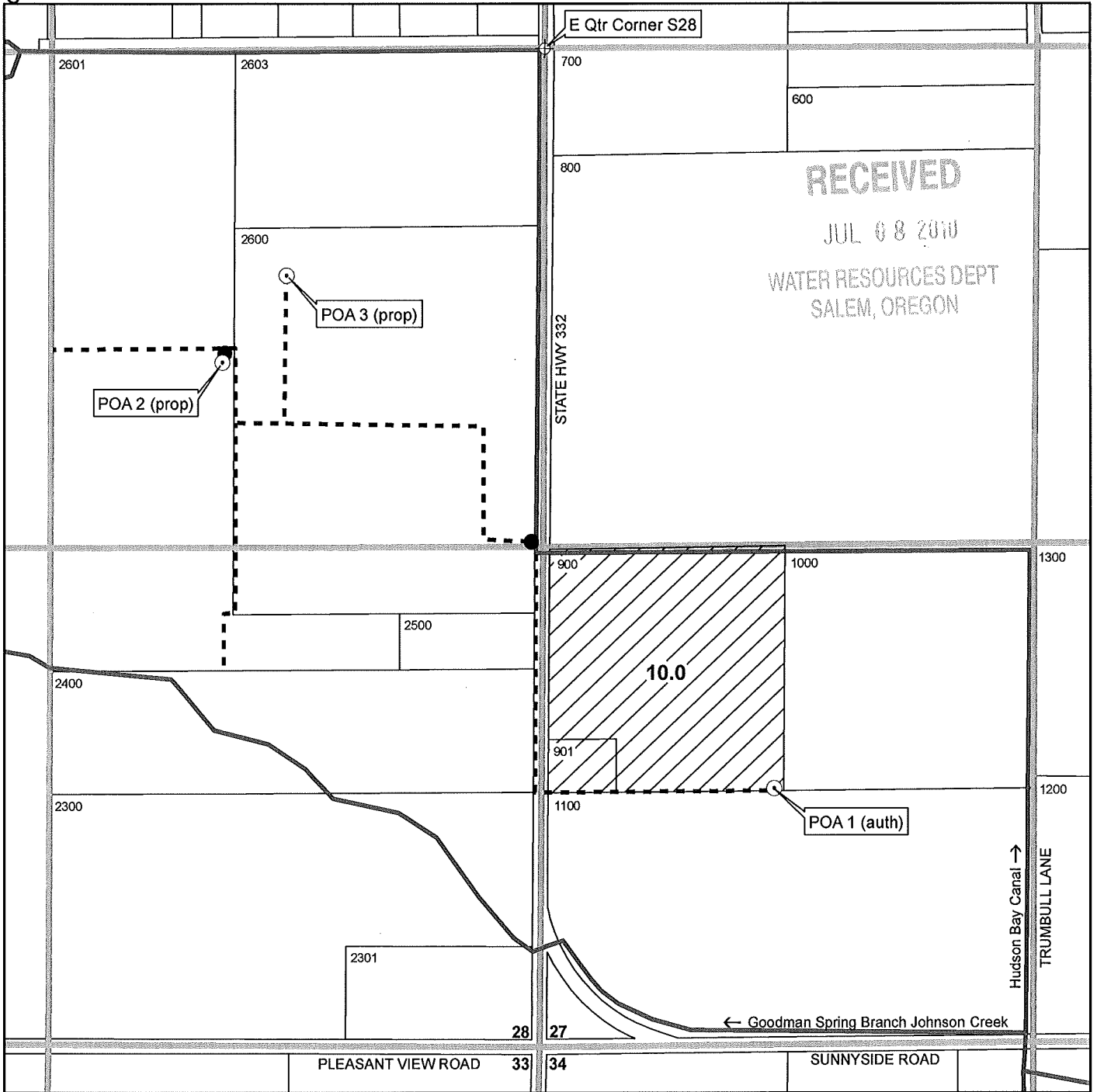

- ⊙ **Point of Appropriation**
 POA 1 (Auth POA) located in SW SW, Sec 27, T6N, R35E, WM, 710 ft N and 610 ft E from SW Corner Sec 27. Well Log UMAT 4744.
 POA 2 (Prop POA) located in NE SE, Sec 28, T6N, R35E, WM, 1820 ft N and 850 ft W from SE Corner Sec 28. Well Log UMAT 4757.
 POA 3 (Prop POA) located in NE SE, Sec 28, T6N, R35E, WM, 2050 ft N and 740 ft W from SW Corner Sec 27. Well Log UMAT 5496.

Place of Use
 Authorized place of use is 10.0 ac in SW SW, Section 27, T6N, R35E, WM.

T 11106

The purpose of this map is to identify the location of a water right. It is not intended to provide information regarding the location of property ownership boundary lines.

FOUNTAINHEAD
 1204 Alvarado Terrace
 Walla Walla, WA 99362
 509.529.2646 phone

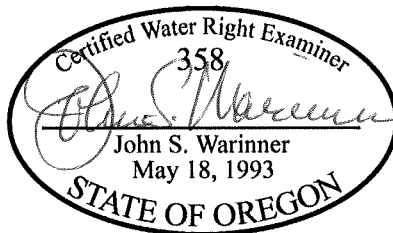

**GR CLAIM MODIFICATION
 Registration GR-3349
 Certificate GR-3101**
 in the name of
WAYNE TRUMBULL
 Revised 07 JUN 2010