

T. 36 S. R. 4 W. W. M.

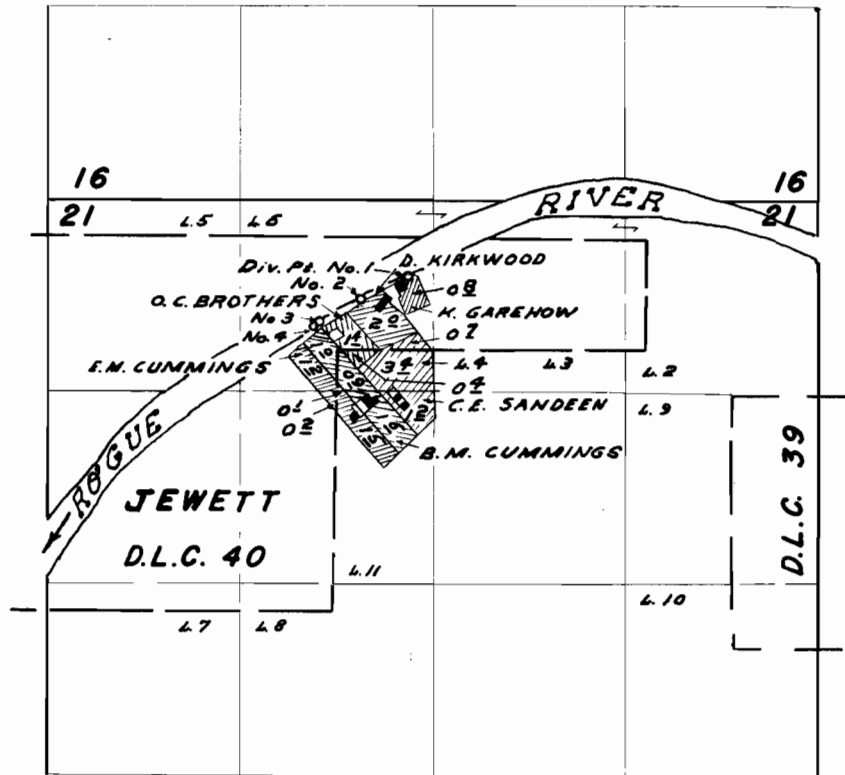

Div. Pt. No. 1 500 Ft. N. & 480 Ft. E.
 No. 2 350 Ft. N. & 160 Ft. E. FROM REENTRANT
 No. 3 200 Ft. N. & 110 Ft. W. COR. D.L.C. 40
 No. 4 170 Ft. N. & 150 Ft. W.

FINAL PROOF SURVEY
 UNDER

TRANSFER B-127

Application No. _____ Permit No. _____
 IN NAME OF

OSCAR G. & BERTHA J. BROTHERS

Surveyed **JULY 19** 1965, by **L. COLEBANK**