

Township 6 NORTH, Range 35 EAST.

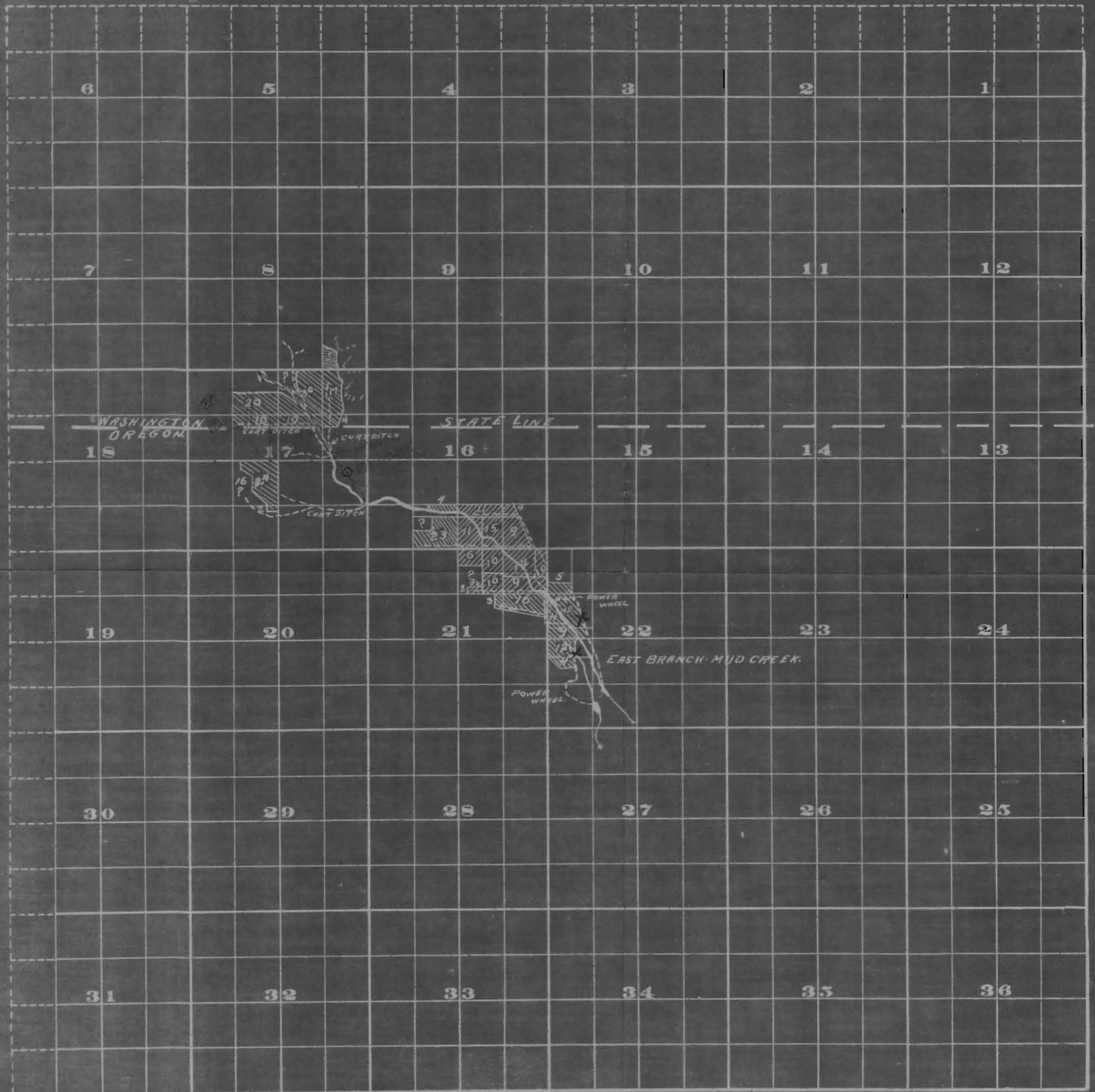

Survey By P. J. Cooper Oct. 1909

FROM OFFICE OF THE STATE ENGINEER, SALEM, OREGON



Scale of Feet.

JOHN H LEWIS STATE ENGINEER.

ADJUDICATION.

EAST BRANCH of MUD CREEK. 8d 3

Examined Jan. 12, 1910
5 mi