

T.15S. R.16E.W.M.

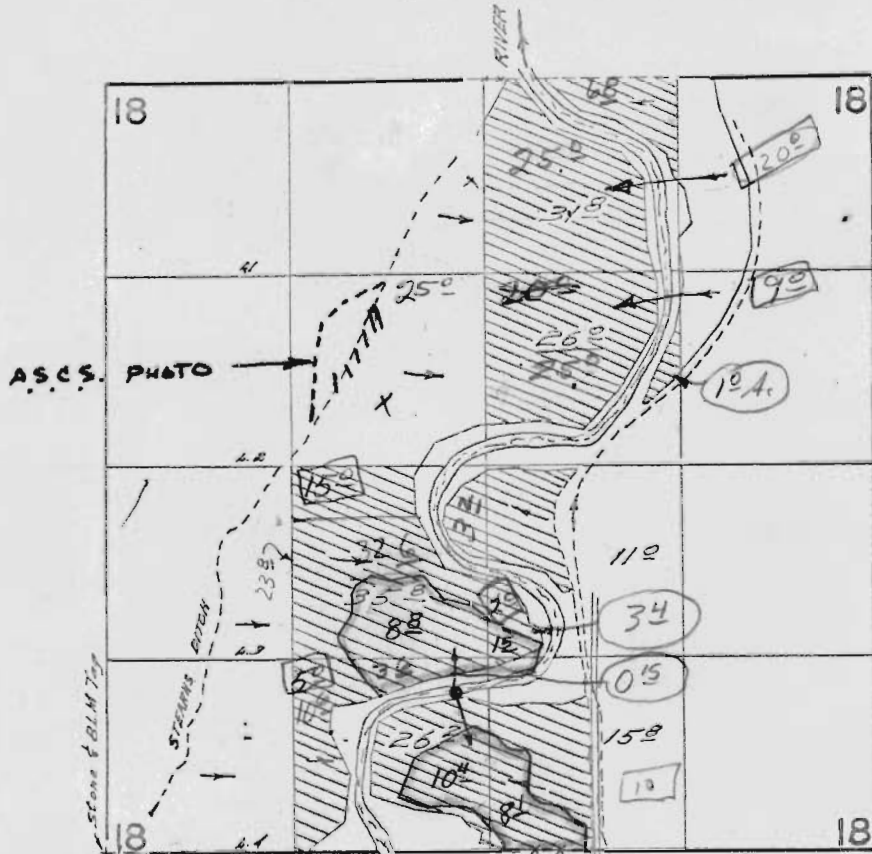

All land was to have been West of River.
See Map 9/23/42

15876 - GREEN AREA HAS CERT UNDER THIS APPL.

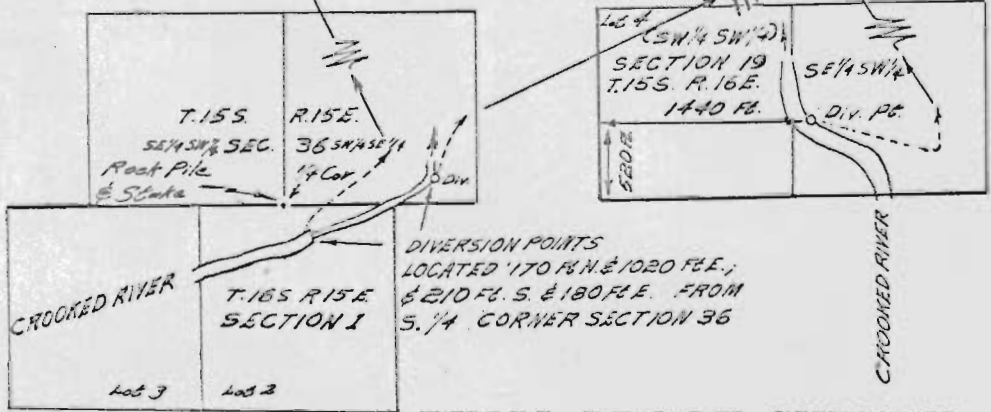

FINAL PROOF SURVEY
UNDER

TRANSFER C-35
Application No. Permit No.
IN NAME OF

BOSTON RANCH COMPANY

Surveyed June 29 & 30 1967, by J. Ruppert