

T.15S.,R.31E.,W.M.

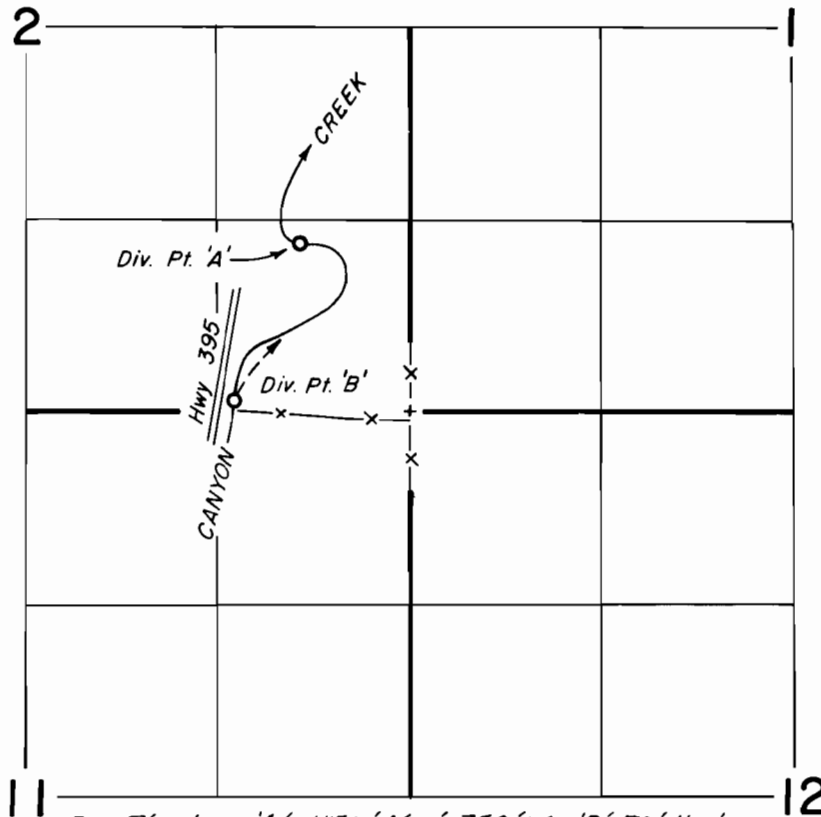

Div. Pts. Loc.: 'A' - 1150' N. & 750' W.; 'B' 70' N. & 1200' W.; both from the SE Cor. Sec 2

**FINAL PROOF SURVEY**  
UNDER

TRANSFER NO. C-203

IN NAME OF

**DALE E. & LOUISE M. SHREFFLER**

Surveyed JUNE 14, 1980, by *[Signature]*