

IMPROVEMENT COMPANY PROPOSED WHITE PIPELINE PROJECT

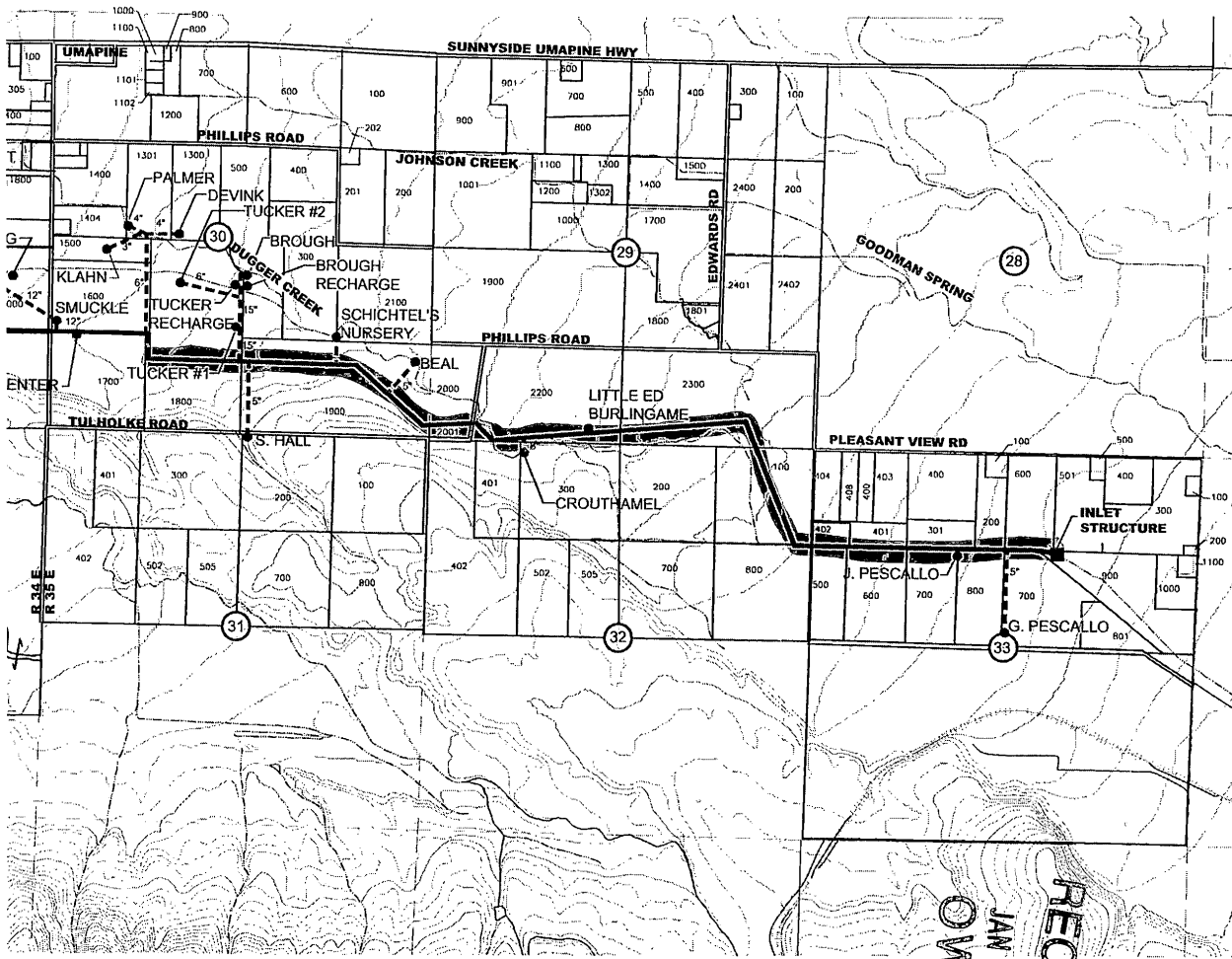

RECEIVED
 JAN 02 2018
 OWRD

SERVICE PIPE		
MEMBER	ACREAGE	F
1.	G. Pescallo	19.0
2.	J. Pescallo	19.0
3.	S. Crouthamel	76.0
4.	S. Hall	35.7
5.	Beal	36.5
6.	Schichtel's Nursery	30.0
7.	S. Tucker 1&2	62.4
8.	J. Brough	27.6
9.	Devink	14.6
10.	H. Palmer	15.0
11.	R. Klahn	9.0
12.	J. Carpenter	38.7
13.	Little Ed Burlingame	60
14.	Recharge #1	5
15.	Recharge #2	11
16.	D. Hall	47.5
17.	Smuckle	20.0
18.	L. Zwang	19.7
19.	L. Givens	65.5
20.	L. Givens	15.4
21.	D. Wright	13.84
22.	T&S Richartz	117
23.	G. Lieuallen	10
TOTALS		752.44

PASS THROUGH		
MEMBER	ACREAGE	
1.	A. Burrocker	20.0
2.	T. O. Williams/Cockburn	234.0
3.	T. O. Williams/Marlett	123.0
4.	B. Schurbert/T. Derue	52.8
5.	T. Derue	148.8
6.	T. Derue	58.8
7.	T. Derue	41.3
8.	T. Derue	202.6
9.	T. O. Williams/Bussel South	87.3
10.	T. Derue	17.5
11.	T. Derue/m. Williams	146.2
12.	T. O. Williams/Bussel North	163.7
13.	T. O. Williams/Young Place	76.5
14.	O. A. White	476.9
15.	Little Ed Burlingame	84.0
16.	T. O. Williams/Weidert	477.0
TOTALS		2410.4