

- LEGEND**
- ⊙ Authorized Point of Diversion (POD)
 - Waterline
 - ▨ Portion of Authorized Place of Use Involved in the Allocation of Conserved Water (2,374.5 ac)
 - Remaining Portion of Authorized Place of Use (596.8 ac.)
 - Major Road
 - ▭ City Boundary
 - ▭ County Boundary
 - ▭ Government Lot (GL)
 - Watercourse
 - Waterbody

LOCATION DESCRIPTION
Amstad Diversion
 Located 2,270 feet North and 940 feet East from SW corner,
 Section 13, Township 5 North, Range 27 East (WM)

Allocation of Conserved Water
Certificate 53731 (Permit S-37108)
A Water Right held by Onyx Land Company, LLC
 Township 5 North, Range 27, 28 East (W.M.)
 Umatilla County

DISCLAIMER
 This map was prepared for the purpose of identifying the location of a water right only and it is not intended to provide legal dimensions or location of property ownership lines.

Date: November 23, 2021
 Data Sources: BLM, ESRI, OWRD, USGS, Umatilla Co., Gimmway Enterprises

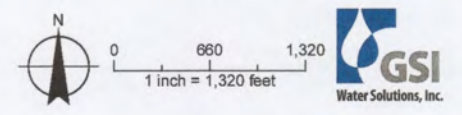

CW-126



**Allocation of Conserved Water
 Certificate 53731 (Permit S-37108)
 A Water Right held by Onyx Land
 Company, LLC
 Township 5 North, Range 27, 28
 East (W.M.)
 Umatilla County**

LEGEND

- Waterline
- Major Road
- City Boundary
- County Boundary
- Government Lot (GL)
- Watercourse

RECEIVED
 NOV 30 2021
OWRD

DISCLAIMER

This map was prepared for the purpose of identifying the location of a water right only and it is not intended to provide legal dimensions or location of property ownership lines.

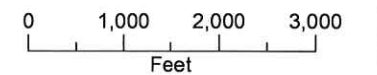
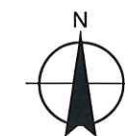

Date: October 7, 2021
 Data Sources: BLM, ESRI, ODOT, USGS,
 USDA imagery (July 2020)

Aerial Imagery Date: July 2020