

RECEIVED
MAY 1971
STATE ENGINEER
SALEM OREGON

T.34S.R.IW.W.M.

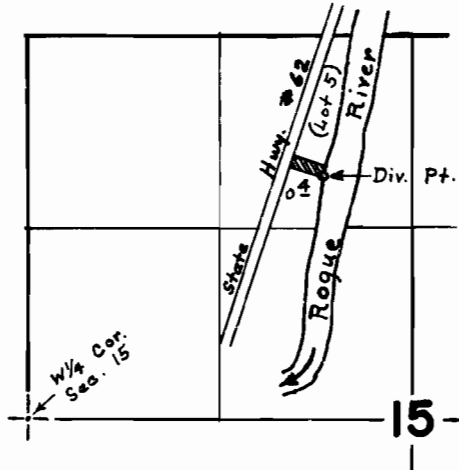

Div. Pt. is located 1680' N. and
2045' E. from W/4 Cor. Sec. 15.

FINAL PROOF SURVEY
UNDER

Trans. No. D- 131

Application No. _____ Permit No. _____
IN NAME OF

Dale & Margaret Davis

Surveyed 5/18 1971, by D.C. Hendrix