

SE1/4 SE1/4 Sec. 16 T.14S. R.13E.W.M.

14 13 16 D D

DESCHUTES COUNTY

1"=100'

See Map 14 13 16 D A 158



TO

**RECEIVED**  
 JUL 17 1968  
 STATE ENGINEER  
 SALEM, OREGON

14 13 16 D D

NE 1/4 SW 1/4 Sec. 16 T. 14 S. R. 13 E. W. M.

14 13 16 C A

DESCHUTES COUNTY

1" = 100'

See Map 14 13 16 B D

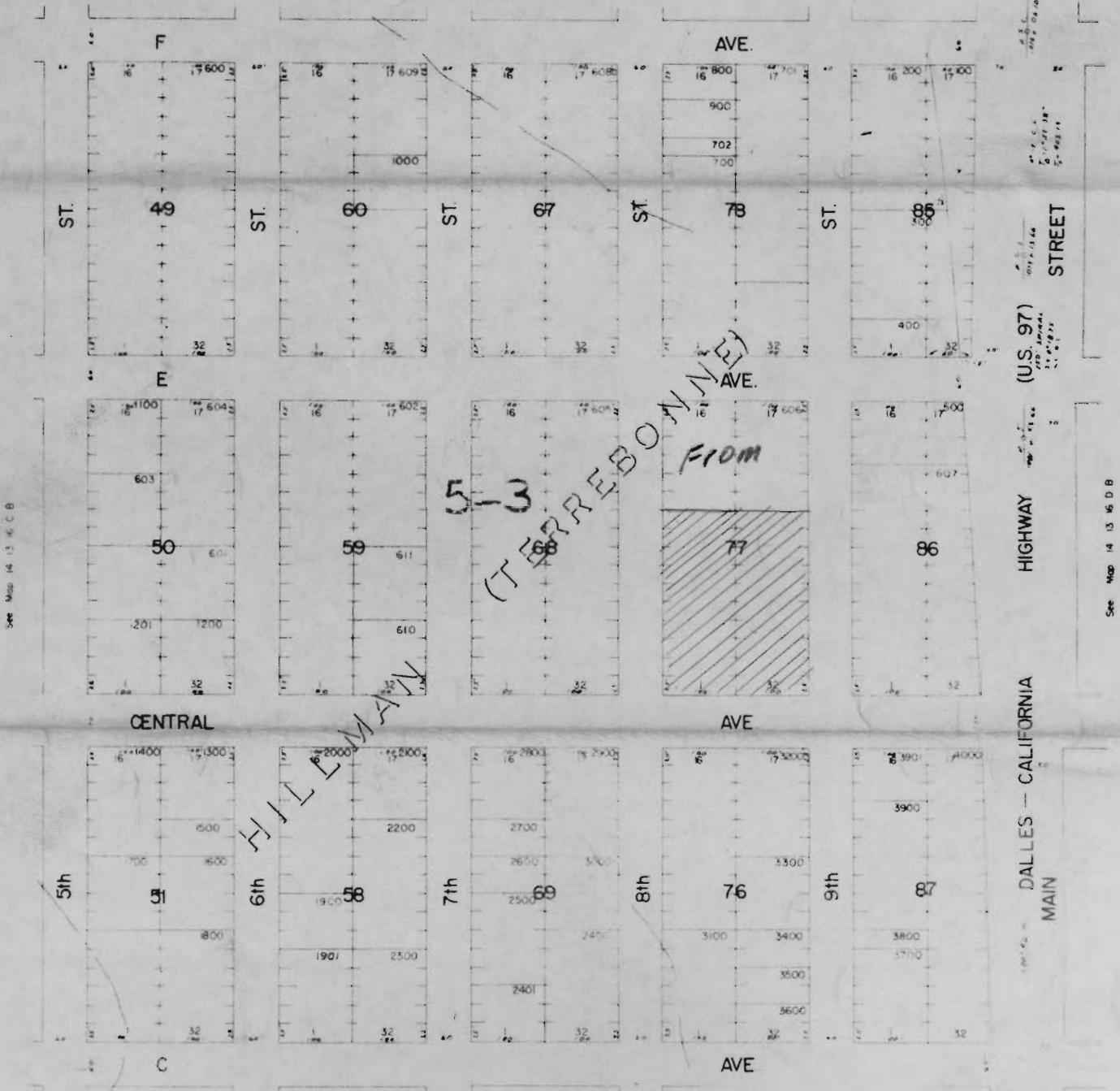

**RECEIVED**  
 JUN 27 1968  
 STATE ENGINEER  
 OREGON

14 13 16 C A