

# T. 4 S. R. 39 & 40 E. W.M.

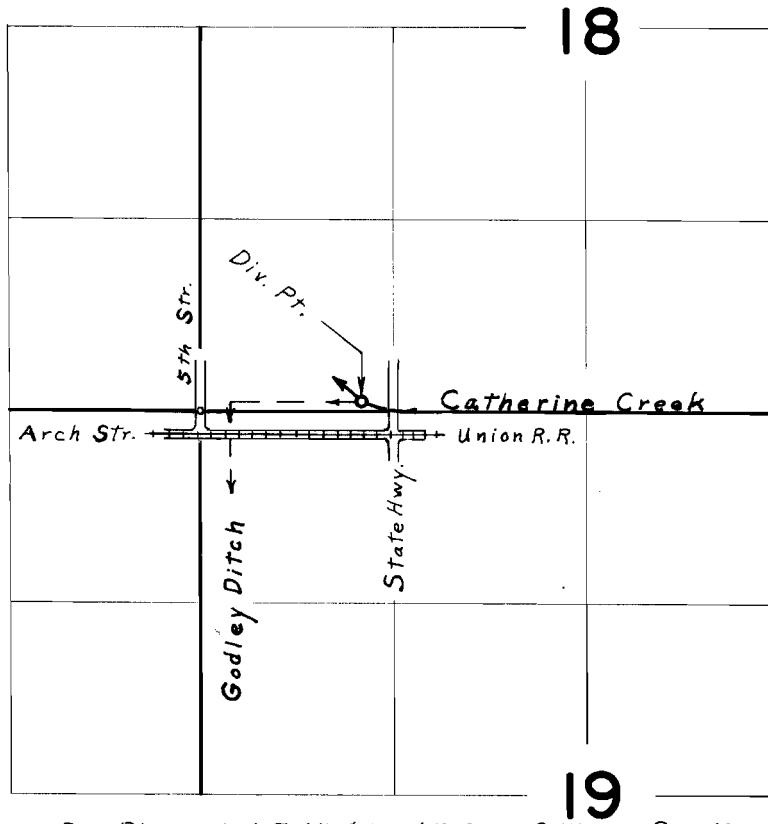

*Div. Pt. located 70' N. & 1100' E. from S. W. cor. Sec. 18*

## FINAL PROOF SURVEY UNDER

TRANSFER NO. H-166

Application No. \_\_\_\_\_ Permit No. \_\_\_\_\_

IN NAME OF

**LOWELL HUTCHINSON**

Surveyed Aug. 28, 1968, by L. E. Gould.