

**PORTION OF SECTIONS 35, TOWNSHIP 9 NORTH, RANGE 4 EAST, W.M.  
& PORTION OF SECTIONS 2, TOWNSHIP 10 NORTH, RANGE 4 EAST, W.M.**

POLK COUNTY, OREGON  
Luckiamute Landing

**RECEIVED**

DEC 24 2007

WATER RESOURCES DEPT  
SALEM, OREGON

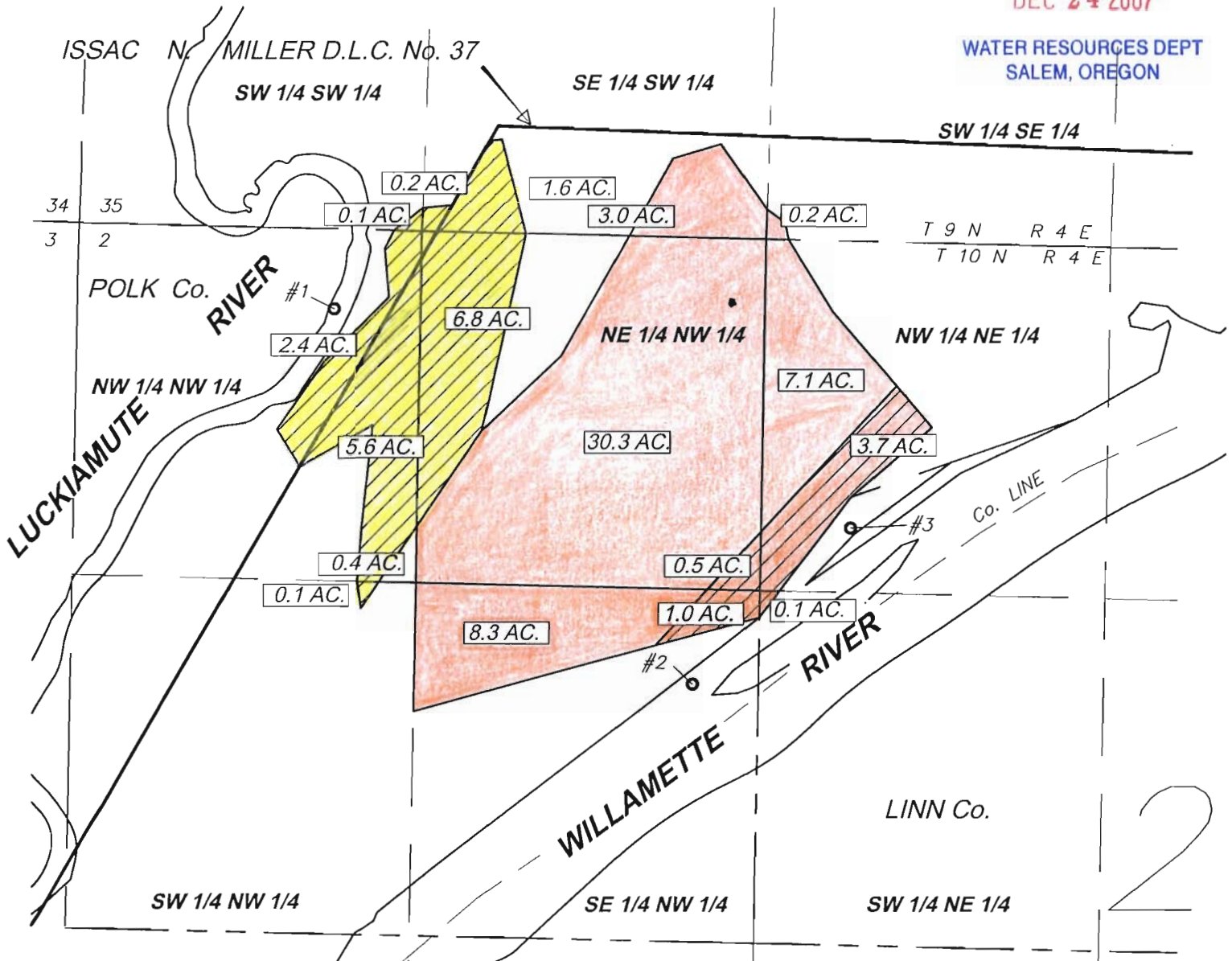

**POINT OF DIVERSION REFERENCES**

- #1-LUCKIAMUTE RIVER - S71°30'E 1050 FT. FROM NW COR. SEC. 2
- #2-WILLAMETTE RIVER - S09°20'W 1050 FT. FROM N1/4 COR. SEC. 2
- #3-WILLAMETTE RIVER SLOUGH - S16°20'E 1170 FT. FROM N1/4 COR. SEC. 2



1" = 600'

THE PURPOSE OF THIS MAP IS FOR IDENTIFYING THE LOCATION OF THE WATER RIGHT ONLY AND IS NOT INTENDED TO PROVIDE LEGAL DIMENSIONS OR LOCATION OF PROPERTY OWNERSHIP LINES

- POTABLE WATER AREA
- POINTS OF DIVERSION
- POTABLE WATER AREA (Instream Lease area hatched)

Willamette & Slough  
Luckiamute

EXECUTED BY:  
OREGON PARKS & RECREATION DEPT.  
725 Summer St., NE, Suite C  
SALEM, OREGON 97301-1266  
Applic\_Map-adj.dwg  
DECEMBER 18, 2007