

INSTREAM LEASE APPLICATION MAP IN THE NAME OF INTERNATIONAL PAPER COMPANY

RECEIVED

MAR 23 2006

APPLICATION 29820

PERMIT 26724

CERTIFICATE 80656

WATER RESOURCES DEPT
SALEM, OREGON

TOWNSHIP 20 SOUTH, RANGE 12 WEST, W.M.

THE DIVERSION FOR THE SILTCOOS RIVER IS LOCATED 100 FEET SOUTH AND 2580 FEET WEST FROM THE NORTHEAST CORNER OF SECTION 14, BEING WITHIN THE NW 1/4 NE 1/4 (LOT 5) OF SECTION 14, TOWNSHIP 20 SOUTH, RANGE 12 WEST, W.M., DOUGLAS COUNTY.

WATER FROM SILTCOOS LAKE AND RESERVOIR IS A SUPPLEMENTAL SOURCE ONLY. WHEN LEASED, ALL THE WATER FROM SILTCOOS LAKE AND RESERVOIR WILL BE LEASED.

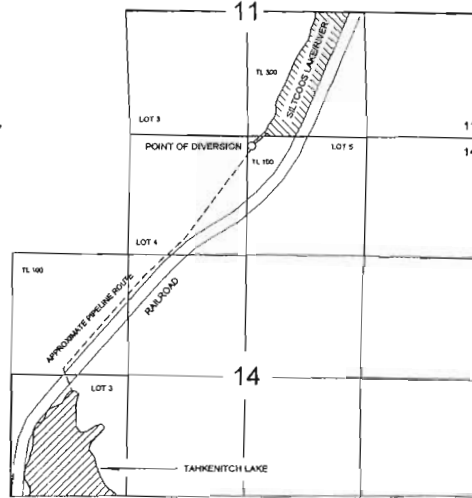

TOWNSHIP 21 SOUTH, RANGE 12 WEST, W.M.

THE TAHKENITCH LAKE POINT OF DIVERSION IS LOCATED 880 FEET NORTH AND 200 FEET WEST FROM THE SOUTHEAST CORNER OF SECTION 4; BEING WITHIN THE SE 1/4 SE 1/4 (LOT 5) OF SECTION 4, TOWNSHIP 21 SOUTH, RANGE 12 WEST, W.M.; DOUGLAS COUNTY.

4.8 CUBIC FEET/SECOND WILL BE TAKEN FROM THE 5.65 CUBIC FEET/SECOND UNDER DATE OF PRIORITY OF 3/16/55. THE REMAINING 1.85 CUBIC FEET/SECOND AND THE 19.65 CUBIC FEET/SECOND UNDER DATE OF PRIORITY OF 11/9/55 TO BE LEASED FOR FISH, WILDLIFE AND RECREATION.

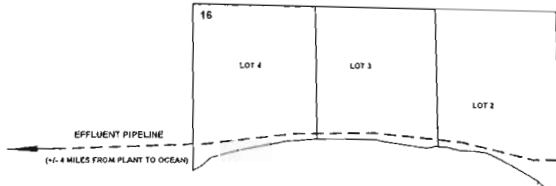
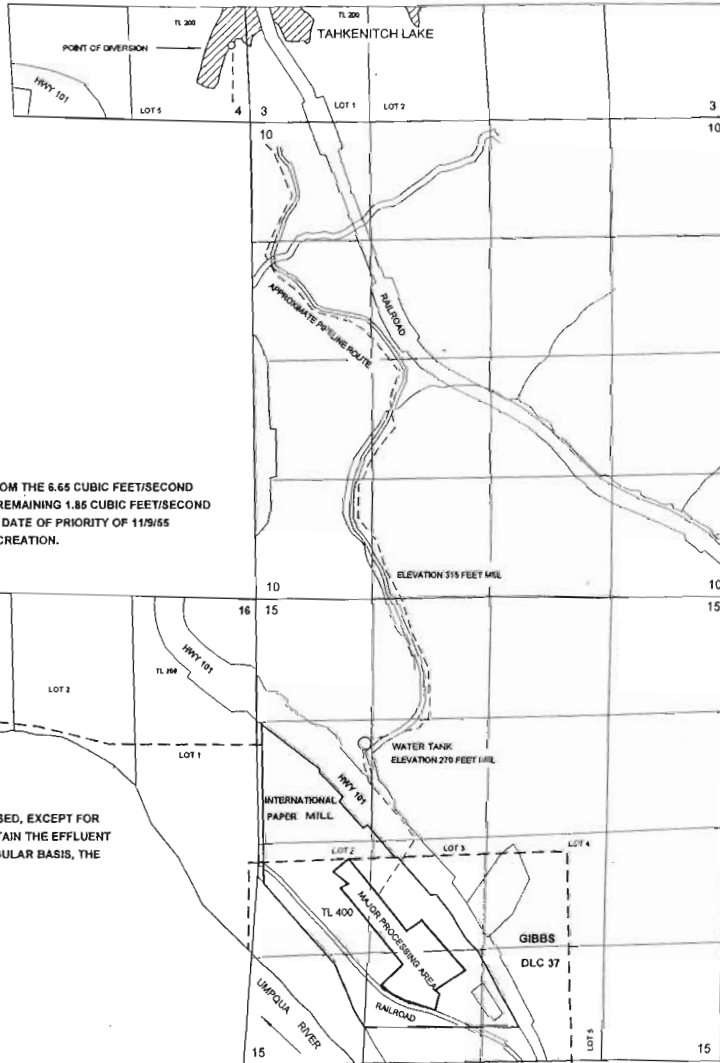

ALL USE OF WATER WILL BE DISCONTINUED, WHEN LEASED, EXCEPT FOR 4.8 CUBIC FEET/SECOND WHICH WILL BE USED TO MAINTAIN THE EFFLUENT PIPELINE (OR OCEAN OUTFALL). IF NOT USED ON A REGULAR BASIS, THE LINE WILL FILL WITH SAND AND BE USELESS.

THE PURPOSE OF THIS MAP IS TO SHOW THE LOCATION OF THE WATER RIGHT. IT IS NOT INTENDED TO PROVIDE INFORMATION RELATIVE TO THE LOCATION OF PROPERTY OWNERSHIP OR BOUNDARY LINES.