

WATER RIGHTS WITHIN 2 MILE(S) OF TOWNSHIP 9 S 4 W

Section(s) 16 29

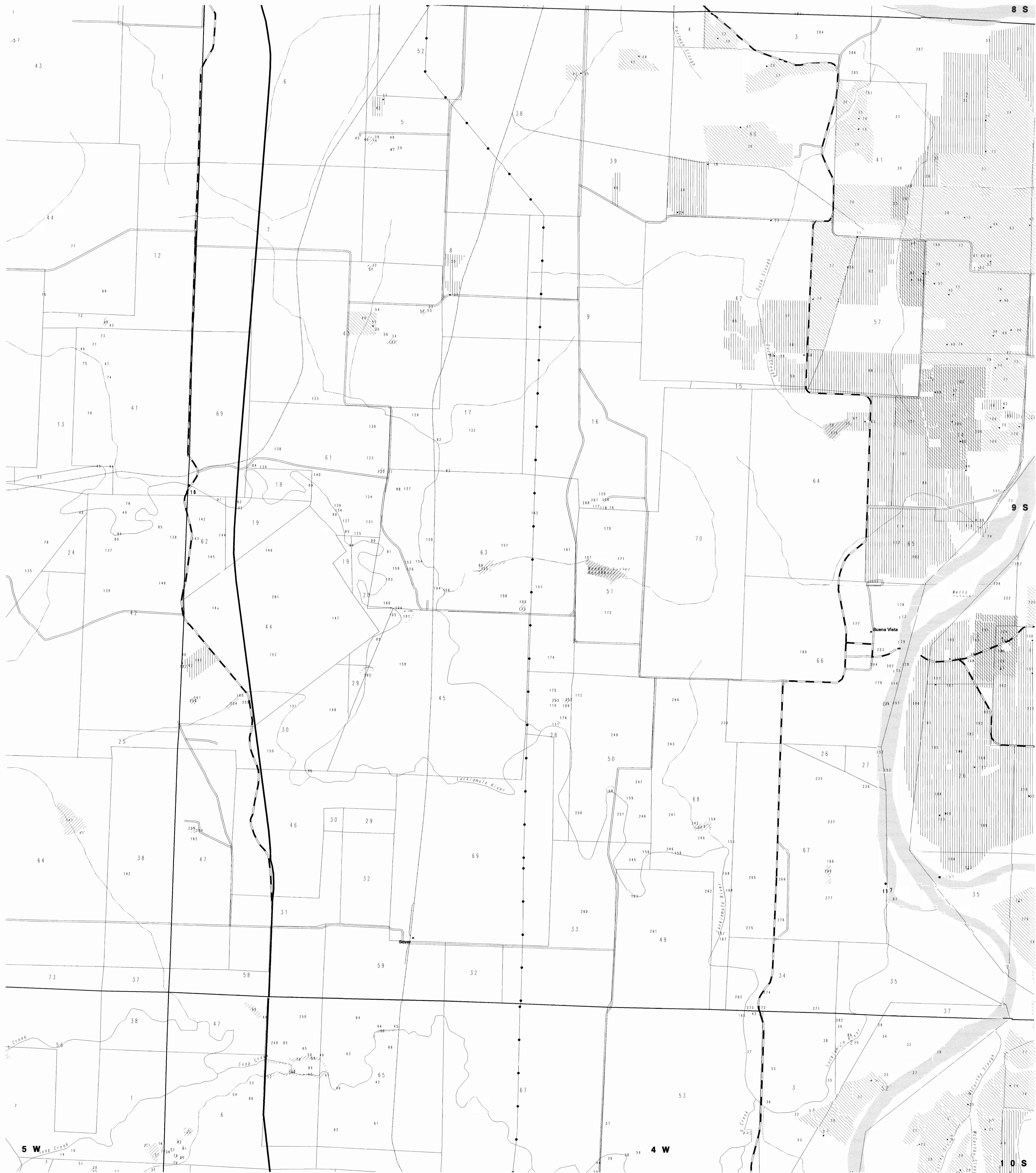

PLACE OF USE BY SOURCE OF RIGHT
 Multiple shades indicates multiple sources for rights servicing the parcel. Bold number in parcel is referenced in report.

POINT OF DIVERSION BY SOURCE OF RIGHT
 Number next to point is referenced in report.

<ul style="list-style-type: none"> ▨ Serviced by surface water or decree right ▨ Reservoir right ▨ Serviced by Groundwater right ▨ Serviced by Groundwater registration right 	<ul style="list-style-type: none"> • Surface water right point of diversion • Groundwater right point of diversion • Groundwater registration point of diversion Applic# shown in red along reach.
---	--

Rights shown on this map are approximate.
 Contact OWRD for the best locational data.

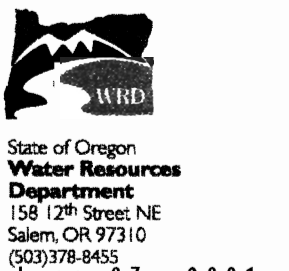

State of Oregon
 Water Resources Department
 158 12th Street NE
 Salem, OR 97331
 503.738.9455

Map produced June 07, 2001