

JPEEE

33396

T. 1 S. R. 13 E. W. M.

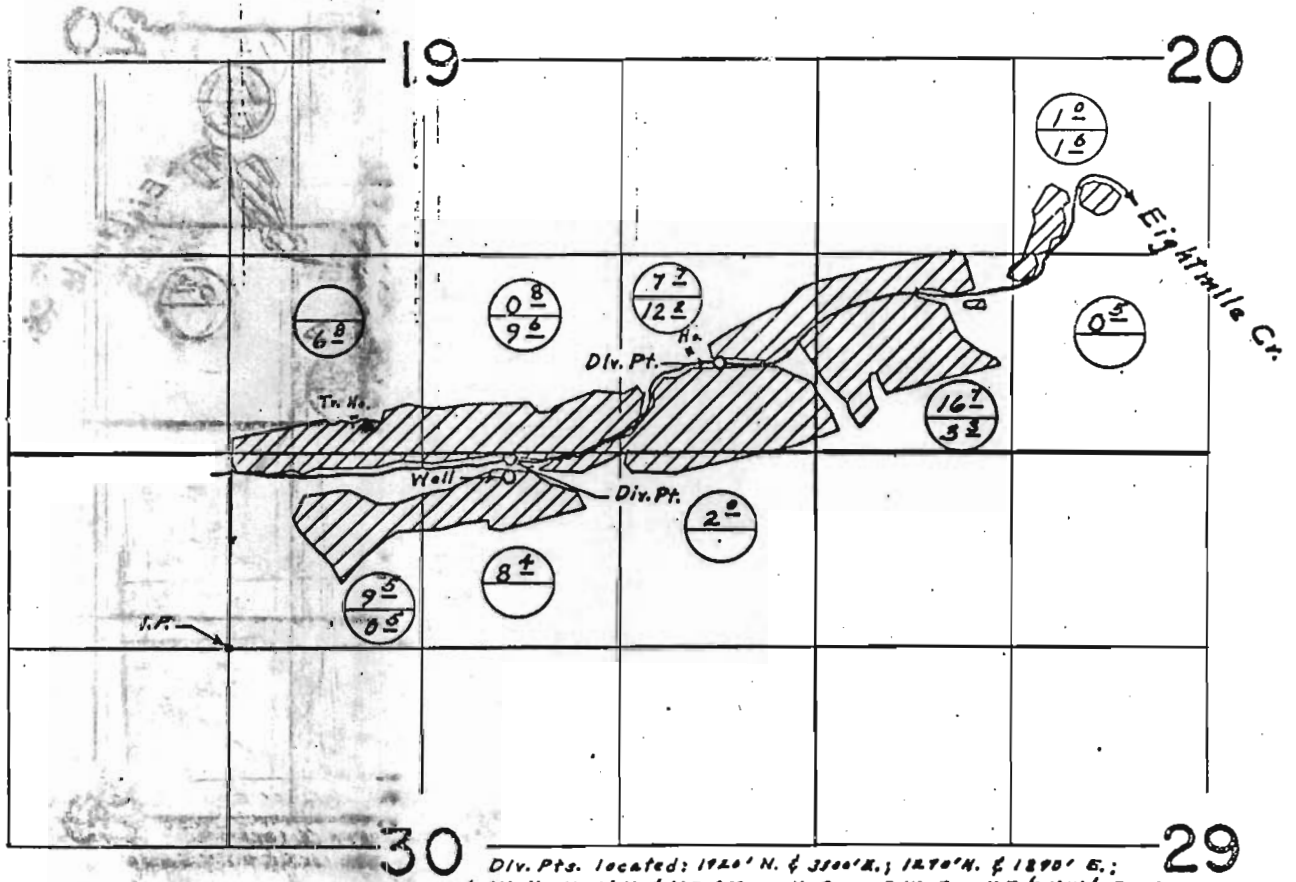

Div. Pts. located: 1920' N. & 3300' E.; 1270' N. & 1890' E.;
 Well, 1140' N. & 1870' E.; all from S.W. Cor. N.E. $\frac{1}{4}$ N.W. $\frac{1}{4}$ Sec. 30

Permit No. 33396
 Certificates 4859 & 5682
 4860

FINAL PROOF SURVEY UNDER

G-4378 G-4130
 Application No. 44644 Permit No. 33396
 IN NAME OF
 FERRE W. CAROTHERS &
 THE ESTATE OF THEORA E. CAROTHERS

Surveyed Nov. 10, 1971, by L. E. Gould