

IMPORTANT
This Map for Assessment
and Taxation Purposes

SEC. 24 T9S R6W WM
POLK COUNTY

9.6.24

Scale 1" = 400'

S.W. CORNER
ANDREW J. WELCH
DLC NO. 41

N. CORNER
IRA A. HOOKER
DLC NO. 48

INT. CORNER
IRA A. HOOKER
DLC NO. 48

N. CORNER
IRA A. HOOKER
DLC NO. 48

INT. CORNER
DLC NO. 48

See Map 9.6.13

S.E. CORNER
DLC NO. 41

E.E. CORNER
DLC NO. 47

S.W. CORNER
DLC NO. 41

W.S.E. CORNER
DLC NO. 41

S.W. CORNER
DLC NO. 41

E.E. CORNER
JOHN ALDRIDGE
DLC NO. 47

S.W. CORNER
ANDREW J. WELCH
DLC NO. 41

INT. CORNER
IRA A. HOOKER
DLC NO. 48

W.S.E. CORNER
DLC NO. 41

INT. CORNER
DLC NO. 48

S.W. CORNER
DLC NO. 41

S.E. CORNER
DLC NO. 41

N.E. CORNER
DLC NO. 48

PARCEL 1
127.50 AC.
160.98 AC.

1997-0053

100
PARCEL 2
160.98 AC.

Canceled No.

100 T1
600

2-28

1994-0035

See Map 9.6.23

200
97.14 AC.

1000
02 AC.

N.E. CORNER
JOHN M. ZIMMER
DLC NO. 48

800
97.24 AC.

900
24.33 AC.

LOT 1
28.06 AC.

See Map 9.6.19

800

LOT 2 - 7.78 AC.

LOT 3
37.00 AC.

LUCKIAMUTE
RIVER

800

500
23.70 AC.

700
75.82 AC.

13-32

LOT 4
37.00 AC.

MAPLE GROVE
ROAD M-15

23 24
26 25

24 19
25 30

See Map 9.6.25

10/08/04

9.6.24

Lighthard

T.9S.R.6W.WM

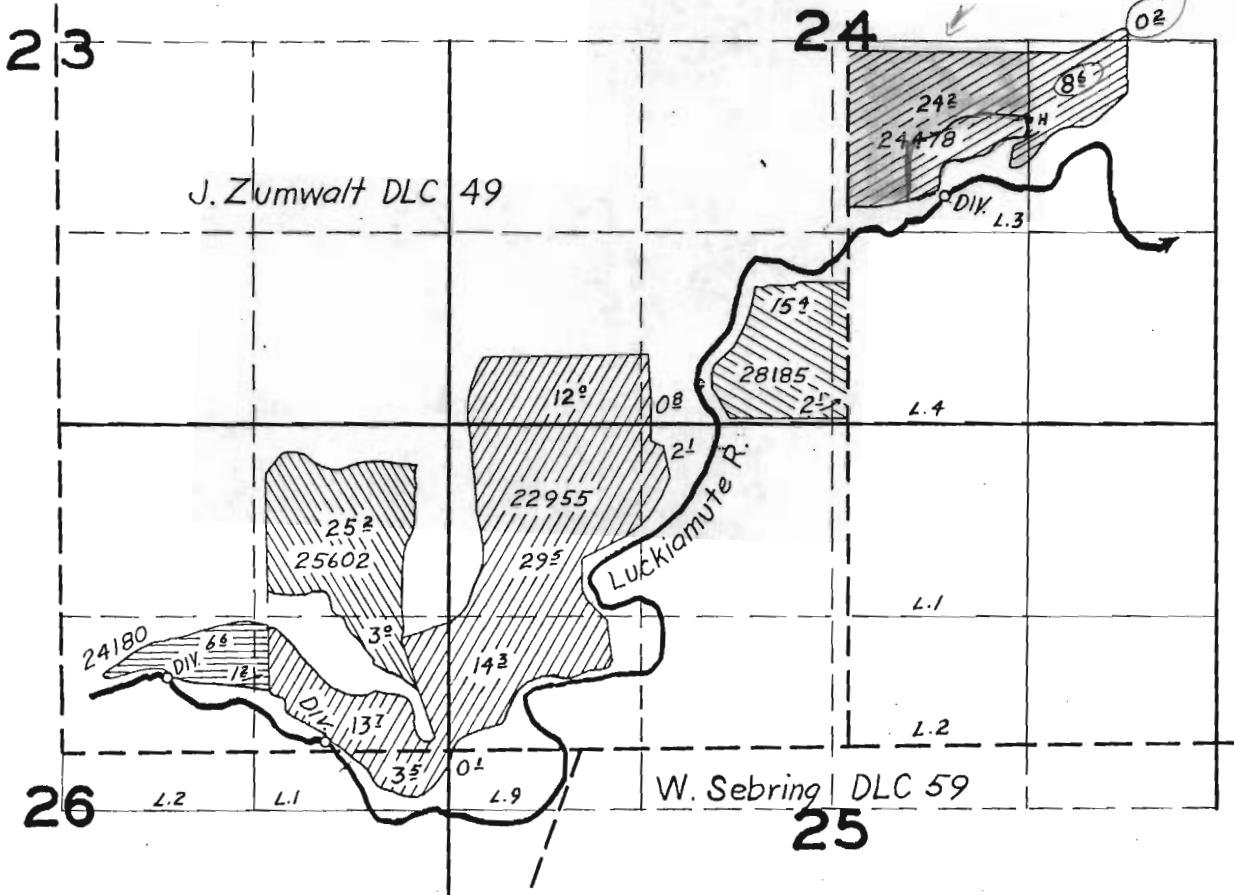

FINAL PROOF SURVEY

1" = 1320'

Application No.	24180	24478	25602	22955	28185	20015	19349	20089	18189	22641
	24180	24478	25602	22955	28185	20015	19349	20089	18189	22641

IN NAME OF

Hernan Amos, Kenneth L. Richards, E. M. Gates
E. M. Gates, E. M. Gates

Surveyed July 13-14 1954, by T. Jones