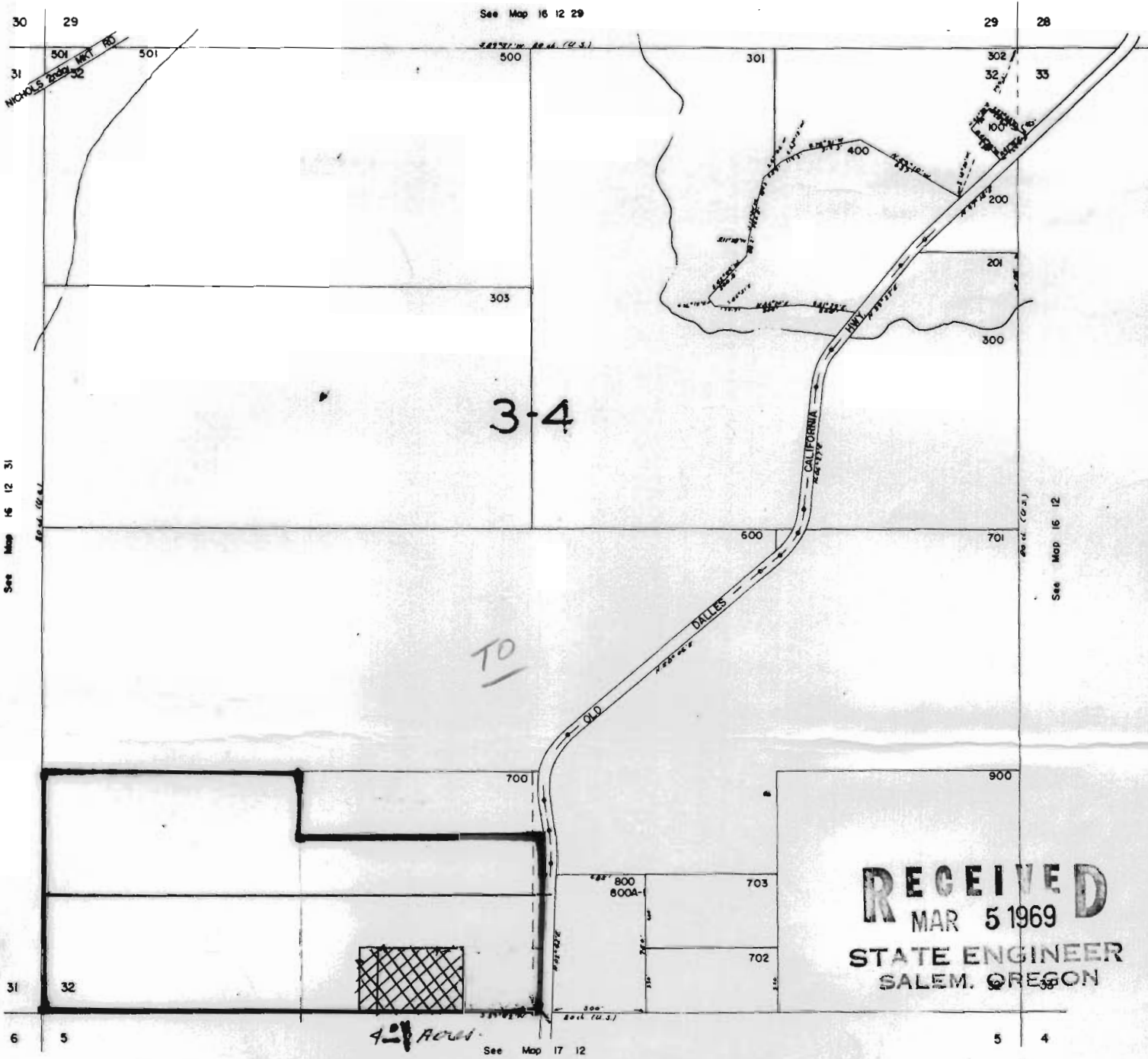

Exhibit "B"
Proposed use
site

16 12 32

Section 32, T.16 S. R.12 E. W.M.
DESCHUTES COUNTY
1" = 400'



RECEIVED
MAR 5 1969
STATE ENGINEER
SALEM, OREGON

Township 16 South, Range 12 East, W.M., Deschutes County, Oregon
Section 32: S $\frac{1}{2}$ SW $\frac{1}{4}$; and that portion of the SW $\frac{1}{4}$ SE $\frac{1}{4}$ lying westerly
from the westerly right of way line of the old Dalles-California
Highway: EXCEPTING THEREFROM the N $\frac{1}{2}$ N $\frac{1}{2}$ SE $\frac{1}{4}$ SW $\frac{1}{4}$ and that portion
of the N $\frac{1}{2}$ N $\frac{1}{2}$ SW $\frac{1}{4}$ SE $\frac{1}{4}$ lying westerly of the westerly right of way
line of the old Dalles-California highway, being 72 acres more or
less.

Point of Diversion:

RECEIVED
AUG 21 1968
STATE ENGINEER
SALEM, OREGON

RECEIVED
JAN 20 1969
STATE ENGINEER
SALEM, OREGON

RECEIVED
JUL 23 1968
STATE ENGINEER
SALEM OREGON

16 12 32