

# T.1&2S.R.2E.W.M.

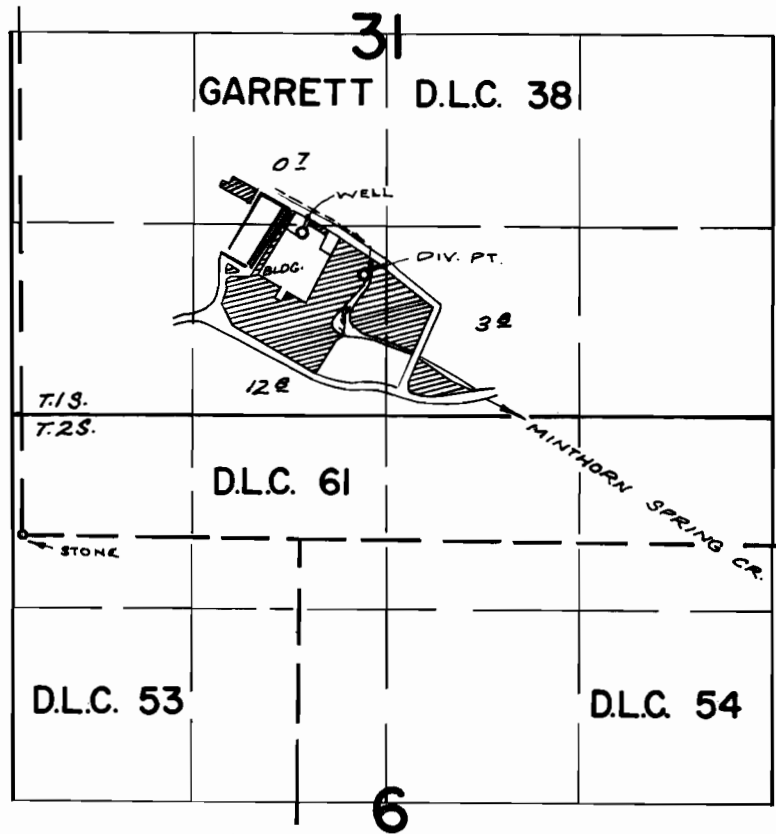

WELL LOC: 1900' E. & 2090' N. FROM S.W. COR. GARRETT D.L.C. 61  
 DIV. PT. LOC: 2340' E. & 1800' N. "

## FINAL PROOF SURVEY UNDER

TRANSFER No. 0-54  
 Application No. ~~G-3235~~ <sup>G-3041</sup> Permit No. ~~G-4547~~ <sup>G-4276</sup>  
 IN NAME OF

OMARK PROPERTIES, INC.

Surveyed Nov. 6, 1970, by L. E. GOULD.