

REVISIONS

N.W. 1/4 OF S.E. 1/4 SEC. 1 T.26S. R.3W. W.M.

ROCK CREEK HATCHERY

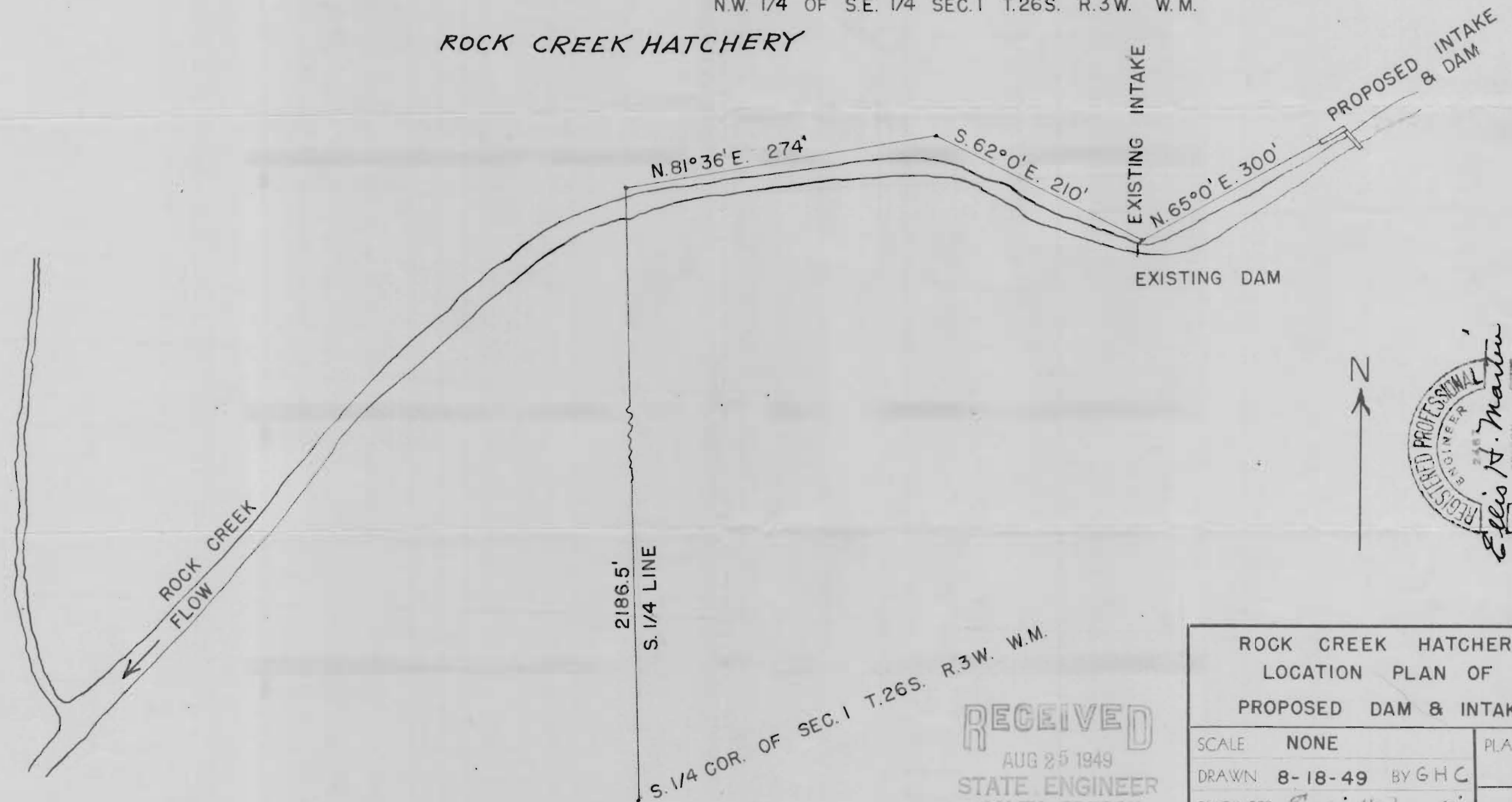

S. 1/4 COR. OF SEC. 1 T.26S. R.3W. W.M.

RECEIVED
AUG 25 1949
STATE ENGINEER
SALEM, OREGON

ROCK CREEK HATCHERY LOCATION PLAN OF PROPOSED DAM & INTAKE		PLATE	OF
SCALE	NONE		
DRAWN	8-18-49 BY G.H.C.		PLATES
ENGINEER	<i>Ellis H. Martin</i>	B637	
CHECKED			
APPROVED			