

T.17S., R.12E., W.M.

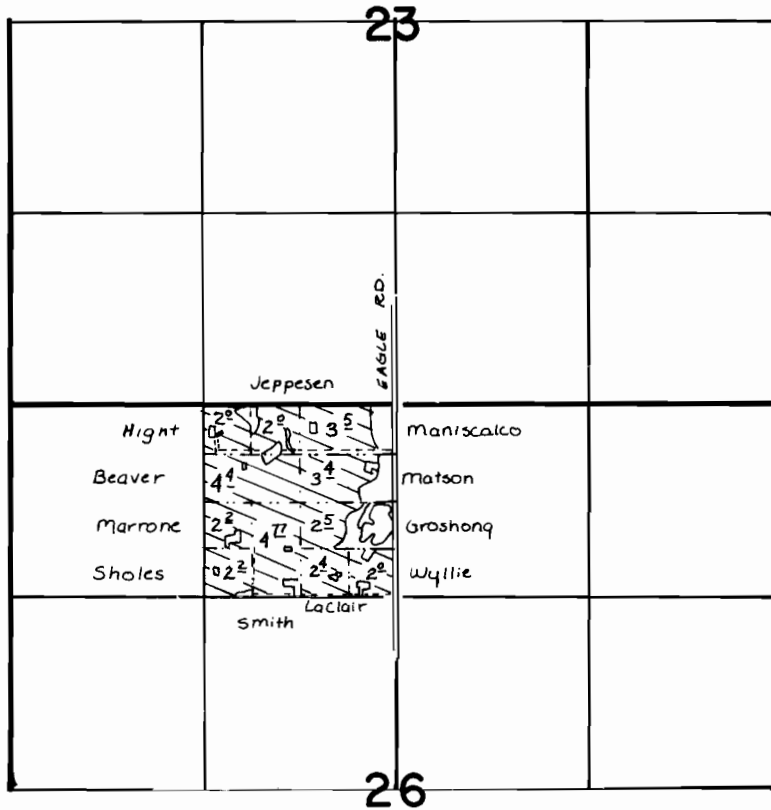

SCALE: 1" = 1320'

FINAL PROOF SURVEY UNDER

Transfers K-36,
P-63, N-27

IN NAME OF

SHOLES, et. al.

Surveyed MAY 3, 1966, by W.J. RUPPERT

T.14S.R.13E. W.M.

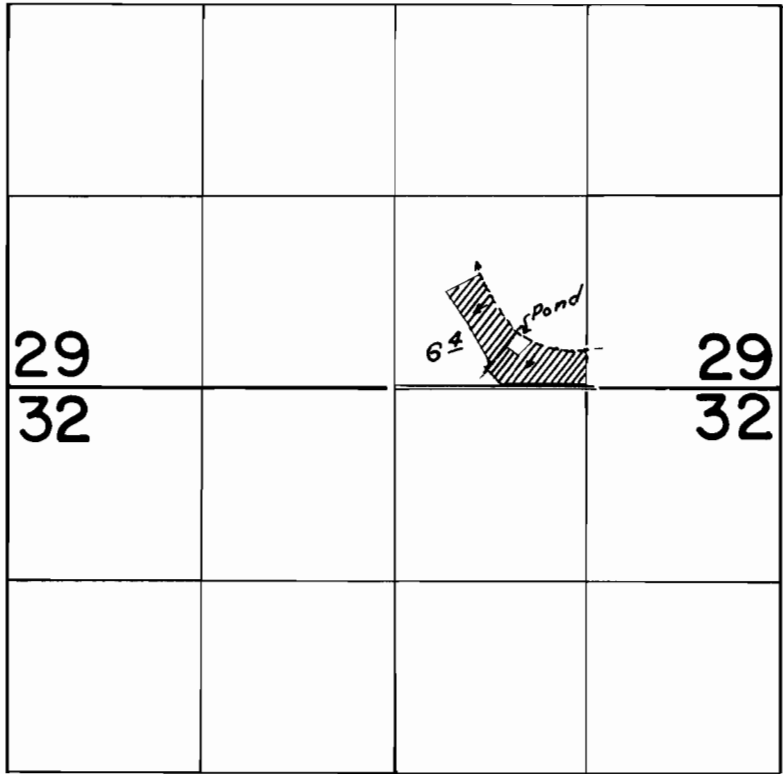

Surveyed on 1964
for transfer 4-8
(copy of F.P. attached)
The townfield is still
as shown on this
survey. Excess 29 is
under 4-8. LGO

FINAL PROOF SURVEY
UNDER

Transfer No. P-63
Application No. Permit No.

IN NAME OF
GEORGE RAU

Surveyed August 25, 1965., by *Clyde J. Landrum*