

T. 1 S. R. 8 W. W. M. .

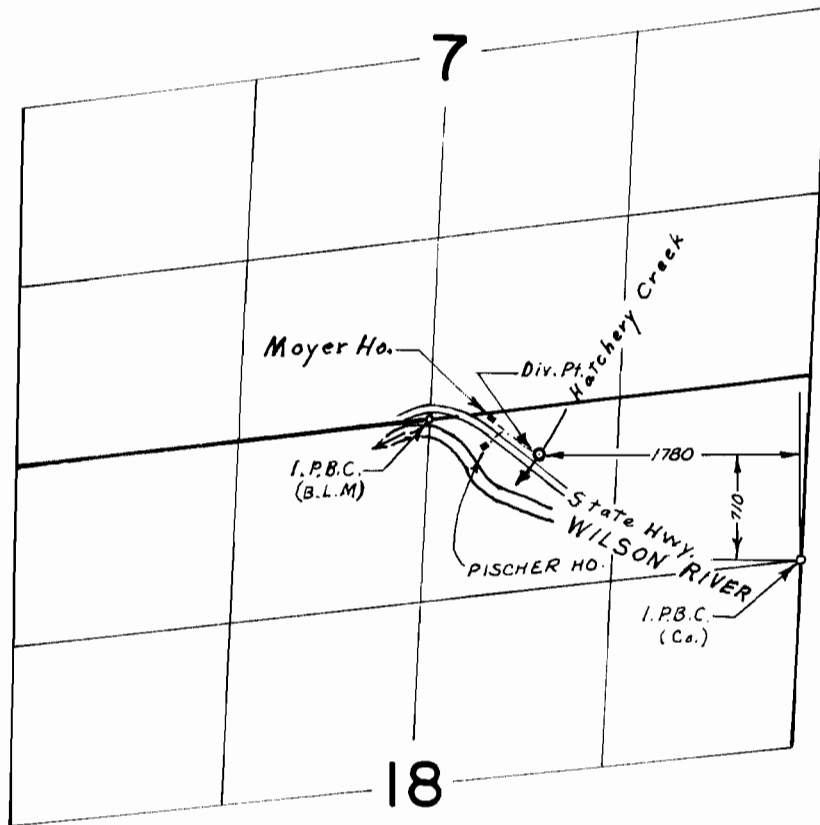

FINAL PROOF SURVEY
UNDER

Application No. _____ Transfer R-64
Permit No. _____
IN NAME OF

NELLIE M. REEHER

Surveyed June 12, 1964, by M. BISH
JUNE 11, 1971 L.E. GOULD
SEPT. 12, 1974 R. MUCKEN