

# T.36S.R.1E.W.M.

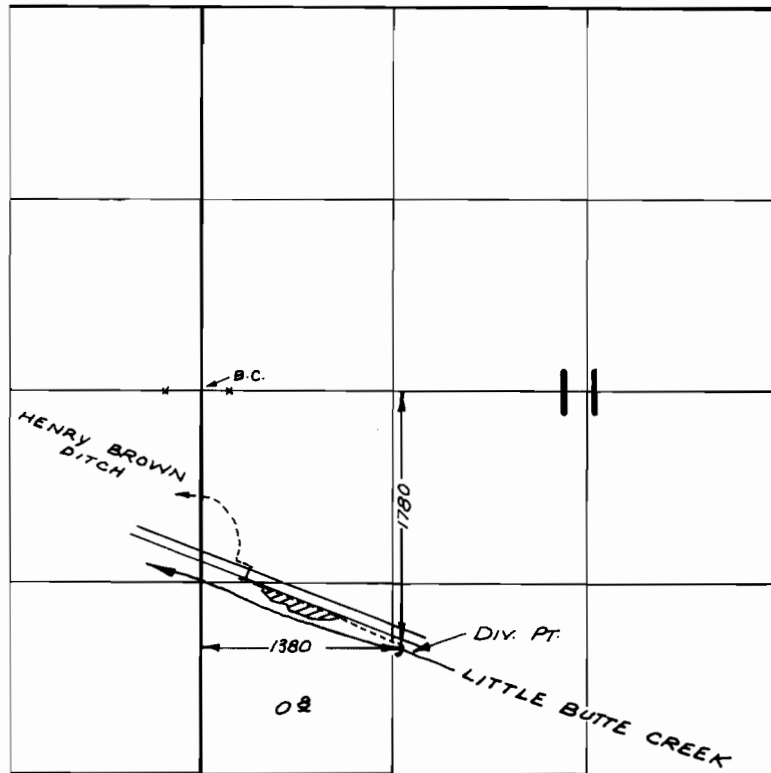

## FINAL PROOF SURVEY UNDER

TRANSFER NO. S-193  
Application No. .... Permit No. ....

IN NAME OF

CHARLES STANLEY,  
MRS. DOROTHY M. PERRY & LEON G. STANLEY

Surveyed JUNE 5, 1974., by R. MUCKEN...

# T.36S.R.1E.W.M.

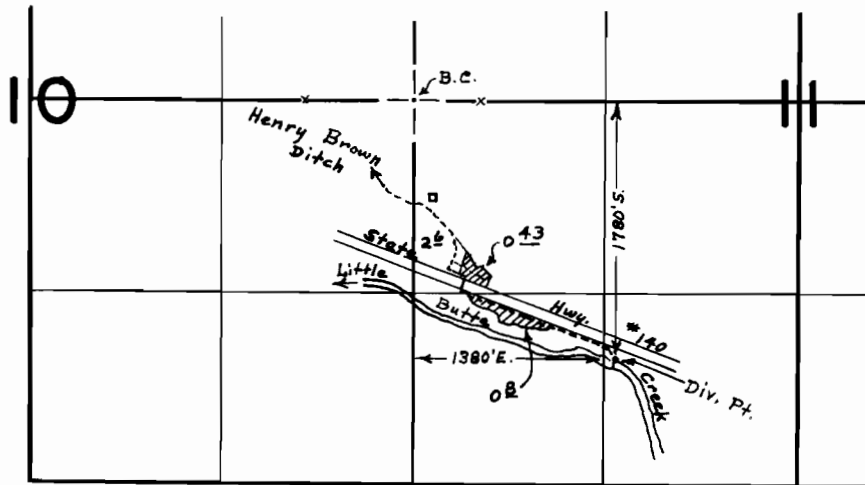

## FINAL PROOF SURVEY UNDER

Transfer No. S-193

Application No. \_\_\_\_\_

IN NAME OF

Charles Stanley

Mrs. Dorothy M. Perry & Leon G. Stanley

Surveyed June 5, 1974 by R. Mucken

& Sept. 4, 1975 - D. Hendrix