

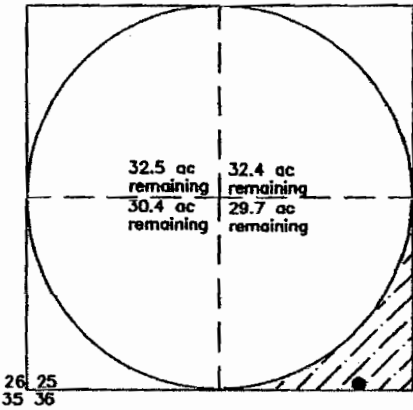

MAP TO ACCOMPANY APPLICATION  
FOR A TEMPORARY WATER RIGHT TRANSFER  
RICHARD C. SMITH

AUTHORIZED PLACE OF USE  
SW 1/4 SECTION 25  
T26S R18E WM  
LAKE COUNTY, OREGON  
TAX LOT 7700  
Permit G-10703 Certificate 75867



Authorized POA (well) is located 30' North and 3000' West of the SE Section Corner Section 25 (SE1/4 SW1/4)

 10.3 ac to transfer from P G-10703 C 75867

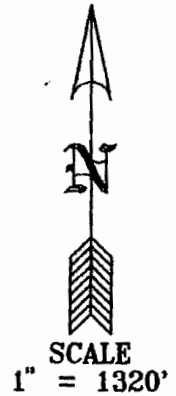

PROPOSED PLACE OF USE  
NW 1/4 SECTION 8  
T27S R19E WM  
LAKE COUNTY, OREGON  
TAX LOT 700

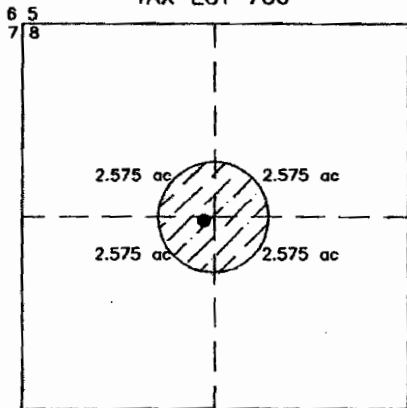

Proposed POA (well) is 1330' South and 1305' East of the NW Section Corner of Section 8 (SW1/4 NW1/4)

 10.3 ac to transfer to

**RECEIVED**  
JUL 18 2003  
WATER RESOURCES DEPT  
SALEM, OREGON

*Carl E. Sundet*  
#127  
Carl E. Sundet  
Nov. 19, 1987  
STATE OF OREGON

*Renews 6/30/02  
T-9503*

PREPARED BY: SUNDET & ASSOCIATES  
P.O. BOX 1228  
LAKEVIEW, OR 97630  
541-947-3293  
DRAWING #14902

APRIL 2002