

RECEIVED

JUL 17 2003

WATER RESOURCES DEPT
SALM, OREGON

MAP 1 of 3

1" = 1320'

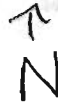

LEWIS & JAMES
36 40 HILL
CERT No. (S25.5)
52-1881
102-1887
Harlan Sanders

PO FARMS
37 1870
Lum Ditches &
Sloughs
(C-52516)
37 1881
Harlan Sanders
(C-52516)

Wm. LEWIS

ODF Will

40 1893

40 1893 40 18
Jacobson & Jacobson
Harlan Sanders Harlan
C-1484 Sanders

RONNEY & HOLLY
COLEMAN

40 1893
Jacobson & Harlan Sanders
C-1493

ALVA & SUSAN

40 1893
Jacobson & Harlan Sanders
C-1493

39 1893 40
Jacobson & Harlan Sanders
C-1484

MARTHA JANE
SPRATLING

40
CERT. No. 1511
20 Dec 1888 Kelsey Wilson
31 Dec 1889 Smith McPhee Tanner
15 Dec 1890 McPhee

40 40
38 5
CERT. No
150 Dec
256

40 1892 40 1892
Smith McPhee Tanner
C-1525

40 1892 40 1892
Smith McPhee Tanner
C-1525

6S 39E
WILLIAM
SANDRA
MCGINN 7S 39E

5E 11
DOUG & JAN
STANFORD

1896 22 E 1902 24 E 1902
Kelsey Wilson Kelsey Wilson
C-5053

1902 11 E 1902
Kelsey Wilson Kelsey Wilson
C-5053

40 1895 17 1895
Smith McPhee Tanner
40 20

40 1893 39 1893
Smith McPhee Tanner
C-5053

19 E
GARY & ELIZ
26 E

ARTHUR LYMAN
40 1893 40 1893
Smith McPhee Tanner

KRAMER

T-9502

7.5 →

Louis Dalton

RECEIVED

JUL 17 2003

WATER RESOURCES DEPT
SALEM, OREGON

MAP 2 of 3

TO MAP

1" = 1320'



BINGHAM

35 1898 34 18

Carnes, Love Pins T-6218
Carnes, Love Pins T-6218

31 1871
CART. No. 64971
80 1887
42 1902
DAVIS KELSEY

27 1880
Sunnyslope
C-64971

35 1879
Sunnyslope
C-1470

MICHELLE RENE JOMELLE
Kelsey

8 1883
Beatty
C-64971

38 1888
DAVIS DALTON
C-64971

RONALD CARDIN
37 Young's

38 1888
DAVIS DALTON
C-64971

38 1888
DAVIS DALTON
C-64971

38 1888
DAVIS DALTON
C-64971

38 1888
DAVIS DALTON
C-64971

38 1888
DAVIS DALTON
C-64971

JOHN & GEORGE
38 40

872 5 1869
Daley C-1506

1867 40 1869
Daley C-1506

34 1887
DAVIS KELSEY
C-1456

30 1887
DAVIS KELSEY
C-1456

37 1874
DAVIS DALTON
C-1456

40 1874
DAVIS DALTON
C-1456

40 1874
DAVIS DALTON
C-1456

40 1874
DAVIS DALTON
C-1456

40 1874
DAVIS DALTON
C-1456

40 1874
DAVIS DALTON
C-1456

28 1902
HUTCHINSON HILLSIDE
C-1471

31 1902
HUTCHINSON HILLSIDE & GARDNER MILLRACE
C-1471

31 1902
HUTCHINSON HILLSIDE & GARDNER MILLRACE
C-1471

31 1902
HUTCHINSON HILLSIDE & GARDNER MILLRACE
C-1471

31 1879
Bulger C-1469

31 1879
Bulger C-1469

DAVIS KELSEY DITCH

DAVIS KELSEY DITCH

DAVIS DALTON

DAVIS DALTON

DAVIS DALTON

DAVIS DALTON

DAVIS DALTON

DAVIS DALTON

DAVIS DALTON

GARDNER MILLRACE

GARDNER MILLRACE

GARDNER MILLRACE

GARDNER MILLRACE

GARDNER MILLRACE

GARDNER MILLRACE

18 1887
DAVIS KELSEY
C-1456

32 1887
DAVIS KELSEY
C-1456

42 1879
Sunnyslope
C-1470

42 1879
Sunnyslope
C-1470

42 1879
Sunnyslope
C-1470

42 1879
Sunnyslope
C-1470

42 1879
Sunnyslope
C-1470

42 1879
Sunnyslope
C-1470

42 1879
Sunnyslope
C-1470

42 1879
Sunnyslope
C-1470

42 1879
Sunnyslope
C-1470

42 1879
Sunnyslope
C-1470

42 1879
Sunnyslope
C-1470

42 1879
Sunnyslope
C-1470

42 1879
Sunnyslope
C-1470

16 1887
DAVIS KELSEY
C-1456

40 1887
DAVIS KELSEY
C-1456

40 1887
DAVIS KELSEY
C-1456

40 1887
DAVIS KELSEY
C-1456

40 1887
DAVIS KELSEY
C-1456

40 1887
DAVIS KELSEY
C-1456

40 1887
DAVIS KELSEY
C-1456

40 1887
DAVIS KELSEY
C-1456

40 1887
DAVIS KELSEY
C-1456

40 1887
DAVIS KELSEY
C-1456

40 1887
DAVIS KELSEY
C-1456

40 1887
DAVIS KELSEY
C-1456

40 1887
DAVIS KELSEY
C-1456

40 1887
DAVIS KELSEY
C-1456

40 1887
DAVIS KELSEY
C-1456

7 1887
DAVIS KELSEY
C-1456

1 1887
DAVIS KELSEY
C-1456

29 1879
Sunnyslope
C-1470

37 1879
Sunnyslope
C-1470

37 1879
Sunnyslope
C-1470

37 1879
Sunnyslope
C-1470

37 1879
Sunnyslope
C-1470

37 1879
Sunnyslope
C-1470

37 1879
Sunnyslope
C-1470

37 1879
Sunnyslope
C-1470

37 1879
Sunnyslope
C-1470

37 1879
Sunnyslope
C-1470

37 1879
Sunnyslope
C-1470

37 1879
Sunnyslope
C-1470

37 1879
Sunnyslope
C-1470

1 1887
DAVIS KELSEY
C-1456

40 1887
DAVIS KELSEY
C-1456

40 1887
DAVIS KELSEY
C-1456

40 1887
DAVIS KELSEY
C-1456

40 1887
DAVIS KELSEY
C-1456

40 1887
DAVIS KELSEY
C-1456

40 1887
DAVIS KELSEY
C-1456

40 1887
DAVIS KELSEY
C-1456

40 1887
DAVIS KELSEY
C-1456

40 1887
DAVIS KELSEY
C-1456

40 1887
DAVIS KELSEY
C-1456

40 1887
DAVIS KELSEY
C-1456

40 1887
DAVIS KELSEY
C-1456

40 1887
DAVIS KELSEY
C-1456

40 1887
DAVIS KELSEY
C-1456

RILEY 35

HUTCHINSON HILLSIDE
SANDOVER MILLRACE

ALQUETINE FRITZ
HUTCHINSON HILLSIDE

EX Sec 1

LOUIS & MARIE MARKS

1

ARTHUR & JULIE LYMAN
1950

DANIEL & MARY ARRITOLA

JOHN & GEORGE

Creek

ROCK STAMP

Bulger C-1469

Anthony Lakes Quadrangle Map
T-7S
R-37E
UNSURVEYED LAND

Point of Diversion MAP 30f3

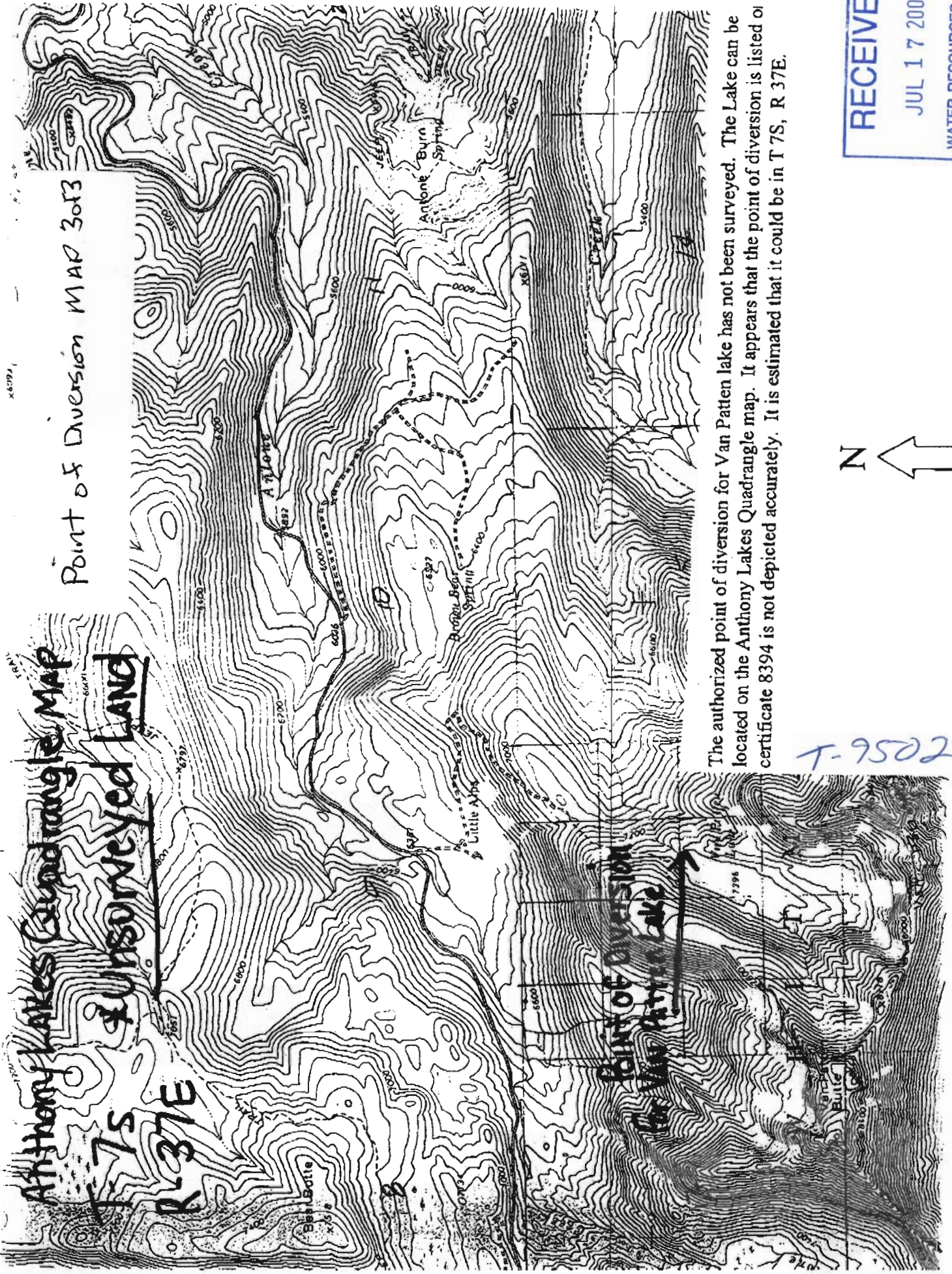

The authorized point of diversion for Van Patten lake has not been surveyed. The Lake can be located on the Anthony Lakes Quadrangle map. It appears that the point of diversion is listed on certificate 8394 is not depicted accurately. It is estimated that it could be in T 7S, R 37E.

T-9502



RECEIVED
JUL 17 2003
WATER RESOURCES DEPT
SALEM, OREGON