

SW 1/4 S10, T4N, R37E, WM

T-8474

RECEIVED

MAR 31 2000

WATER RESOURCES DEPT.
SALEM, OREGON

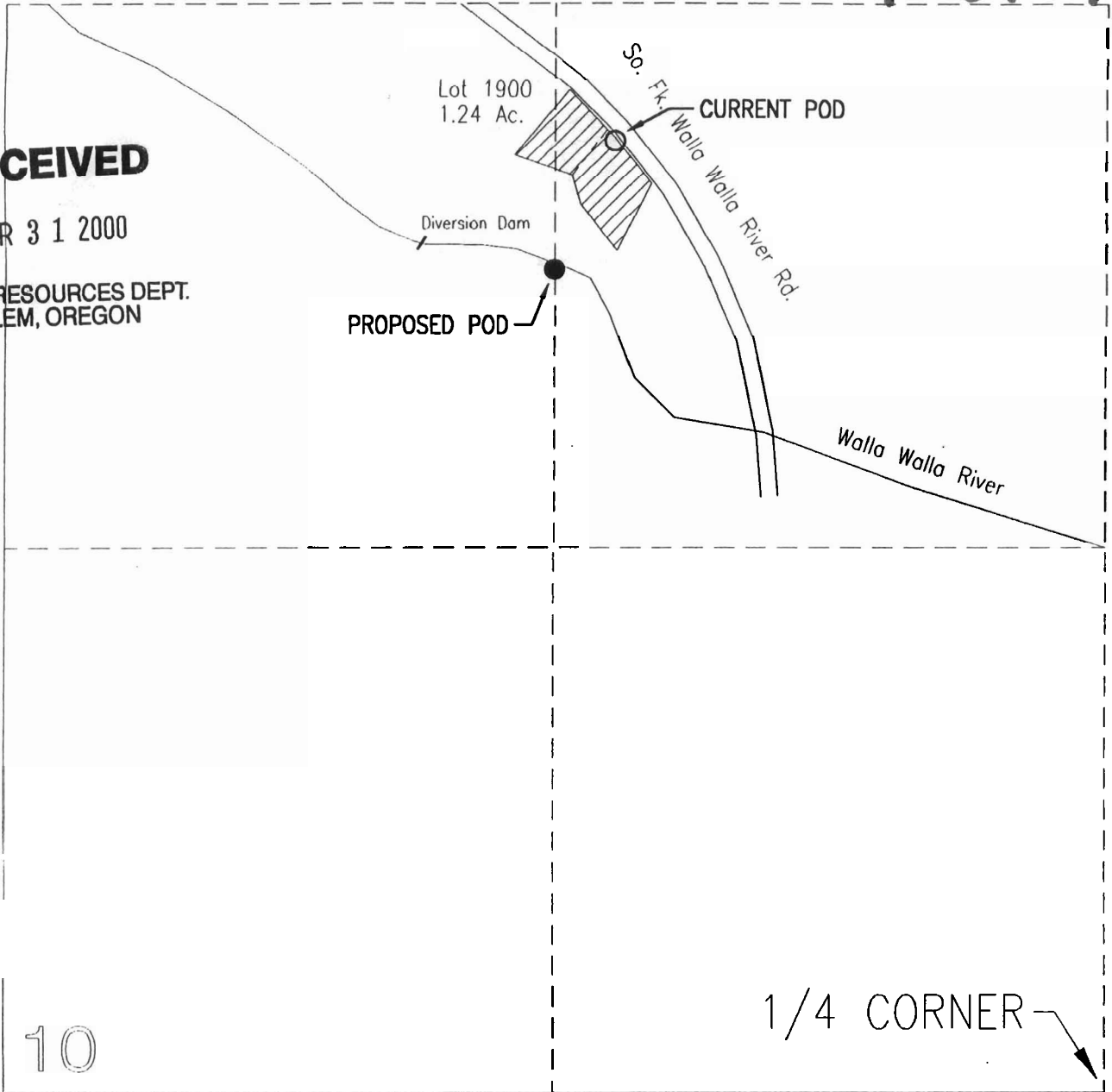

9 10

16 15

1/4 CORNER

○ CURRENT POD is located 360 feet South and 164 feet East of NE corner of NW1/4 of SW1/4 of Section 10, Township 4 North, Range 37 East, WM

PROPOSED CONDITIONS:

● PROPOSED POD is located 660 feet South of NE corner of NW1/4 of SW1/4 of Section 10, Township 4 North, Range 37 East, WM

1.24 acres served by pump located at PROPOSED POD.
0.17 acres located in NW1/4 of SW1/4 Section 10.
1.07 acres located in NE1/4 of SW1/4 Section 10.



SCALE: 1 in = 400 ft

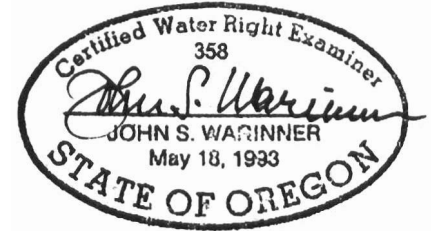
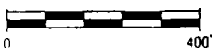

APPLICATION MAP
Transfer of Point of Diversion

Project Name:
Keith Pratt
Milton-Freewater, OR

Date:
22 November 99



Fountainhead
Irrigation, Inc.

PO Box 2197 Walla Walla, WA 99362
Phone (509) 529-2646 Fax (509) 522-5251

IN THE NAME OF
Keith Pratt
78796 S. Fork Walla Walla River Rd.
Milton-Freewater, OR 97862