

2003 WESTLAND IRRIGATION DISTRICT  
 540.580 TRANSFER, PRIOR TO PRIOR  
 April 22, 1955, Cert. 76050 Primary; &  
 Cert. 75129 & Permit 48450 Supplementals.

T3N., R28E., W.M.

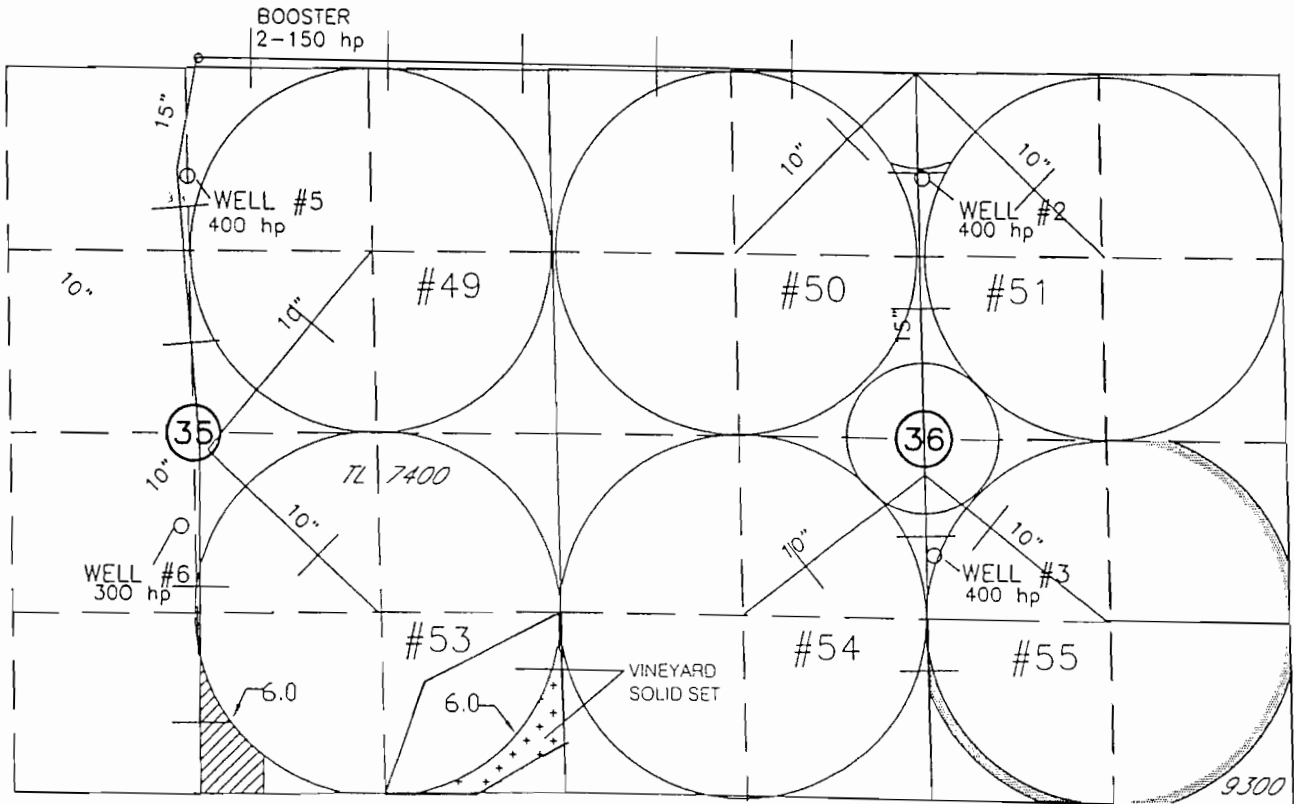

T3N., R 29E., W.M.

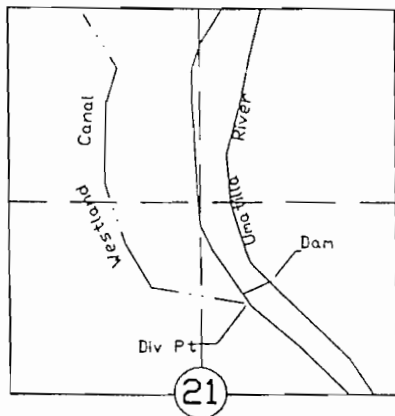

Authorized wells for cert. #75129 are located as follows:

- Well 2 - 750' S & 2620' W from NE corner section 36
- Well 3 - 1780' N & 2600' W from SE corner section 36
- Well 5 - 770' S & 2640' E from NW corner section 35
- Well 6 - 1940' N & 2540' E from SW corner section 35

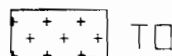

**RECEIVED**  
 OCT 02 2003  
 WATER RESOURCES DEPT  
 SALEM, OREGON



SCALE IN FEET

Authorized P.O.D. Cert. 75050 DIV PT LCT N. 76°45'56"E. 2913.19'  
 From W.1/4 Cor. Sec. 21

Authorized P.O.D. Permit 48450 DIV PT LCT S55°48' W 3237.3' From  
 NE Cor. Sec. 21  
 WESTLAND IRRIGATION DISTRICT

NOTE: THE PURPOSE OF THIS MAP IS TO IDENTIFY THE APPROXIMATE LOCATION  
 OF THE WATER RIGHT. IT IS NOT INTENDED TO PROVIDE INFORMATION  
 RELATIVE TO THE LOCATION OF PROPERTY OWNERSHIP BOUNDARY LINES.

T-9591