

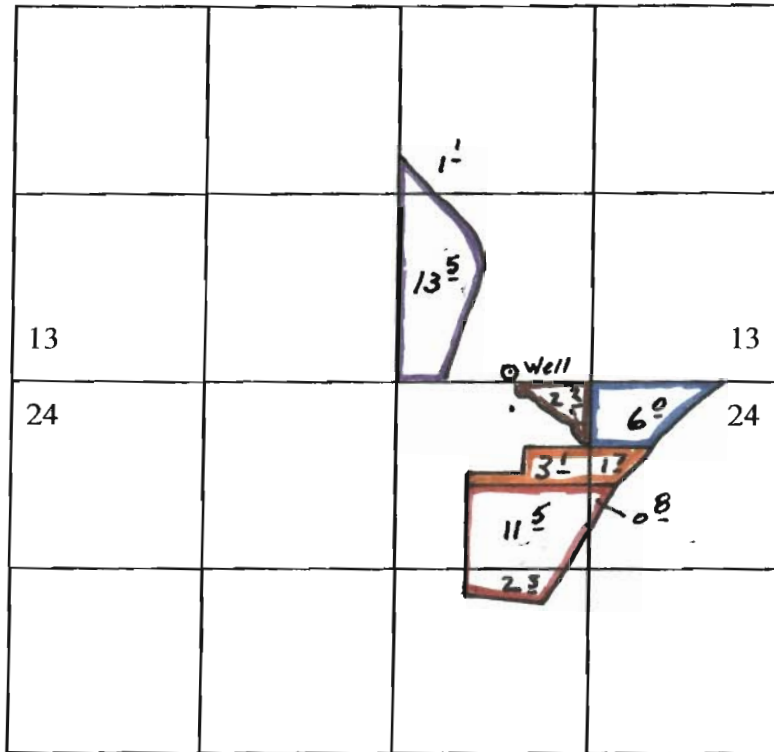



T 39 S, R 19 E

"From"





SCALE - 1" = 1320'

To be transferred "from" "temporary"

-  - C 76187 - Lakeview water users
-  - P-4743 c# 40196
-  - P-4330 c# 22861

TO Remain in Place

-  - P- G- 4743 c# 40196
-  - P- 4-330 c# 22861

RECEIVED
 NOV 26 2003
 WATER RESOURCES DEPT.
 SALEM, OREGON

T-9606



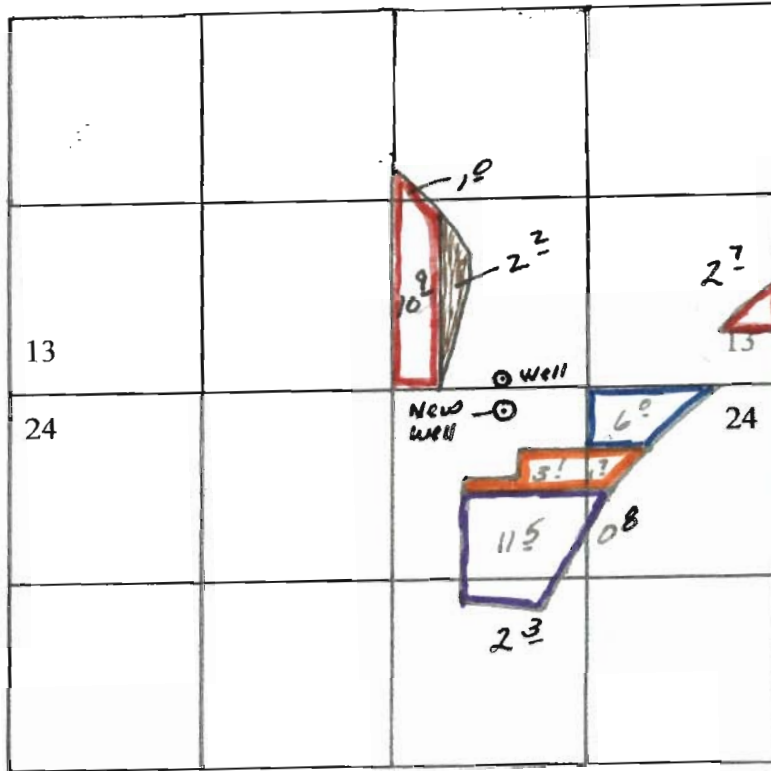

T 39 S, R 19 E

"TO"



SCALE - 1" = 1320'

To be Transferred "To" Temporary

-  > P.O.A. change ONLY Permits G-4743, 4530
-  - Primary - Permit G-4743
-  - Primary - Permit G-4743
-  - Primary - Certificate 76187, Lakeview Water users INC.
-  - Primary Permit - U-330

T-9606

RECEIVED
 NOV 26 2003
 WATER RESOURCES DEPT.
 SALEM, OREGON