

T.2S, R.2E, W.M. - Clackamas County, Oregon

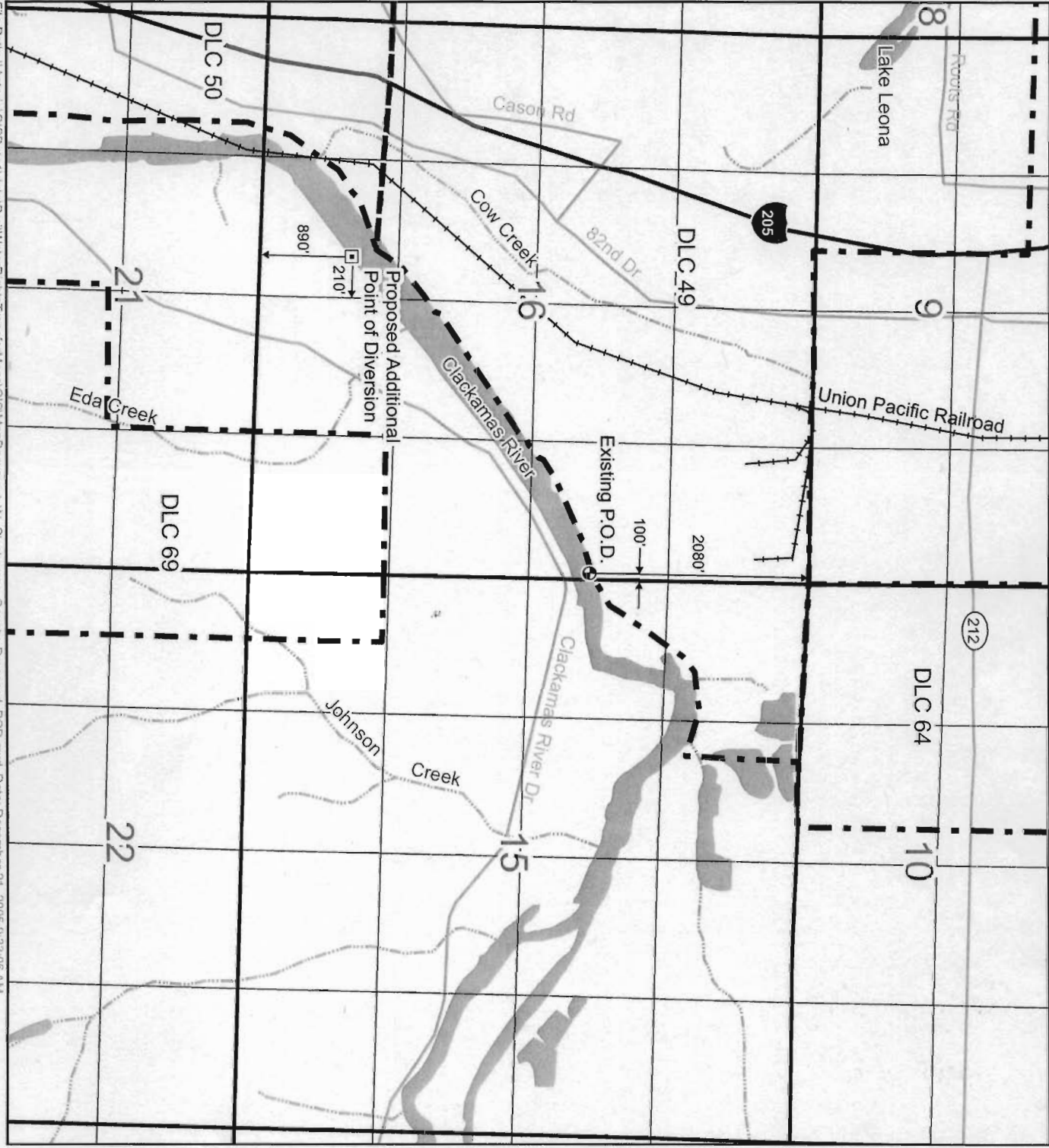

North Clackamas  
County Water  
Commission

Proposed Additional  
Point of Diversion

Legend

- New P.O.D.
- ⊕ Existing P.O.D.
- Railroads
- Freeways
- Highways
- Large Water Bodies
- Perennial Streams
- PLSS 1/4 1/4 Sections
- DLC

RECEIVED  
JAN 26 2006  
WATER RESOURCES DEPT  
SALEM, OREGON



NOTE: This map was prepared for the purpose of identifying the location of water rights only and is not intended to provide legal dimensions or locations of property ownership lines.

