

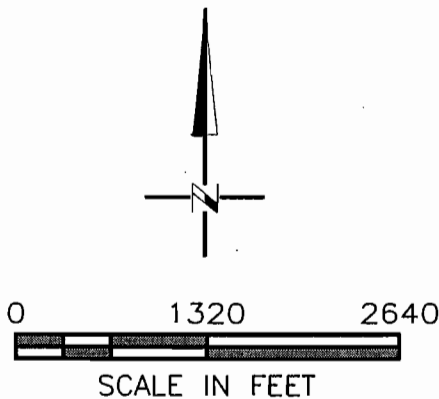

CHANGE IN POINT OF DIVERSION
 TRANSFER APPLICATION MAP
 FOR
 MAURA Q McCABE
 INVOLVING PART OF CERT 1771
 T6N, R35E WM

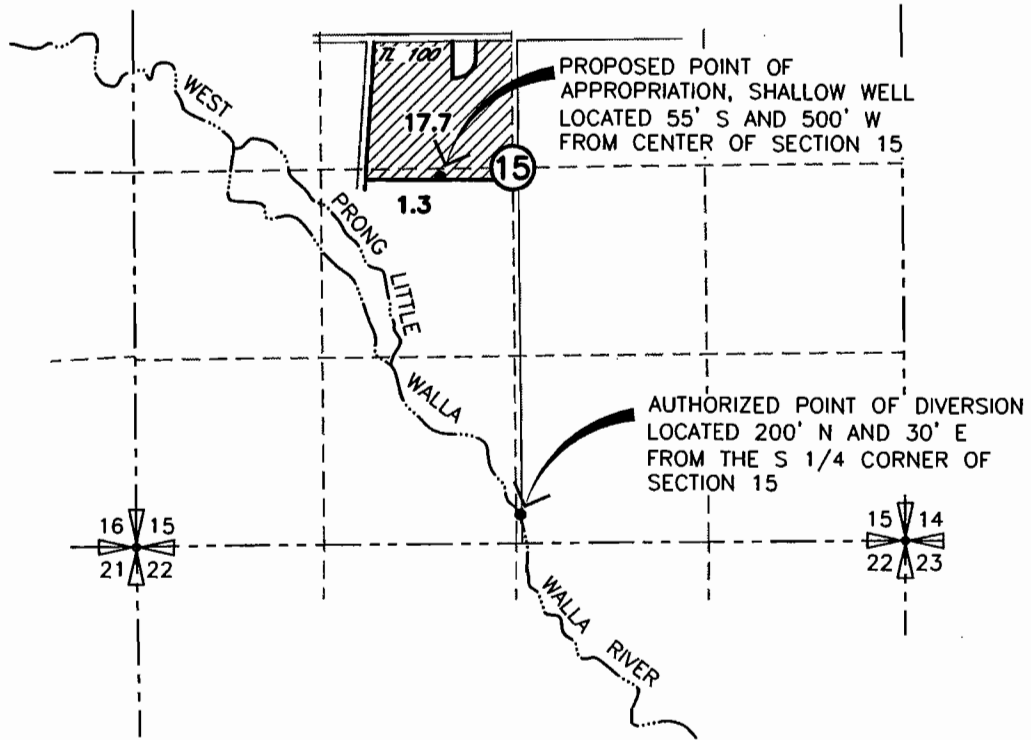

 19ac AREA INVOLVED BY
 P.O.D. TRANSFER

Certified Water Right Examiner
 #333 WRE
Dale G. VanScherack
 Dale G. VanScherack
 May 19, 1992
 11/17/03
 STATE OF OREGON

RECEIVED

FEB 12 2004

WATER RESOURCES DEPT
 SALEM, OREGON

11/18/03

DRAWING: H:\CAD\AG\3522\179\3522179T03.dwg
 PRINTED BY: rogerw on 11/18/03 06:44 AM

T-9648

NOTE:
 THE PURPOSE OF THIS MAP IS TO IDENTIFY THE APPROXIMATE LOCATION
 OF THE WATER RIGHT. IT IS NOT INTENDED TO PROVIDE INFORMATION
 RELATIVE TO THE LOCATION OF PROPERTY OWNERSHIP BOUNDARY LINES.

 **SCM** Consultants, Inc.
 A Tetra Tech Company