

T. 3 N. R. 29 E. W.M.

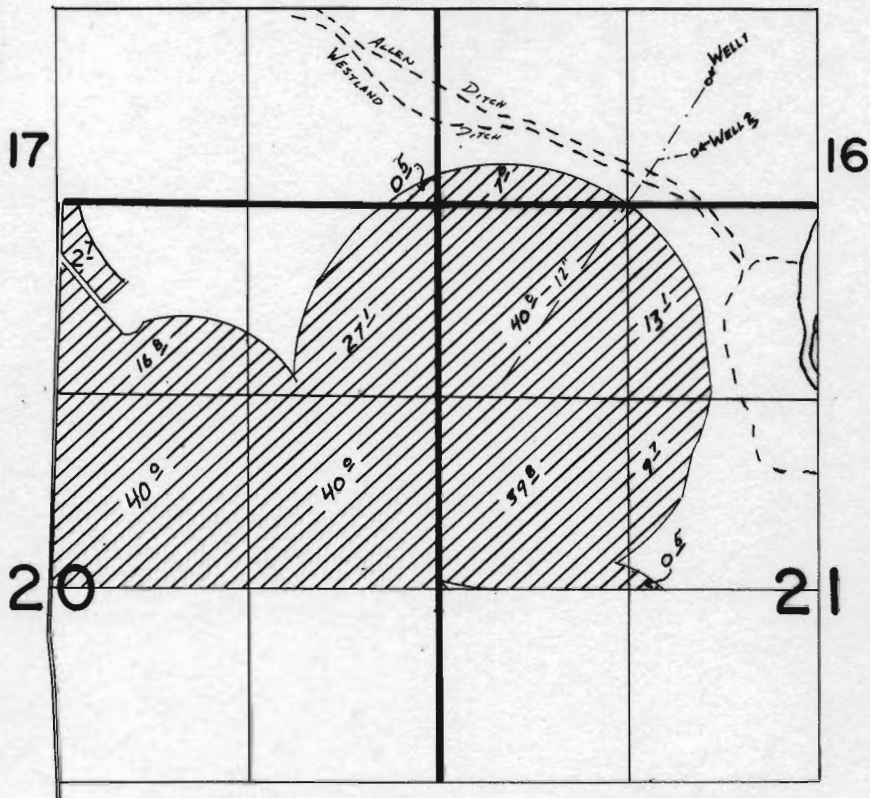

WELL NO. 1 LOCATED 850' NORTH AND 750' WEST FROM SOUTH 1/4 COR. SEC. 16
WELL NO. 3 LOCATED 350' NORTH AND 850' WEST FROM SOUTH 1/4 COR. SEC. 16

FINAL PROOF SURVEY UNDER

Application No. **G-7125**.. Permit No. **G-6339**....
IN NAME OF

.....**Chester J. Prior et al.**.....

Surveyed **AUGUST 18**.... 19**83**.., by **V.L. CHURCH**.....