

NOTE: The preparation of this map was for the purpose of identifying the location of the proposed water right and has no intent to provide dimensions or location of property ownership lines. Location information shown hereon was furnished by the applicant.

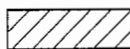
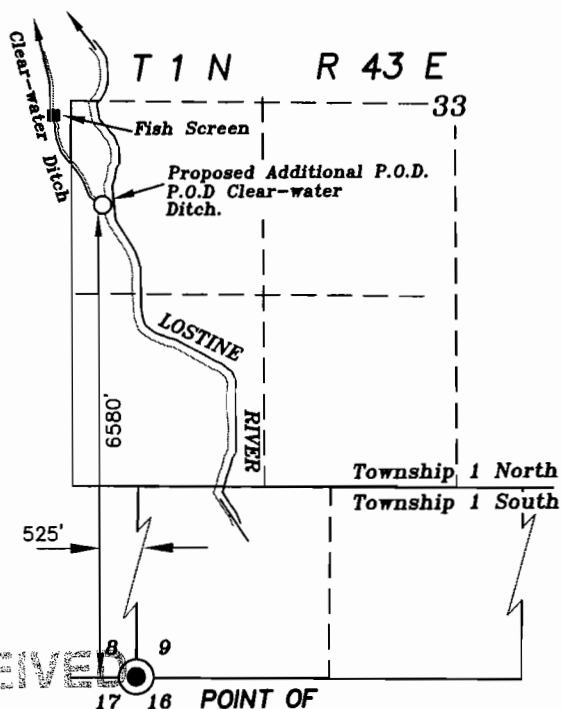

Lands under Certificate #3922 requesting additional Point of Diversion.

April 29, 2004

APPLICATION MAP FOR
ADDITIONAL POINT OF DIVERSION
FOR
WOODY WOLFE

BY
BAGETT - GRIFFITH & BLACKMAN
2006 ADAMS AVENUE
LAGRANDE, OREGON 97850

Application No. _____

Permit Number _____

RECEIVED

MAY 06 2004

POINT OF DIVERSION FOR CLEAR-WATER DITCH