

RECEIVED

JUN 18 2004

# T.5S. R.1W. Section 22

WATER RESOURCES DEPT  
SALEM, OREGON



EXPIRATION DATE 6/30/05

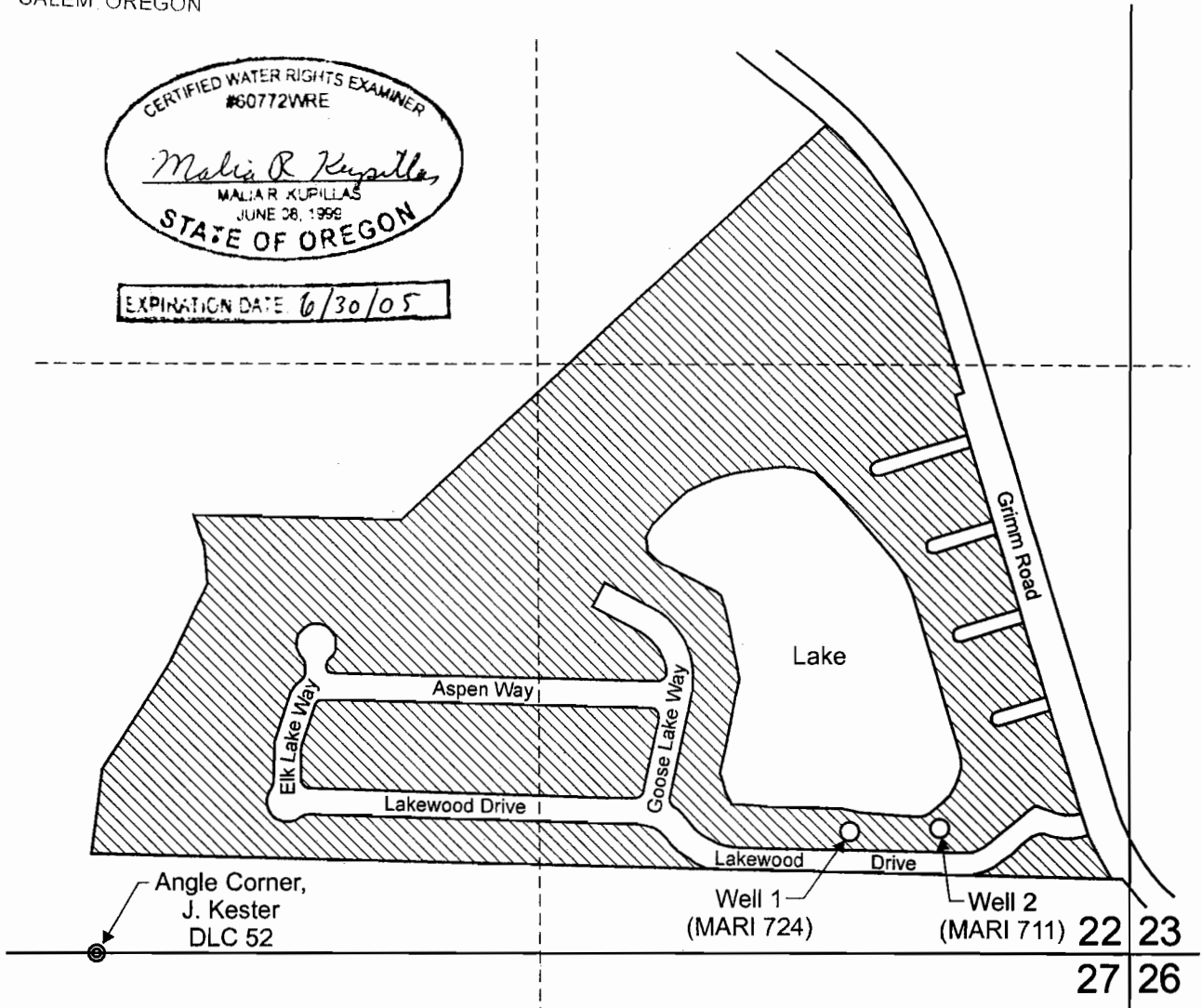

Well 1 is located 270 feet north and 630 feet west from the SE corner of Section 22

Well 2 is located 280 feet north and 420 feet west from the SE corner of Section 22.

 Area to be covered by quasi-municipal rights (114 households).

Scale: 1" = 400'

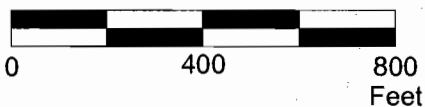

This map was prepared for the purpose of identifying the location of a water right only and is not intended to provide legal dimensions or location of property ownership lines.



## Map to Accompany a Water Right Transfer

Lakewood Utilities, Ltd./Lakewood Homeowners, Inc.

T.4S. R.1W. Sec. 22

Pacific Hydro-Geology Inc.

1/2004

T-9749