

T.3S. R.3W., W.M

RECEIVED

AUG 14 1998

WATER RESOURCES DEPT.
SALEM, OREGON

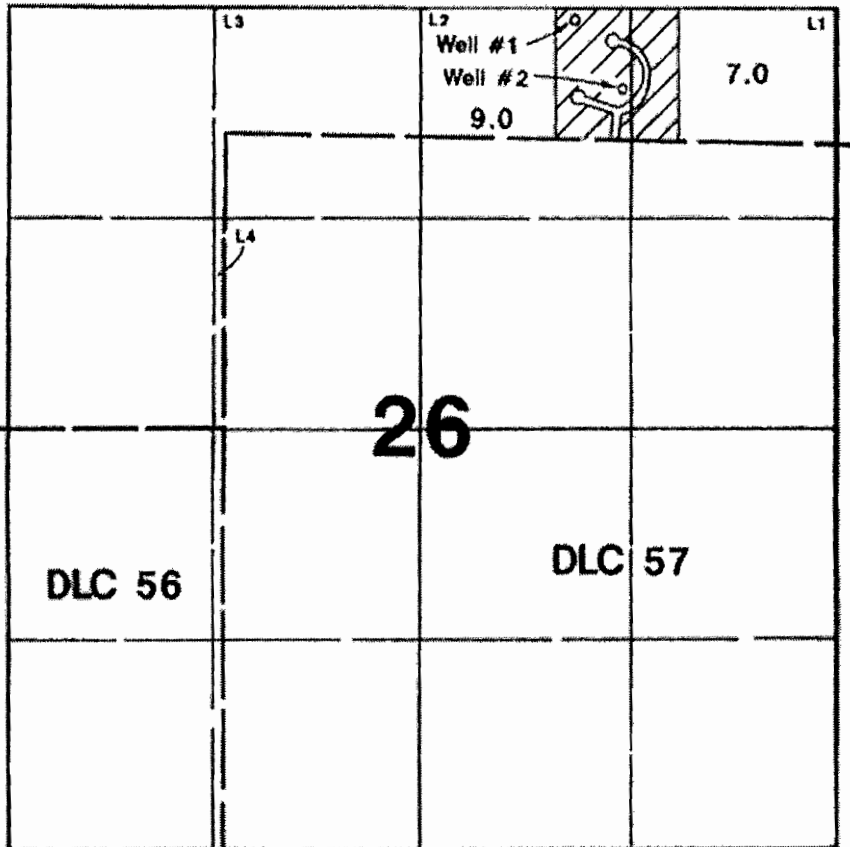

1" = 1320'



Area Irrigated

Well #1 is located 75'S & 1650'W from NE corner of Section 26.
Well #2 is located 500'S & 1350'W from NE corner of Section 26.

Application Map

Red Hills Estates

Application # G-14822

Permit #: G-13671

This Map Was Prepared For The Purpose Of Identifying The Location Of A Water Right Only And Is Not Intended To Provide Legal Dimensions Or Location Of Property Ownership Lines.

1-9738

Exhibit A

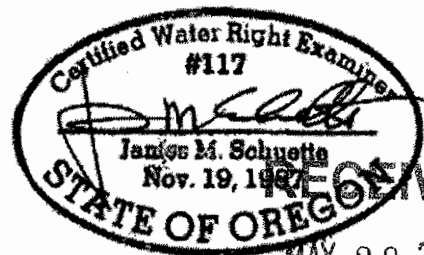

RECEIVED
MAY 28 2004

WATER RESOURCES DEPT.
SALEM, OREGON