

RECEIVED

MAY 30 2000

WATER RESOURCES DEPT.  
SALEM, OREGON

T13S R29E W.M.

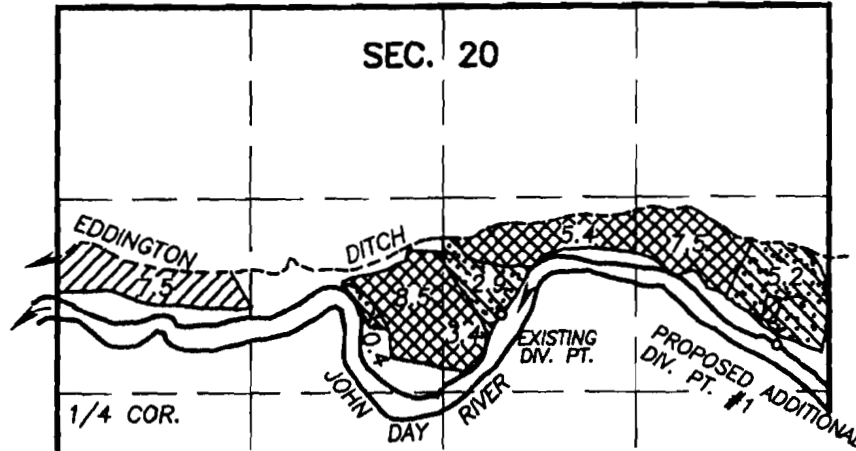

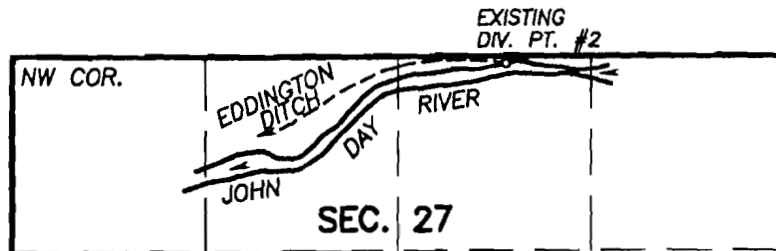

EXISTING DIV. PT. IS 2110' S. & 2240' W. OF THE NE COR. SEC. 20.  
 PROPOSED ADDITIONAL DIV. PT. #1 IS 2330' S. & 350' W. OF THE NE COR. SEC. 20.



PROPOSED ADDITIONAL DIV. PT. #2 IS 50' S. & 3380' E. OF THE NW COR. SEC. 27.



-  P-47460
-  C-39362
-  PLACE OF USE

APPLICATION MAP FOR  
 ADDITIONAL DIVERSION POINT TRANSFER  
 FOR  
 DAVID FAVRE  
 BY

 BAGETT-GRIFFITH & BLACKMAN  
 P.O. BOX 476  
 JOHN DAY, OR. 97845

FEBRUARY 23, 1999

T-8533

NOTE: THE PREPARATION OF THIS MAP WAS FOR THE PURPOSE OF IDENTIFYING THE LOCATION OF THE PROPOSED WATER RIGHT AND HAS NO INTENT TO PROVIDE DIMENSIONS OR LOCATION OF PROPERTY OWNERSHIP LINES.

