

# NE1/4 SECTION 4, T 15 S, R 16 E, W.M.

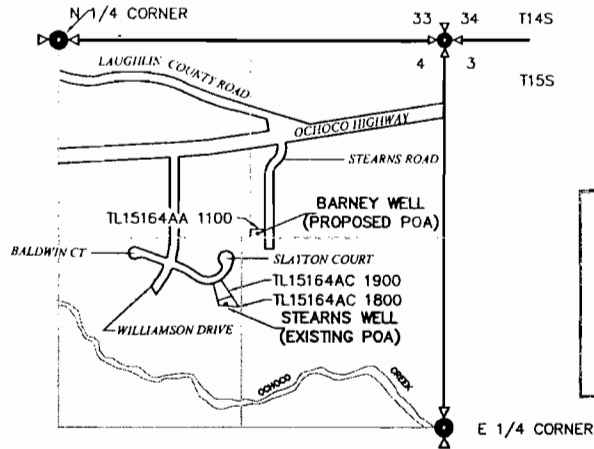

**RECEIVED**

JUL 21 2004

WATER RESOURCES DEPT  
SALEM, OREGON

PLACE OF USE IS WITHIN THE SERVICE AREA OF THE CITY OF PRINEVILLE. (SEE FIGURE 2).

STEARNS WELL #2 IS 1810.2' S AND 1151.5' E OF THE N 1/4 CORNER OF SEC. 4.

BARNEY WELL IS 1315' S AND 1370' E OF THE N 1/4 CORNER OF SEC. 4.

THE PURPOSE OF THIS MAP IS TO IDENTIFY THE LOCATION OF THE WATER RIGHT. IT IS NOT INTENDED TO PROVIDE INFORMATION RELATIVE TO THE LOCATION OF PROPERTY OWNERSHIP LINES.

### LEGEND

- WELL LOCATION
- CREEK
- SECTION CORNER AND SECTION LINE
- QUARTER CORNER AND 1/4 1/4 LINE
- TOWNSHIP/RANGE LINE
- PROPERTY LINE
- ROAD

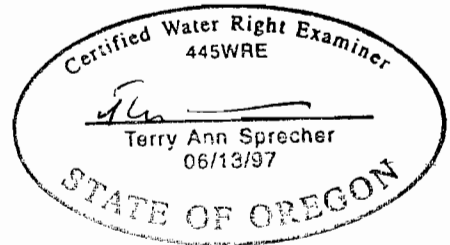

SCALE: 4"=1MILE

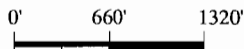

Prepared for: CITY OF PRINEVILLE

	Project #: 80102.000 TASK 4	<b>TRANSFER APPLICATION MAP</b> STEARNS WELL #2 AND BARNEY WELL CITY OF PRINEVILLE PRINEVILLE, OREGON	FIGURE <b>1</b>
	Date: JULY 2004		

*T-9762*