

T.6S., R.1W. & 2W., W.M.

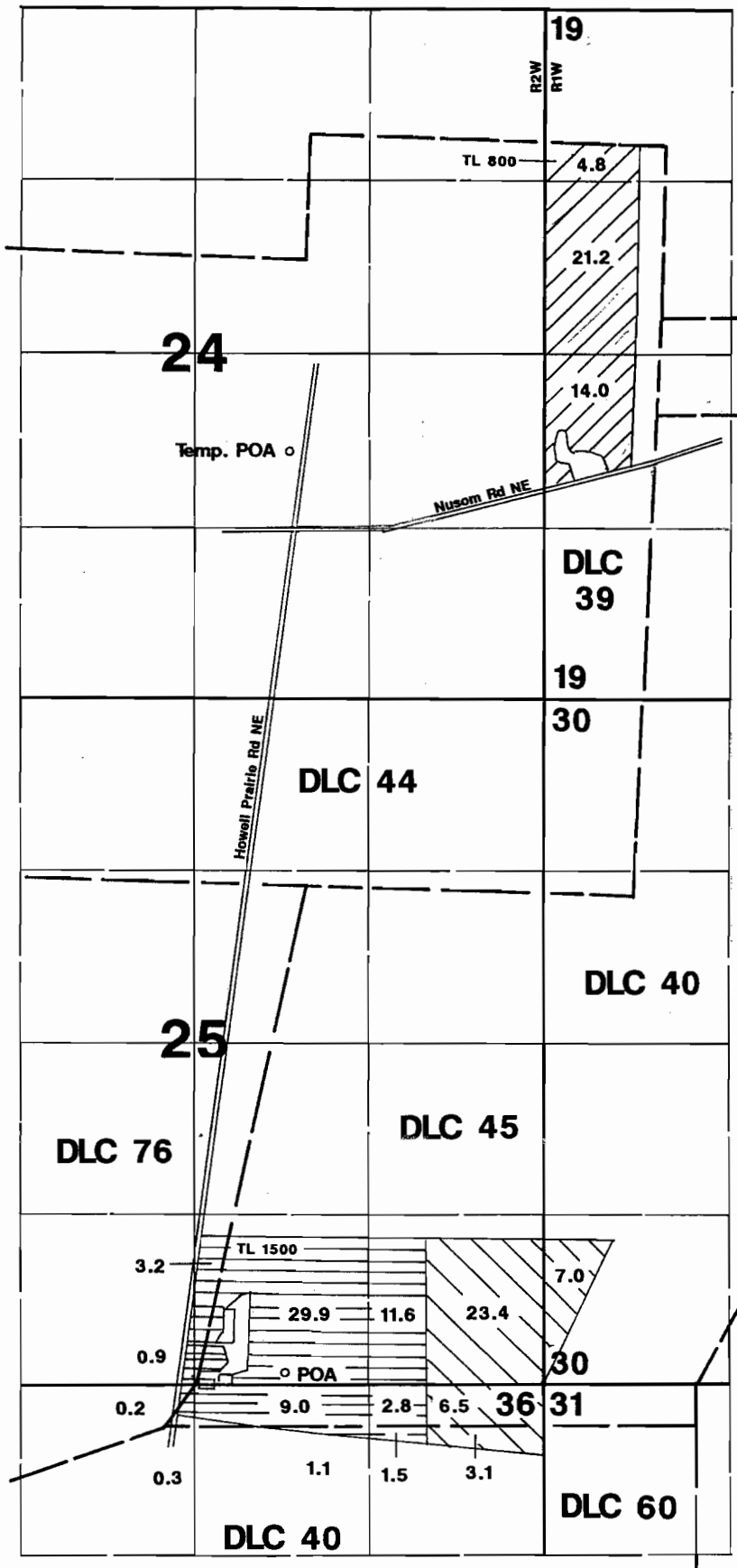

RECEIVED

JUN 21 2004

WATER RESOURCES DEPT
SALEM, OREGON

1" = 1320'

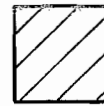

Temp. Area Transferred To

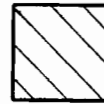

Area Transferred From



Remainder of Cert.. # 48177



Application Map

Carl Jensen

Transfer #: 9751

Cert. POA is located 70' N & 1960' W from the SE corner of Section 25.
Temp. POA is located 693' S & 1848' E from the E-1/4 corner of Section 24.

This Map Was Prepared For The Purpose Of Identifying The Location Of A Water Right Only And Is Not Intended To Provide Legal Dimensions Or Location Of Property Ownership Lines