

T 27 S, R 16 E, WM

T 27 S, R 17 E, WM

RECEIVED

APR 07 2005

"TO" Map Revised T-9823

LNH

Scale 1" = 100' WATER RESOURCES DEPT. SALM, OREGON

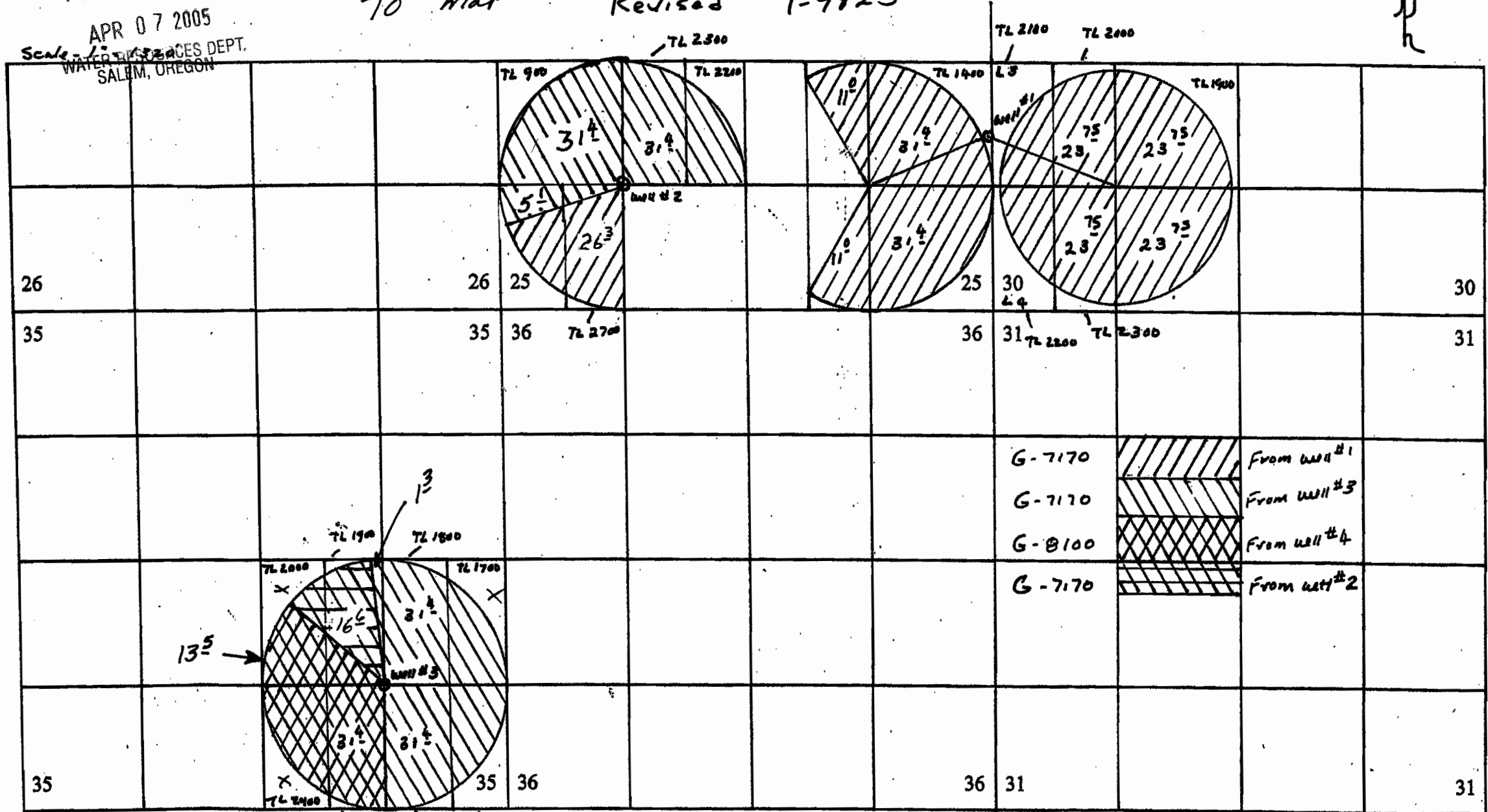

Well #1 to be located - 800' S & 10' W from the E $\frac{1}{4}$  Corner, Section 25, T27s, R16E, WM, Well #2 to be located - 1320' N & 1310' E from the SW Corner, Section 25, T27s, R16E, WM, Well #3 to be located - 1320' N & 1310' W from the SE Corner, Section 35, T27s, R16E, WM,

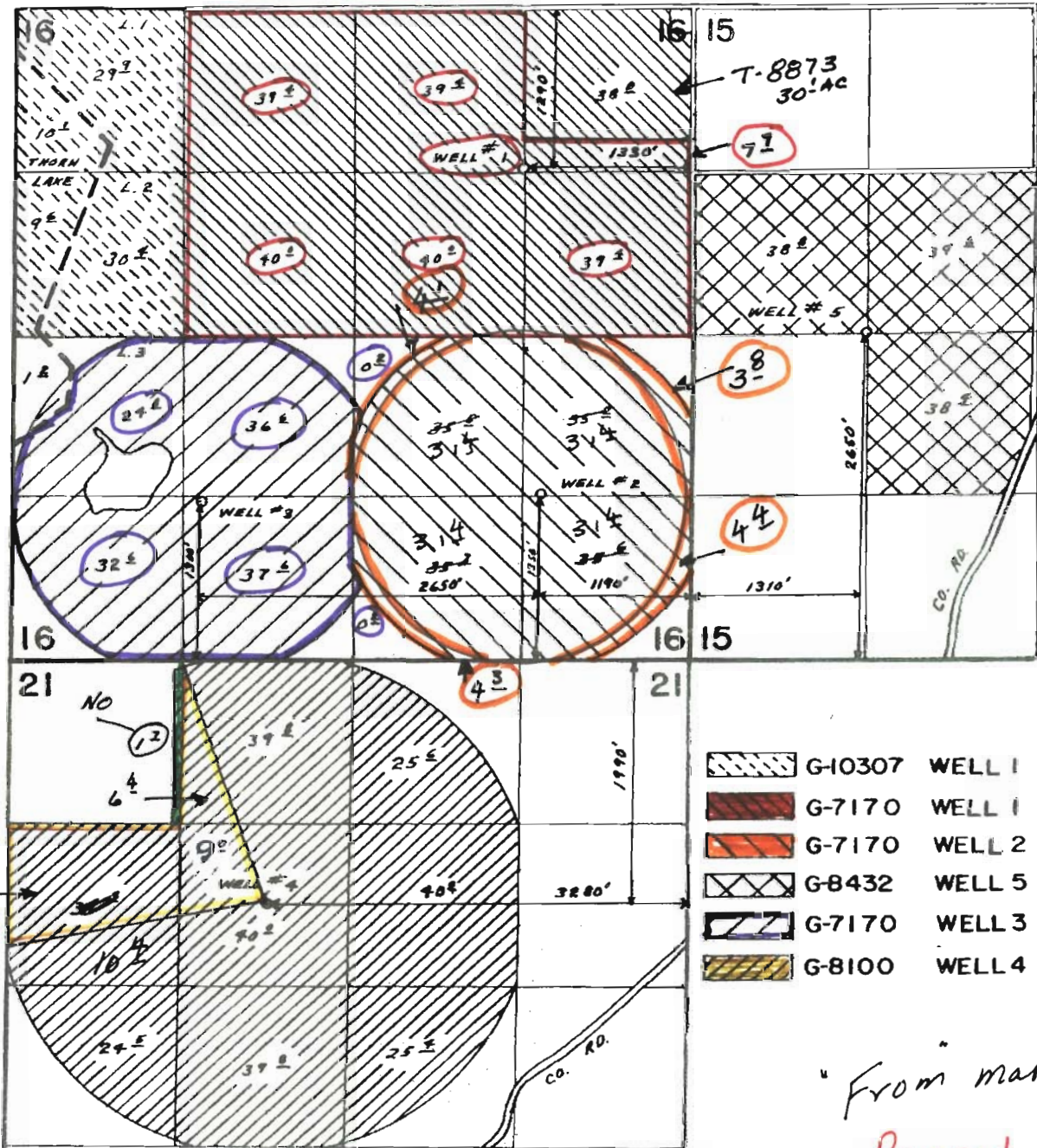

-  G-10307 WELL 1
-  G-7170 WELL 1
-  G-7170 WELL 2
-  G-8432 WELL 5
-  G-7170 WELL 3
-  G-8100 WELL 4

"From map"

Revised  
T-9823

SCALE: 1"=1320'

**FINAL PROOF SURVEY**

UNDER

G-11144                      G-10307  
 G-7720                      G-7170  
 G-9065                      G-8432  
 Application No. G-8731 Permit No. G-8100.....

IN NAME OF

**ZANE D. CHURCH**

Surveyed SEPT. 24, 1985, by L. OLSON.....  
 JUN. 27 1988                      B. BISHOP

RECEIVED

APR 07 2005

WATER RESOURCES DEPT.  
 SALEM, OREGON