

**2005 HWC, INC
1 YEAR TEMPORARY WATER RIGHT TRANSFER
FOR PERMIT G-4027 FROM BASALT WELLS
T4N, R 28E, W.M.**

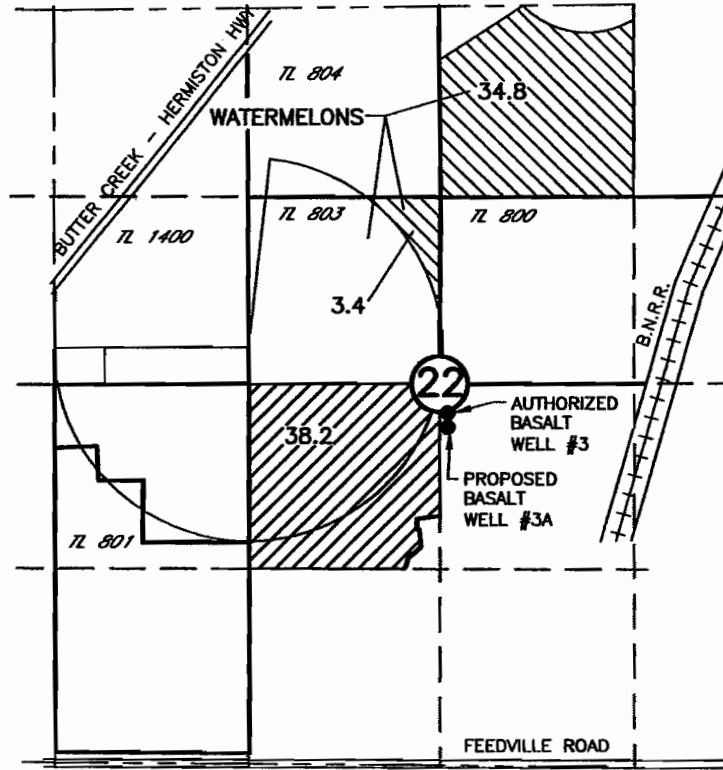

PROPOSED ADDITIONAL POINT OF APPROPRIATION

BASALT WELL #3A LOCATED 2360'N AND 2680'E
FROM THE SW CORNER SEC 22

AUTHORIZED POINT OF APPROPRIATION

BASALT WELL #3 LOCATED 2480'N AND 2680'E FROM
THE SW CORNER SEC 22

FROM



38.2ac PRIMARY PERMIT G-4027

TO



0 1320 2640



SCALE IN FEET

RECEIVED
JAN 27 2005
WATER RESOURCES DEPT
SALEM, OREGON

NOTE:
THE PURPOSE OF THIS MAP IS TO IDENTIFY THE APPROXIMATE LOCATION
OF THE WATER RIGHT. IT IS NOT INTENDED TO PROVIDE INFORMATION
RELATIVE TO THE LOCATION OF PROPERTY OWNERSHIP BOUNDARY LINES.

SCM Consultants, Inc.
A Tetra Tech Company

DRAWING: H:\CAD\AG\3522\156\3522156TT.dwg
PRINTED BY: RogerW on 01/13/05 02:34 PM

7-9857