



APPLICATION MAP

FOR WATER RIGHT TRANSFER 'OFF'

LOCATED IN THE NE 1/4 OF THE
SW 1/4 OF SEC. 17, T. 12 S., R. 13 E.,
W.M. JEFFERSON COUNTY, OREGON.

SCALE 1" = 400'

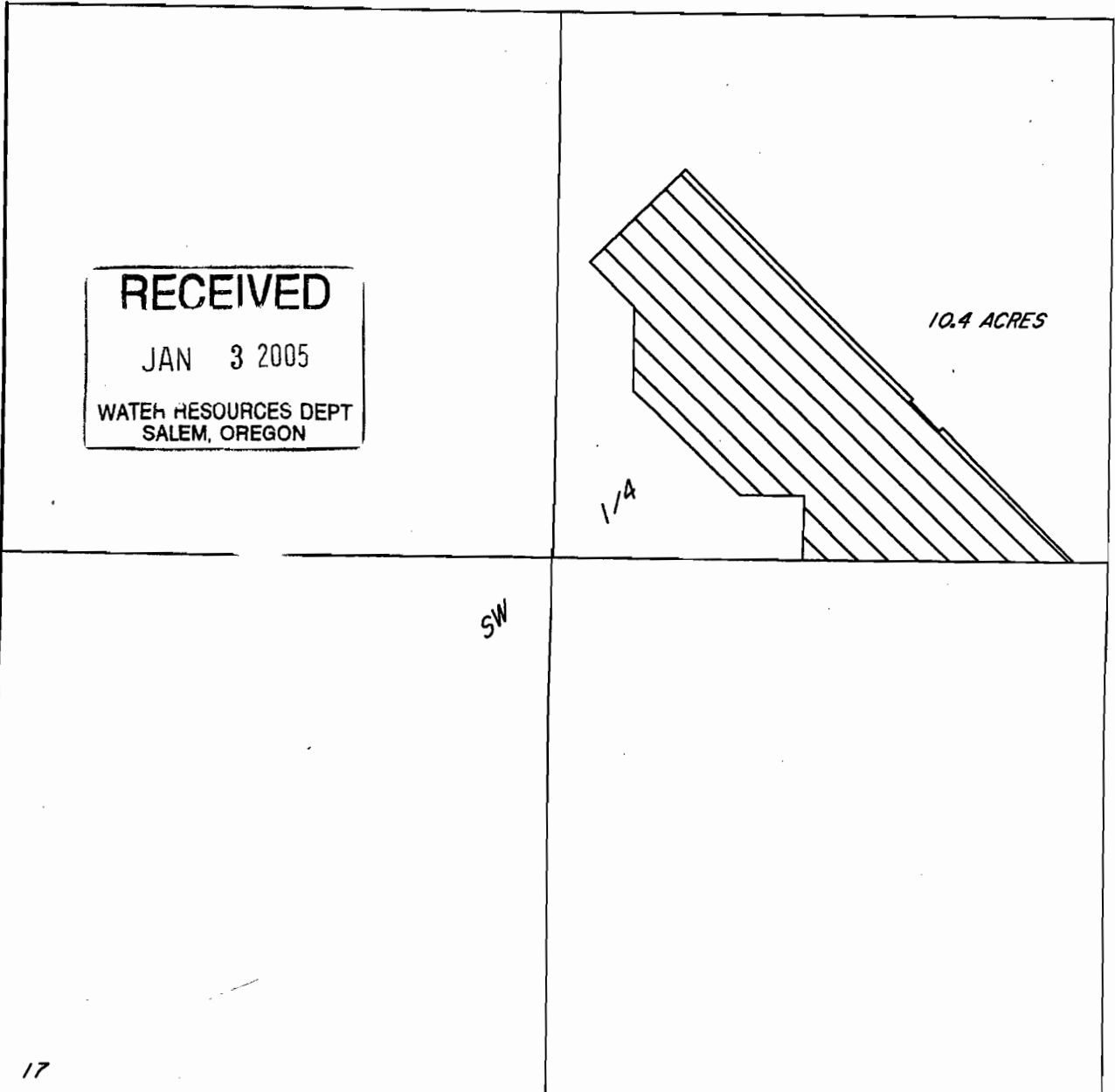

TOTAL TRANSFER 'OFF' THIS MAP = 10.4 ACRES OF 72279 AND 72281.

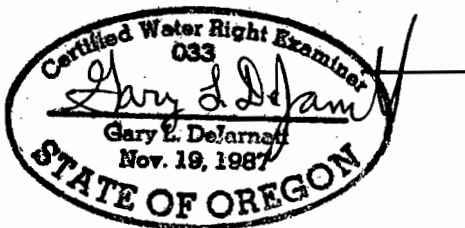

RENEWAL DATE: 12/31/05

NO REPRESENTATION IS INTENDED TO PROVIDE
DIMENSIONS OR LOCATION OF PROPERTY OWNERSHIP
LINES.

FOR: COLEMAN RANCH

PREPARED BY:
DEJARNATT LAND SURVEYS, INC.

63885 NORTH HWY 97
BEND, OREGON 97701
PHONE: 541-382-4192

DATE: APRIL 12, 2004
SHEET 1 OF 1
JOB # 04012D
LAYERS 1, 5, 8, 15



APPLICATION MAP

FOR WATER RIGHT TRANSFER 'ON'

LOCATED IN THE NW 1/4 OF THE NW 1/4 OF
SEC. 4, T. 12 S., R. 13 E., W.M., JEFFERSON
COUNTY, OREGON.

SCALE 1" = 400'

32 | 33
5 | 4



0.2 ACRES

1/4

RECEIVED
JAN 3 2005
WATER RESOURCES DIV.
SALEM, OREGON

NW

TOTAL TRANSFER 'ON' THIS MAP - 0.2 ACRES OF T2279 AND T2281.

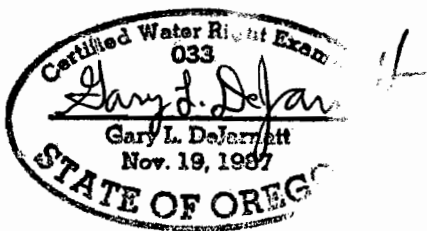

RENEWS: 12/31/05

FOR: COLEMAN RANCH

PREPARED BY:
DEJARNATT LAND SURVEYS, INC.

NO REPRESENTATION IS INTENDED TO
PROVIDE DIMENSIONS OR LOCATION OF
PROPERTY OWNERSHIP LINES.

63885 NORTH HWY 97 DATE: APRIL 12, 2004
BEND, OREGON 97701 SHEET 1 OF 1
PHONE: 541-382-4192 JOB # 04012B
LAYERS 1, 5, 8, 13.

APPLICATION MAP

FOR WATER RIGHT TRANSFER 'ON'
LOCATED IN THE SW 1/4 OF
SEC. 9, T.12 S., R.13 E., W.M.,
JEFFERSON COUNTY, OREGON



SCALE 1" = 400'

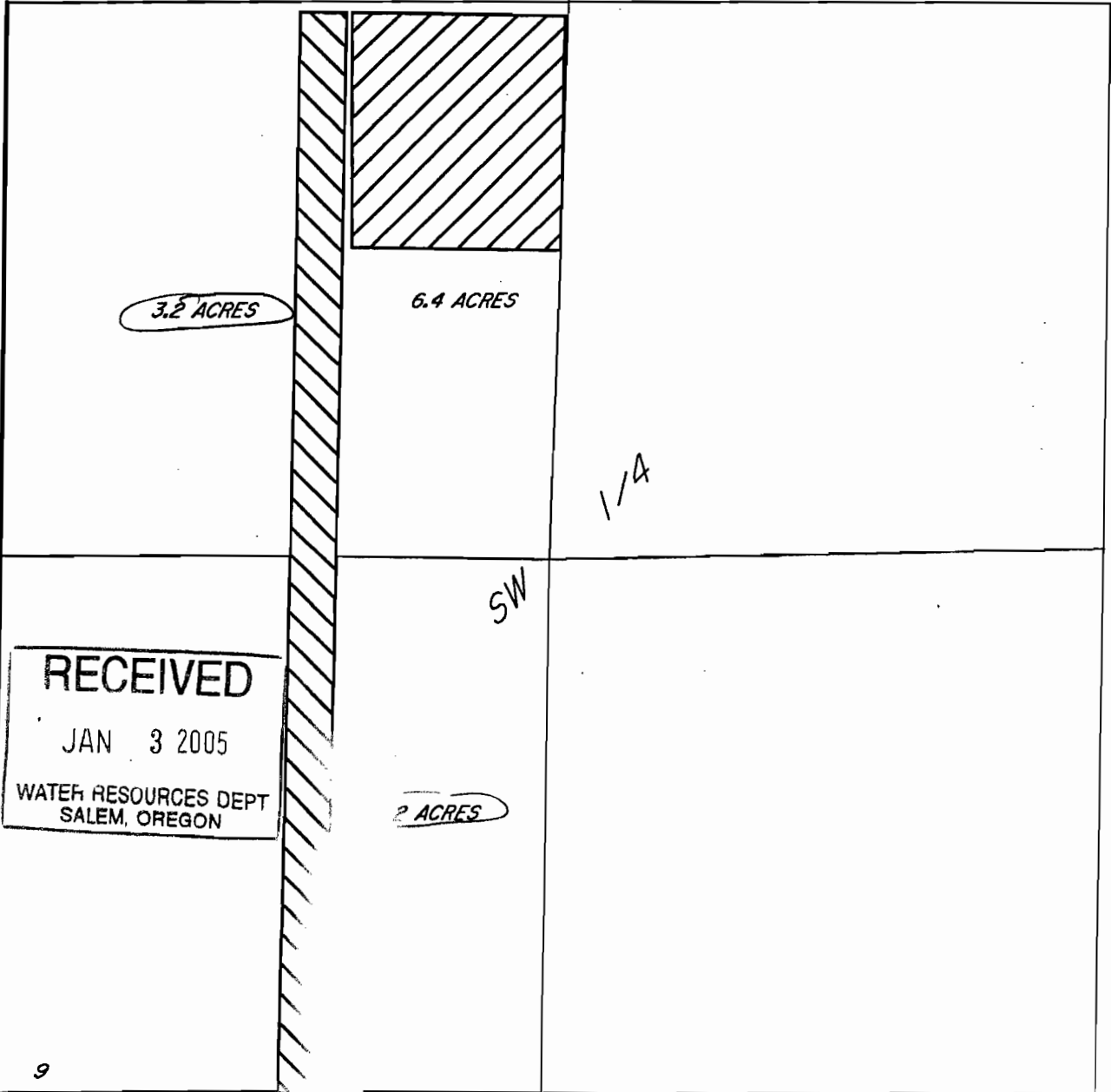

TOTAL ANSEER 'ON' THIS MAP = (3.2 + 3.2) = 6.4 ACRES OF 72283.
 TOTAL ANSEER 'ON' THIS MAP = 6.4 ACRES OF 72279 AND 72281.

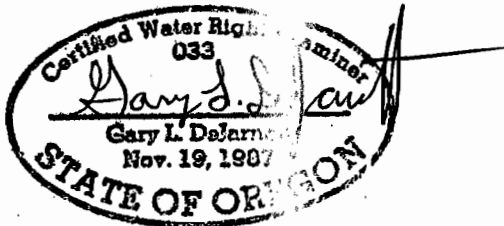

RENEWAL DATE: 12/31/05

FOR: COLEMAN RANCH

PREPARED BY:
DE JARNATT LAND SURVEYS, INC.

NO REPRESENTATION IS INTENDED
 TO PROVIDE DIMENSIONS OR
 LOCATION OF PROPERTY
 OWNERSHIP LINES.

63885 NORTH HWY 97 DATE: APRIL 12, 2004
 BEND, OREGON 97701 SHEET 1 OF 1
 PHONE: 541-382-4192 JOB # 04012A
 LAYERS: 1, 9, 10, 13, 14

APPLICATION MAP
FOR WATER RIGHTS TRANSFER 'ON'
LOCATED IN THE NW 1/4 OF
SEC. 21, T. 12 S., R. 13 E.,
W.M., JEFFERSON COUNTY,
OREGON.



SCALE 1" = 400'

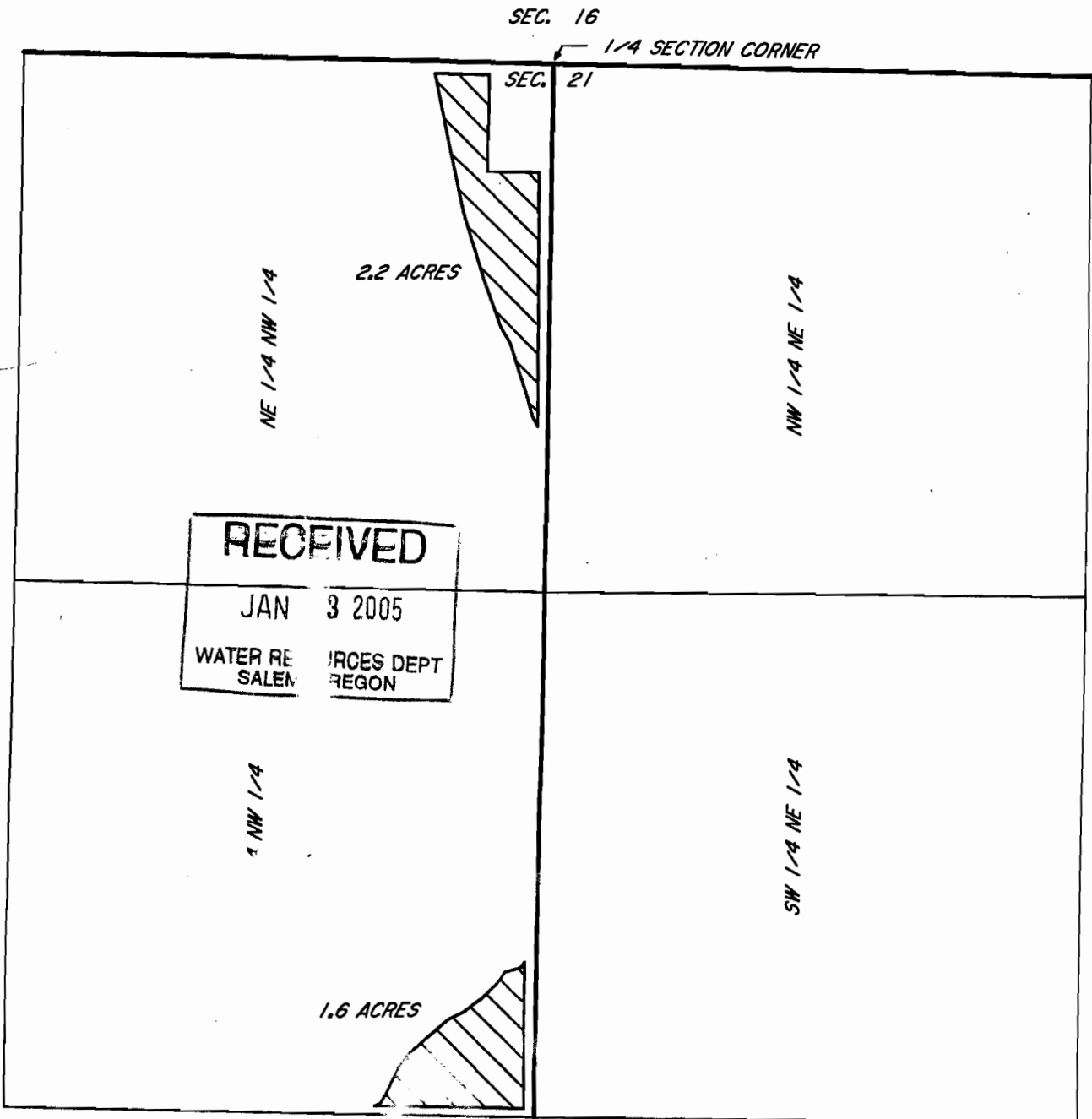

TOTAL TRANSFER 'ON' IS MAP = (2.2 + 1.6) = 3.8 ACRES OF 72279 AND 72281.

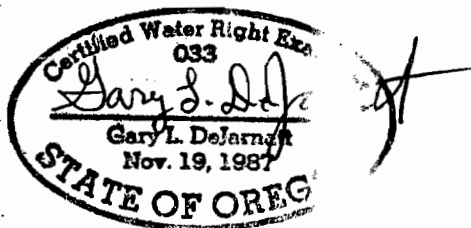

RENEWS: 12/31/05

NO REPRESENTATION IS INTENDED TO PROVIDE
DIMENSIONS OR LOCATION OF PROPERTY
OWNERSHIP LINES.

FOR: COLEMAN RANCH

PREPARED BY:
DEJARNATT LAND SURVEYS, INC.

63885 NORTH HWY 97
BEND, OREGON 97701
PHONE: 541-382-4192

DATE: APRIL 12, 2004
SHEET 1 OF 1
JOB # 04012C
LAYERS 1,5,13,15

APPLICATION MAP

FOR WATER RIGHT TRANSFER 'OFF'
LOCATED IN THE SW 1/4 OF
SEC. 9, T.12 S., R.13 E., W.M.,
JEFFERSON COUNTY, OREGON



SCALE 1" = 400'

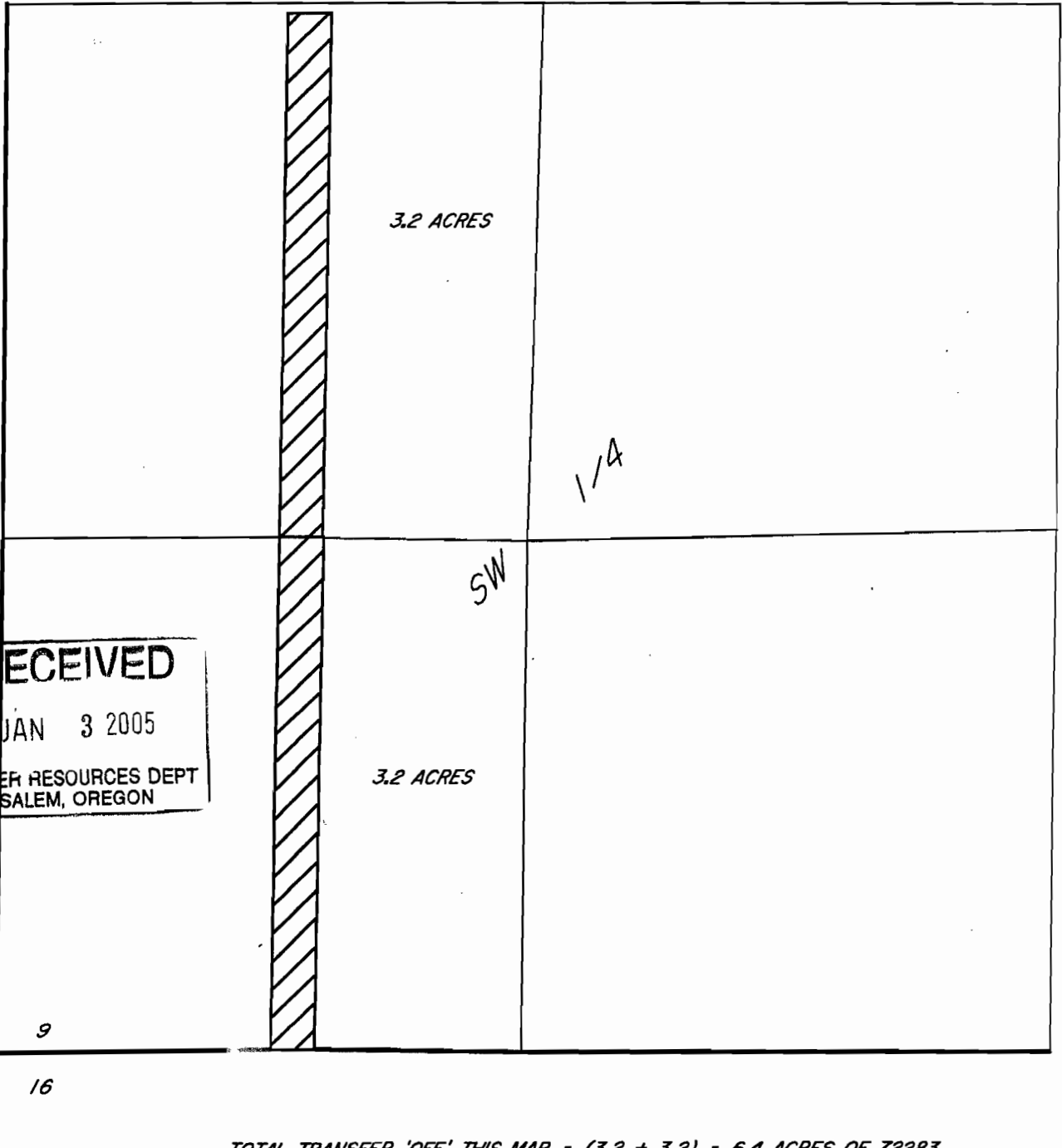

RECEIVED
 JAN 3 2005
 WATER RESOURCES DEPT
 SALEM, OREGON

TOTAL TRANSFER 'OFF' THIS MAP = (3.2 + 3.2) = 6.4 ACRES OF 72283.

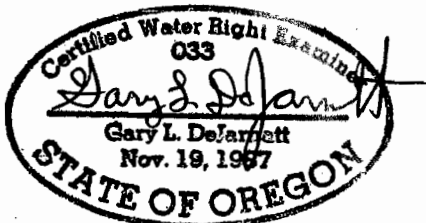

RENEWAL DATE: 12/31/05

FOR: COLEMAN RANCH

PREPARED BY:
DEJARNATT LAND SURVEYS, INC.

63885 NORTH HWY 97 DATE: APRIL 12, 2004
 BEND, OREGON 97701 SHEET 1 OF 1
 PHONE: 541-382-4192 JOB # 04012A
 LAYER 1, 11, 12.

NO REPRESENTATION IS INTENDED
TO PROVIDE DIMENSIONS OR
LOCATION OF PROPERTY
OWNERSHIP LINES.

APPLICATION MAP

FOR WATER RIGHT TRANSFER 'ON'
LOCATED IN THE SW 1/4 OF
SEC. 9, T.12 S., R.13 E., W.M.,
JEFFERSON COUNTY, OREGON



SCALE 1" = 400'

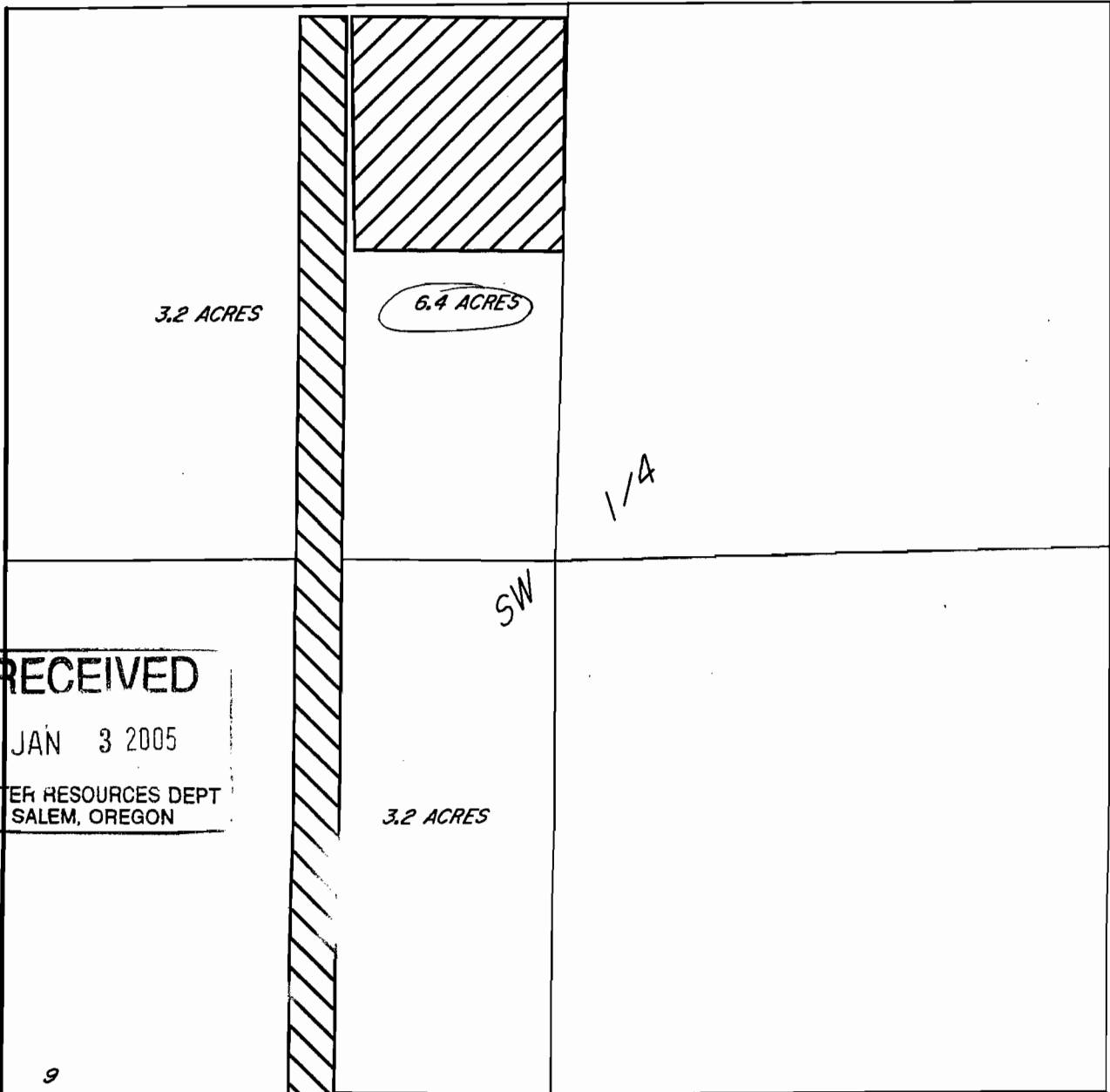

RECEIVED
 JAN 3 2005
 WATER RESOURCES DEPT
 SALEM, OREGON

8 9
 17 16

TOTAL TRANSFER 'ON' THIS MAP = (3.2 + 3.2) = 6.4 ACRES OF 72283.
TOTAL TRANSFER 'ON' THIS MAP = 6.4 ACRES OF 72279 AND 72281.

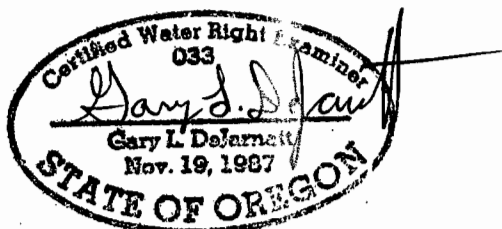

RENEWAL DATE: 12/31/05

FOR: COLEMAN RANCH

PREPARED BY:
DEJARNATT LAND SURVEYS, INC.
 63885 NORTH HWY 97 DATE: APRIL 12, 2004
 BEND, OREGON 97701 SHEET 1 OF 1
 PHONE: 541-382-4192 JOB # 04012A
 LAYERS: 1, 9, 10, 13, 14

NO REPRESENTATION IS INTENDED
 TO PROVIDE DIMENSIONS OR
 LOCATION OF PROPERTY
 OWNERSHIP LINES.

APPLICATION MAP

FOR WATER RIGHT TRANSFER 'OUT'

LOCATED IN THE N 1/2 OF THE SW 1/4
OF SEC. 15, T. 11S., R. 13E., W.M.,
JEFFERSON COUNTY, OREGON.



SCALE 1" = 400'

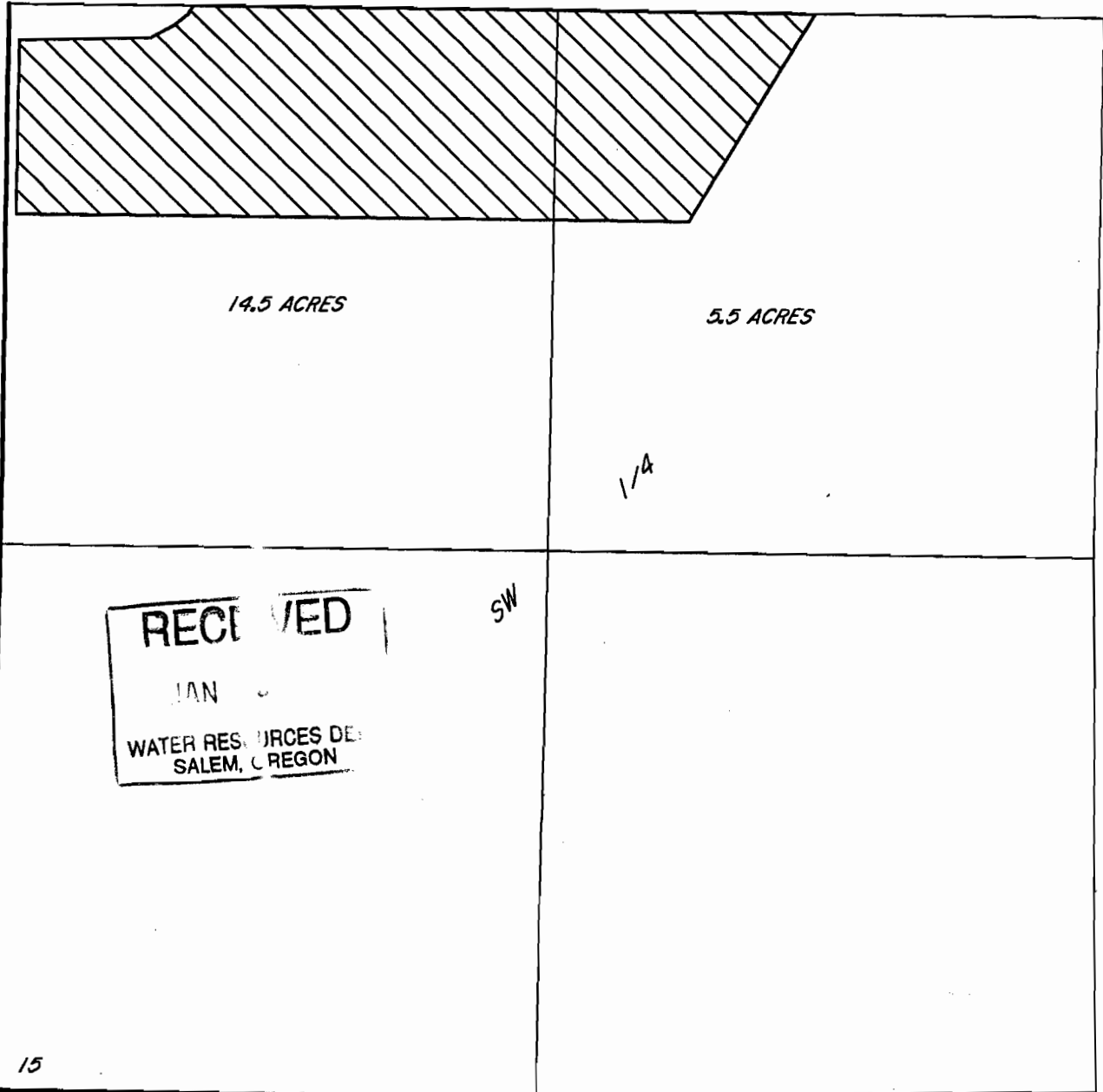

TOTAL TRANSFER 'OUT' THIS MAP = 14.5 + 5.5 = 20.0 ACRES OF 72279 AND 72281.

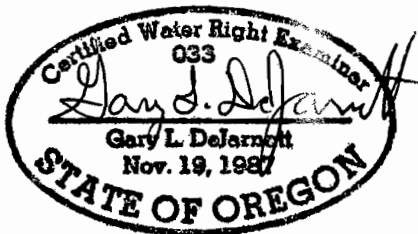

RENEWS: 12/31/05

NO REPRESENTATION IS INTENDED TO
PROVIDE DIMENSIONS OR LOCATION OF
PROPERTY OWNERSHIP LINES.

FOR: WILLIAM WISE

PREPARED BY:
DEJARNATT LAND SURVEYS, INC.

63885 NORTH HWY 97
BEND, OREGON 97701
PHONE: 541-382-4192

DATE: APRIL 14, 2004
SHEET 1 OF 1
JOB # 04015A
LAYER 1,5,7,15

APPLICATION MAP

FOR WATER RIGHT TRANSFER 'ON'
LOCATED IN THE E 1/2 OF THE NW 1/4
OF SEC. 15, T. 11S., R. 13E., W.M.,
JEFFERSON COUNTY, OREGON.



SCALE 1" = 400'

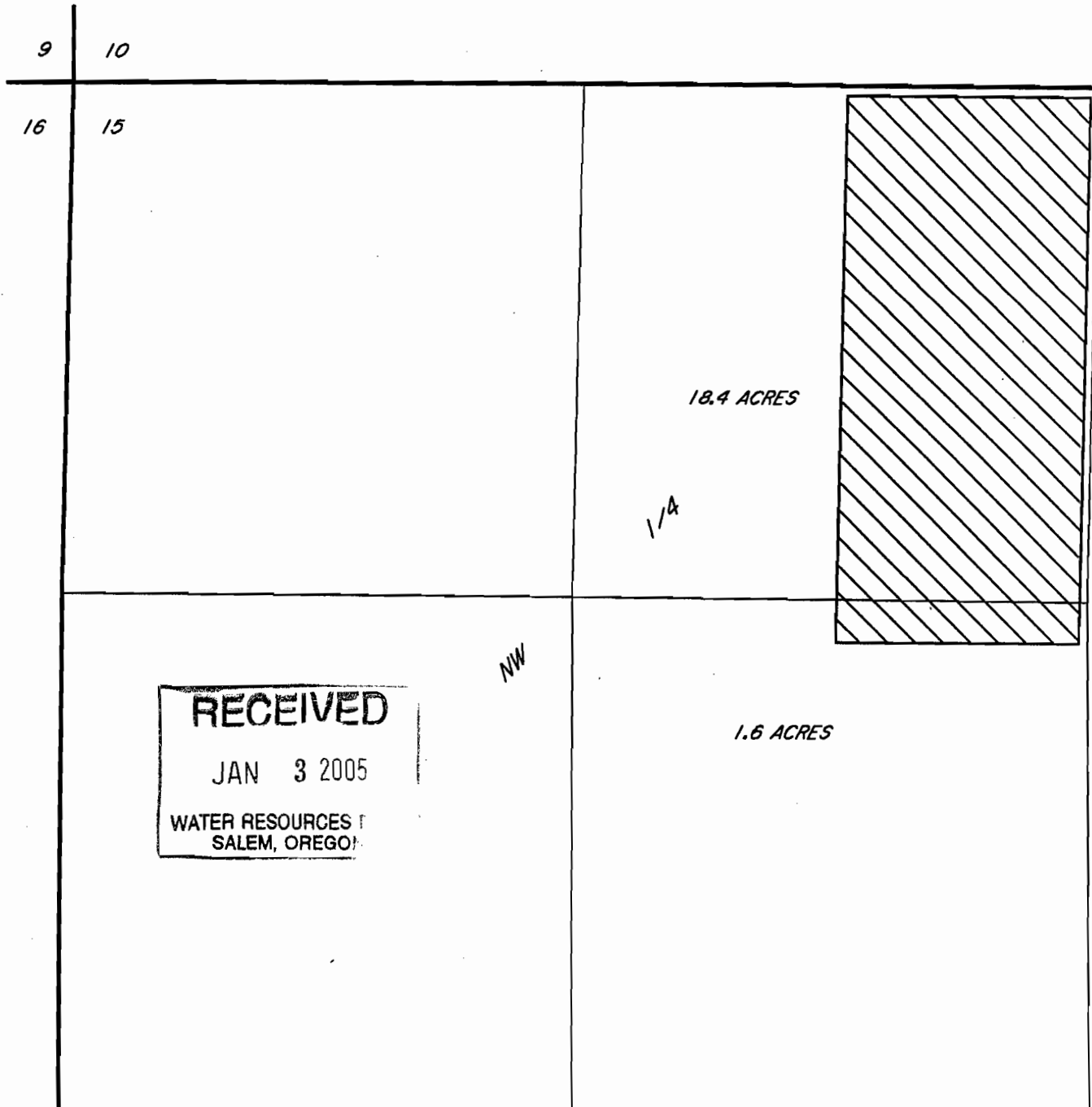

TOTAL TRANSFER 'ON' THIS MAP = 18.4 + 1.6 = 20.0 ACRES 72279 AND 72281.



RENEWS: 12/31/05

FOR: WILLIAM WISE

NO REPRESENTATION IS INTENDED TO
PROVIDE DIMENSIONS OR LOCATION
OF PROPERTY OWNERSHIP LINES.

PREPARED BY:
DEJARNATT LAND SURVEYS, INC.

63885 NORTH HWY 97
BEND, OREGON 97701
PHONE: 541-382-4192

DATE: APRIL 14, 2004
SHEET 1 OF 1
JOB # 04015B
LAYER 1, 6, 8, 15.

APPLICATION MAP

FOR WATER RIGHT TRANSFER 'OUT'
LOCATED IN THE E 1/2 OF THE NW 1/4
OF SEC. 15, T. 11S., R. 13E., W.M.,
JEFFERSON COUNTY, OREGON.



SCALE 1" = 400'

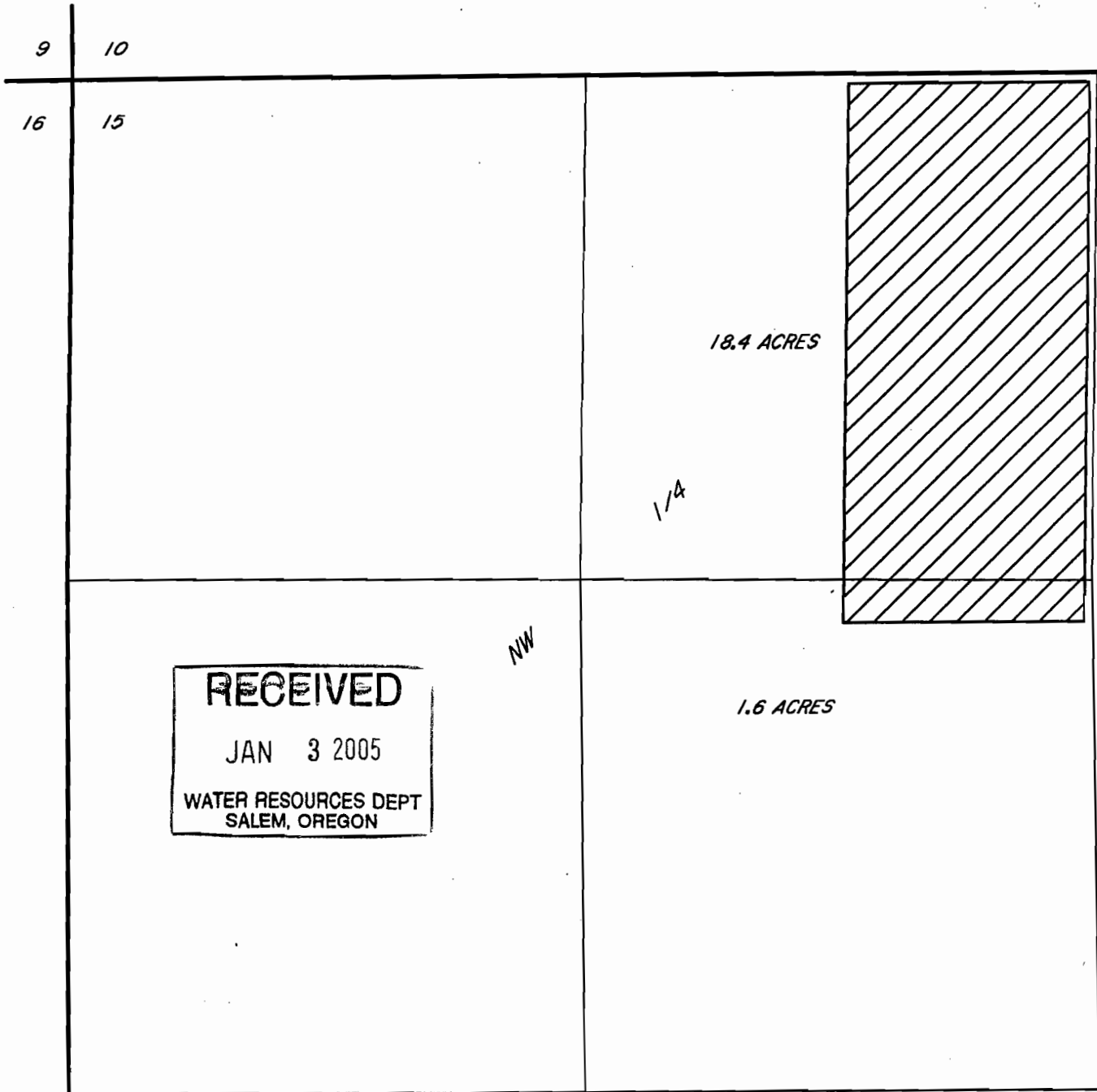

TOTAL TRANSFER 'OUT' THIS MAP = 18.4 + 1.6 = 20.0 ACRES OF 72283.

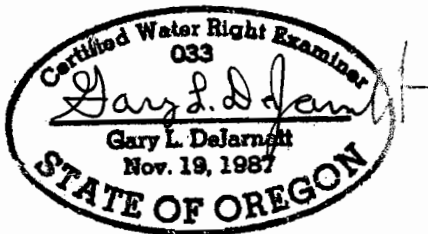

RENEWS: 12/31/05

FOR: WILLIAM WISE

NO REPRESENTATION IS INTENDED TO
PROVIDE DIMENSIONS OR LOCATION
OF PROPERTY OWNERSHIP LINES.

PREPARED BY:
DEJARNATT LAND SURVEYS, INC.

63885 NORTH HWY 97
BEND, OREGON 97701
PHONE: 541-382-4192

DATE: APRIL 14, 2004
SHEET 1 OF 1
JOB # 040158
LAYER 1, 6, 8, 12.

APPLICATION MAP

FOR WATER RIGHT TRANSFER 'ON'

LOCATED IN THE N 1/2 OF THE SW 1/4
OF SEC. 15, T. 11S., R. 13E., W.M.,
JEFFERSON COUNTY, OREGON.



SCALE 1" = 400'

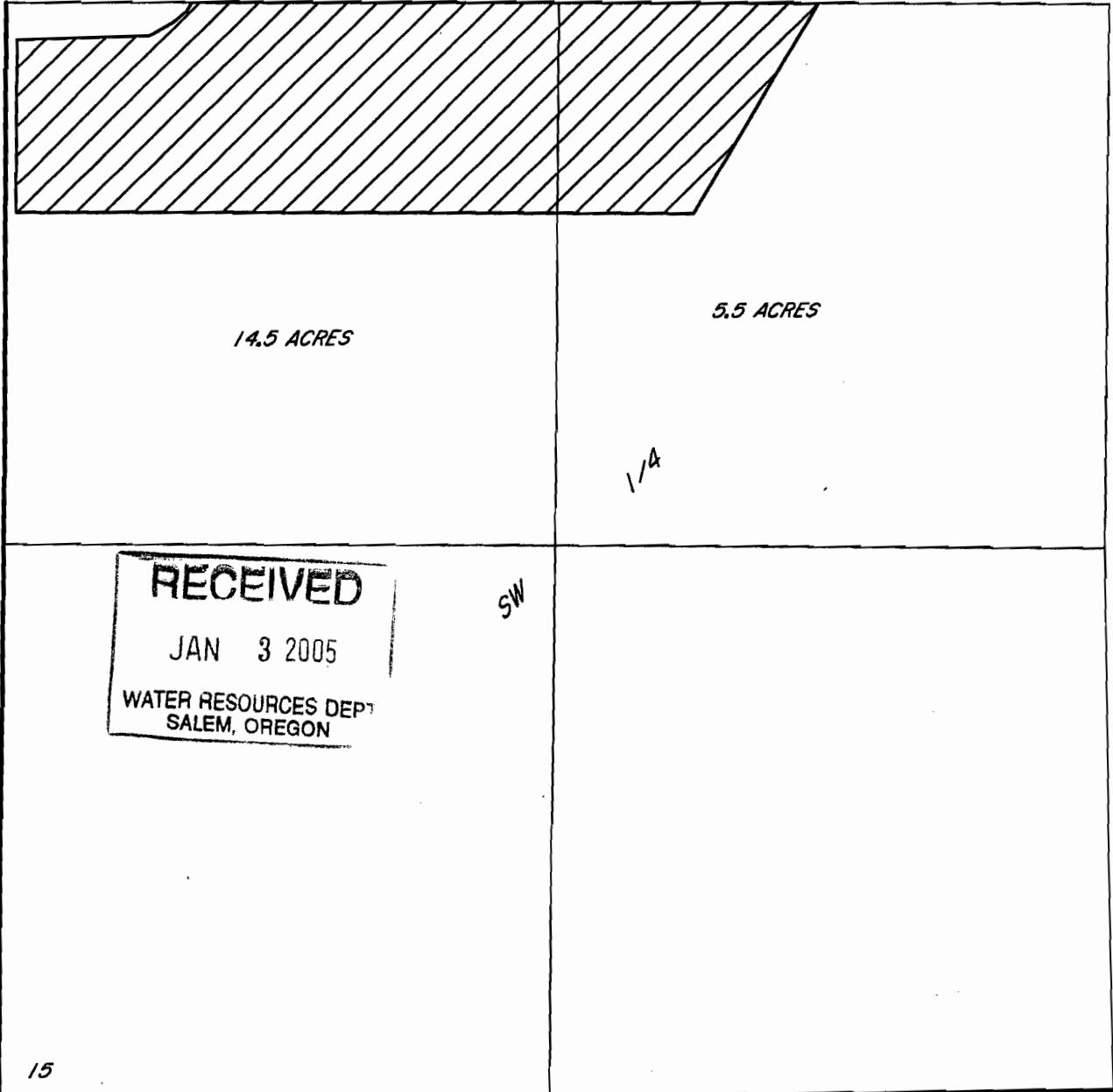

TOTAL TRANSFER 'ON' THIS MAP = 14.5 + 5.5 = 20.0 ACRES OF 72283.



RENEWS: 12/31/05

NO REPRESENTATION IS INTENDED TO
PROVIDE DIMENSIONS OR LOCATION OF
PROPERTY OWNERSHIP LINES.

FOR: WILLIAM WISE

PREPARED BY:

DEJARNATT LAND SURVEYS, INC.

63885 NORTH HWY 97
BEND, OREGON 97701
PHONE: 541-382-4192

DATE: APRIL 14, 2004
SHEET 1 OF 1
JOB # 04015A
LAYERS 1, 5, 8, 15.



SCALE 1" = 400'

APPLICATION MAP
FOR WATER RIGHT TRANSFER 'ON'
LOCATED IN THE N 1/2 OF
THE SW 1/4 OF SEC. 35,
T. 10 S., R. 13 E., W.M.,
JEFFERSON COUNTY, OREGON.

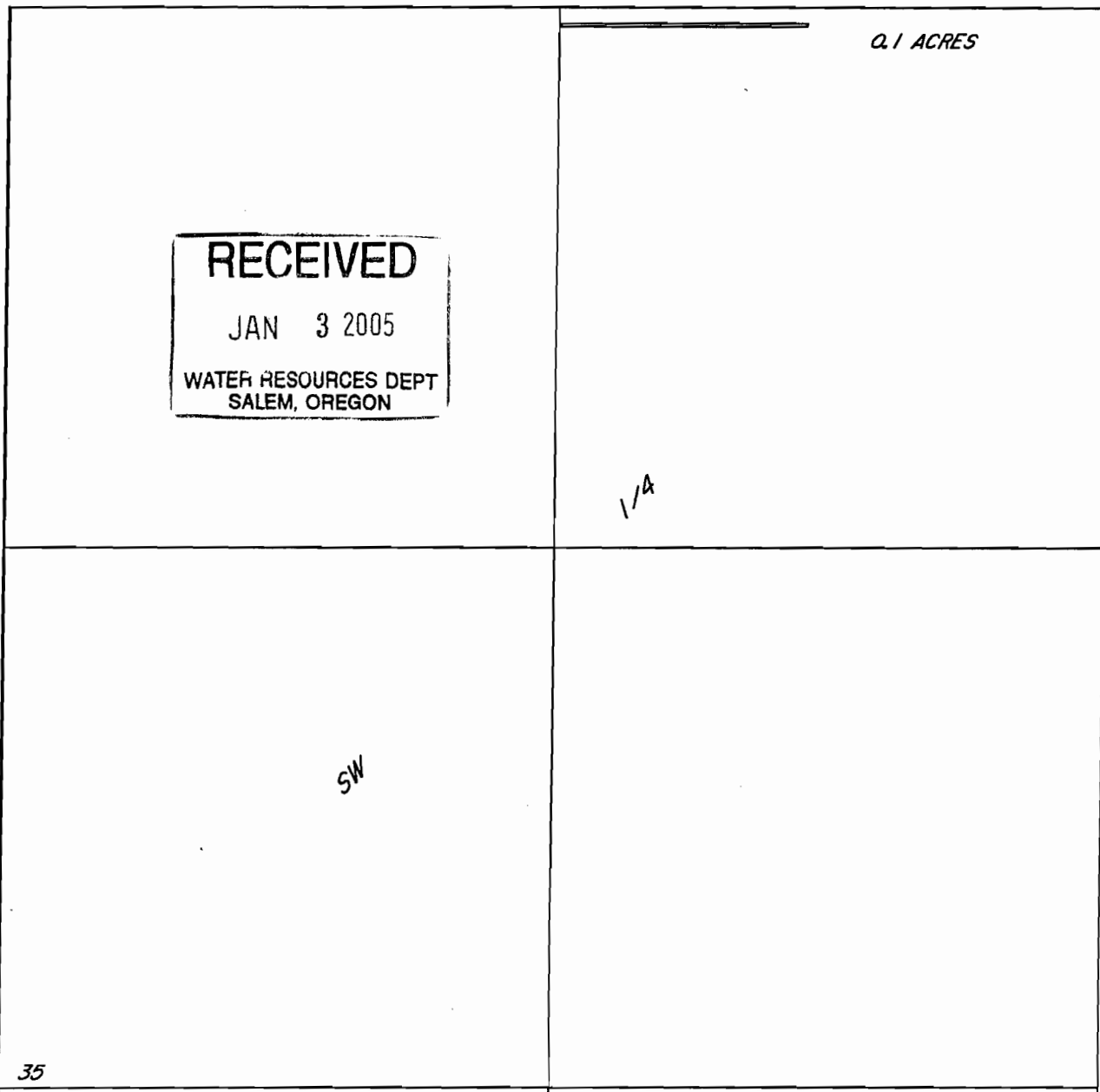

RECEIVED
JAN 3 2005
WATER RESOURCES DEPT
SALEM, OREGON

TOTAL 'ON' THIS MAP = 0.1 ACRES C-72279, 72281.

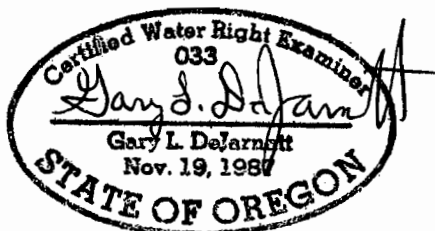

Renewal Date:
12-31-03

NO REPRESENTATION IS INTENDED TO
PROVIDE DIMENSIONS OR LOCATION
OF PROPERTY OWNERSHIP LINES.

FOR: CITY OF MADRAS

PREPARED BY:
DEJARNATT LAND SURVEYS, INC.

63885 NORTH HWY 97
BEND, OREGON 97701
PHONE: 541-382-4192

DATE: OCTOBER 6, 2003
SHEET 1 OF 1 'ON'
JOB # 03060
LAYER 1, 33

APPLICATION MAP

FOR WATER RIGHT TRANSFER 'ON'
LOCATED IN THE SW 1/4 OF THE NW 1/4,
SEC. 23, T.12S, R.13E., W.M.,
JEFFERSON COUNTY, OREGON.



SCALE 1" = 400'

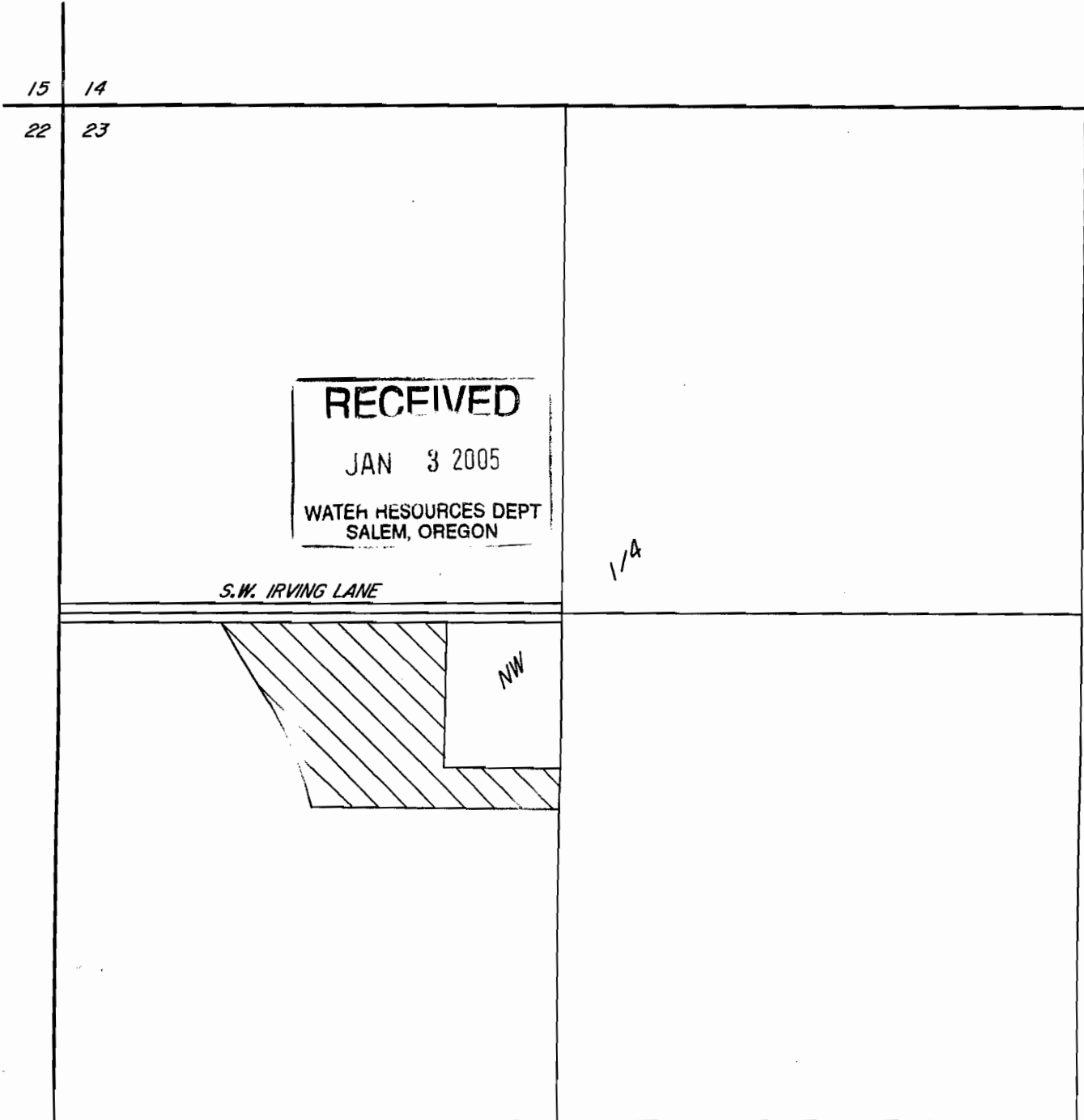

TOTAL TRANSFER 'ON' THIS MAP = 5.6 ACRES OF 72279 AND 72281.

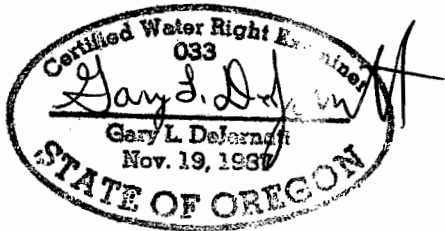

RENEWAL DATE:
12/31/05

FOR: DANIEL ZOOK

PREPARED BY:
DEJARNATT LAND SURVEYS, INC.

63885 NORTH HWY 97
BEND, OREGON 97701
PHONE: 541-382-4192

DATE: NOVEMBER 1, 2004
SHEET 1 OF 1
JOB # 04058
LAYERS 1, 7

NO REPRESENTATION IS INTENDED TO PROVIDE
DIMENSIONS OR LOCATION OF PROPERTY OWNERSHIP LINES.